

SPEAR FARM ESTUARY PRESERVE TRAIL IMPROVEMENT PROJECT TOWN OF YARMOUTH, YARMOUTH COMMUNITY SERVICES MAY OF 2023

DRAWING INDEX

--COVER SHEET

FIGURE 1: LOCATION MAP

FIGURE 2: SITE PLAN

FIGURE 3: BOARDWALK WETLAND CROSSING TYPICAL

FIGURE 4: CROSSING DESIGN FOR WC-3

FIGURE 5: CROSSING DESIGN FOR WC-8

FIGURE 6: FLOOD HAZARD MAP

FIGURE 1: Location Map: Spear Farm Estuary Preserve Trail Improvement Project

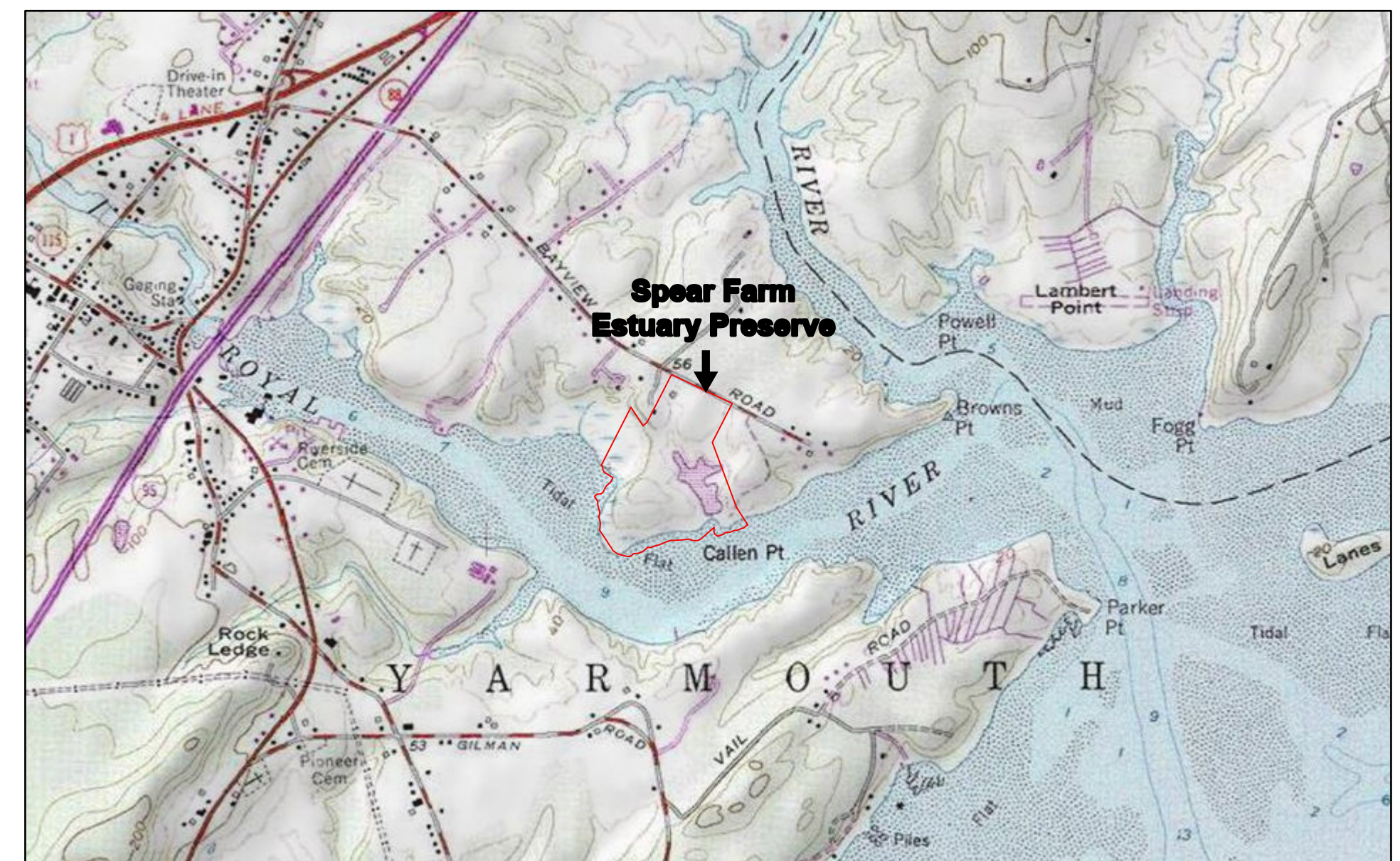

2/9/2023

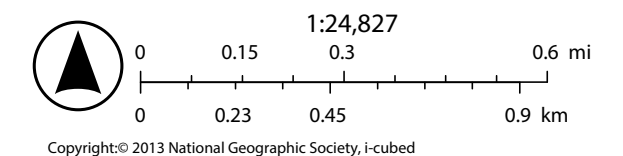

Plans Prepared by:
Erik Donohoe
Parks Specialist, Yarmouth Community Services
Town of Yarmouth



Town of Yarmouth
200 Main Street
Yarmouth, ME 04096

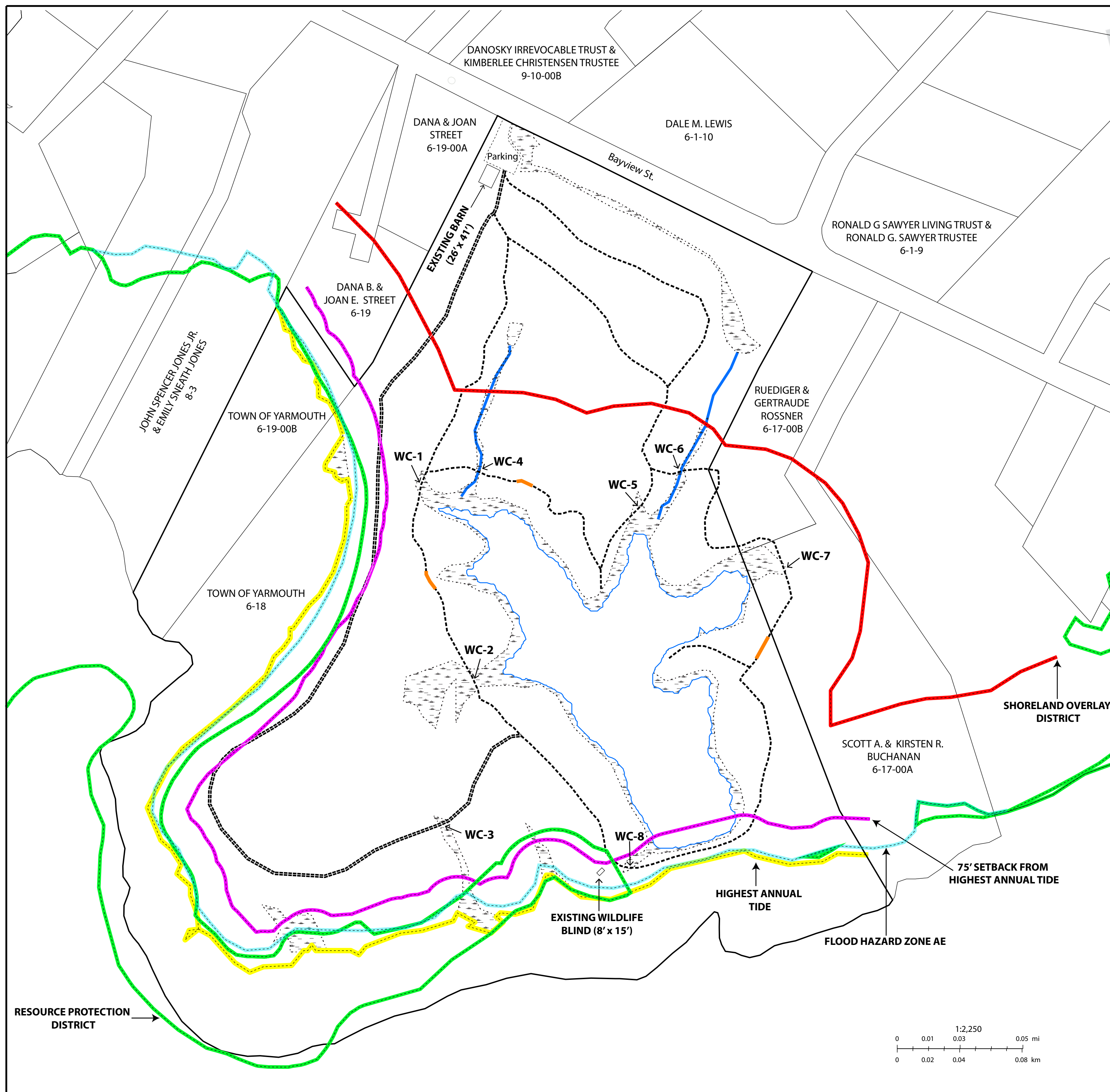

FIGURE 2:
Site Plan
Spear Farm Boardwalk Project

- Trails
- Maintenance/Emergency Access Trail
- Wetland
- Stream
- Shoreland Overlay District
- Resource Protection District
- Highest Annual Tide
- 75' Highest Annual Tide Buffer
- Flood Hazard Zone AE
- Replace Upland Bog Bridging with Gravel

Notes:

1. WC-# equals resource crossing see attached figures for corresponding resource crossing designs.
2. All proposed improvements and resource crossing locations are on existing established trails. Proposed improvements to WC-1, 2, 4, and 5 are 4-foot-wide pipe support boardwalks (Figure 3). WC-3 and WC-8 are located on the maintenance/emergency access route and proposed for upgrade to gravel hardened trail (Figure 4) and raised 7-foot-wide bridge (Figure 5) respectively.
3. Zoning: Low Density Residential, Resource Protection District, and Shoreland Overlay District
4. Waivers Requested: No waivers requested. The trail and associated structures are considered a Functionally Water Dependent Use as the primary purpose of the trails is to provide public access, visually and directly, to the Royal River Estuary and impounded freshwater pond.

Spear Farm Boardwalk Project
Map-Lot: 6-18

Plan Prepared by:
Erik Donohoe
Parks Specialist, Yarmouth Community Services
for the Town of Yarmouth
3/28/2023



Town of Yarmouth
200 Main Street
Yarmouth, ME 04096

PROFILE VIEW ILLUSTRATING BOARDWALK AND APPROACH

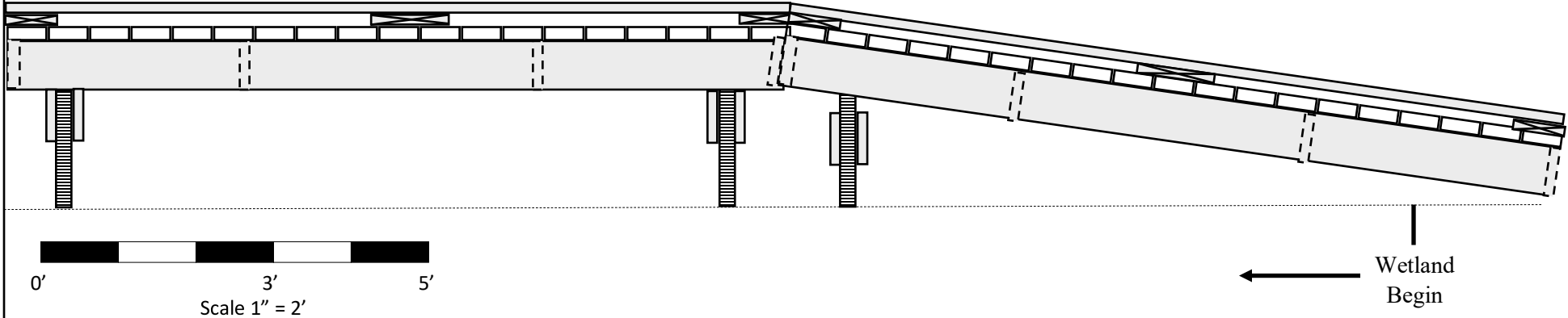

PLAN VIEW OF BOARDWALK

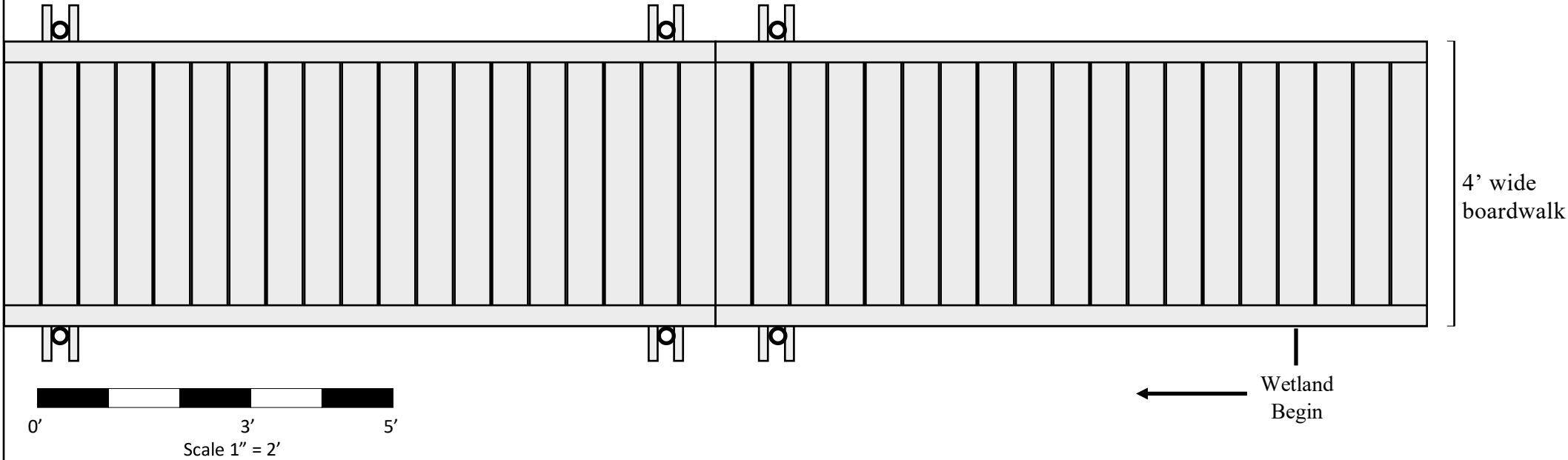

CROSS SECTION VIEW OF BOARDWALK

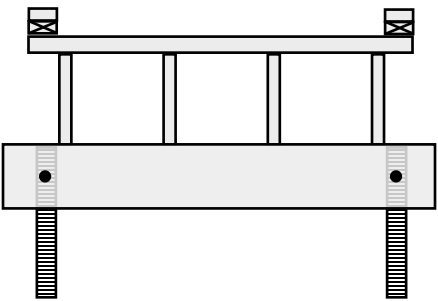

FIGURE 3:
BOARDWALK WETLAND CROSSING TYPICAL
FOR WETLAND CROSSING #'s 1, 2, 4, and 5
Spear Farm Boardwalk Project



Photo 1: Typical Boardwalk Structure

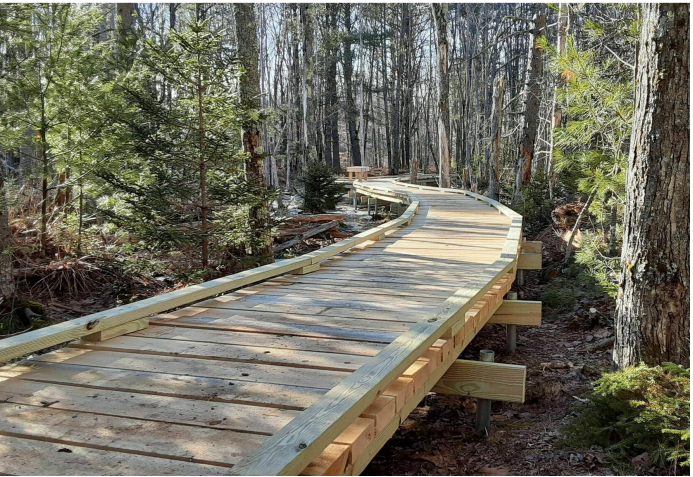

Photo 2: Typical Boardwalk Complete



Plan prepared by:
Erik Donohoe
Parks Specialist, Town of Yarmouth
2/22/2023

Town of Yarmouth
200 Main St.
Yarmouth, ME 04096

GRAVEL WETLAND CROSSING CROSS SECTION

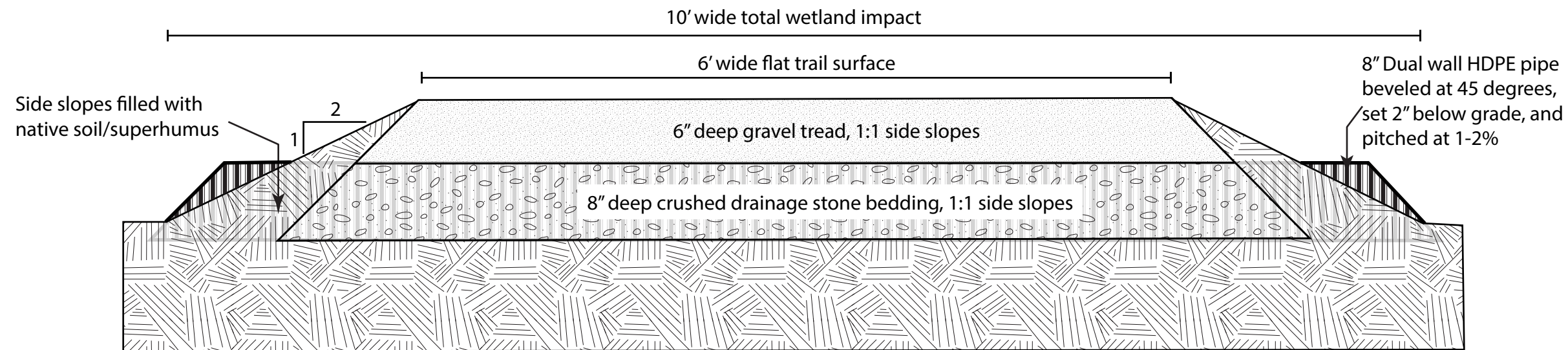

GRAVEL WETLAND CROSSING PLAN VIEW

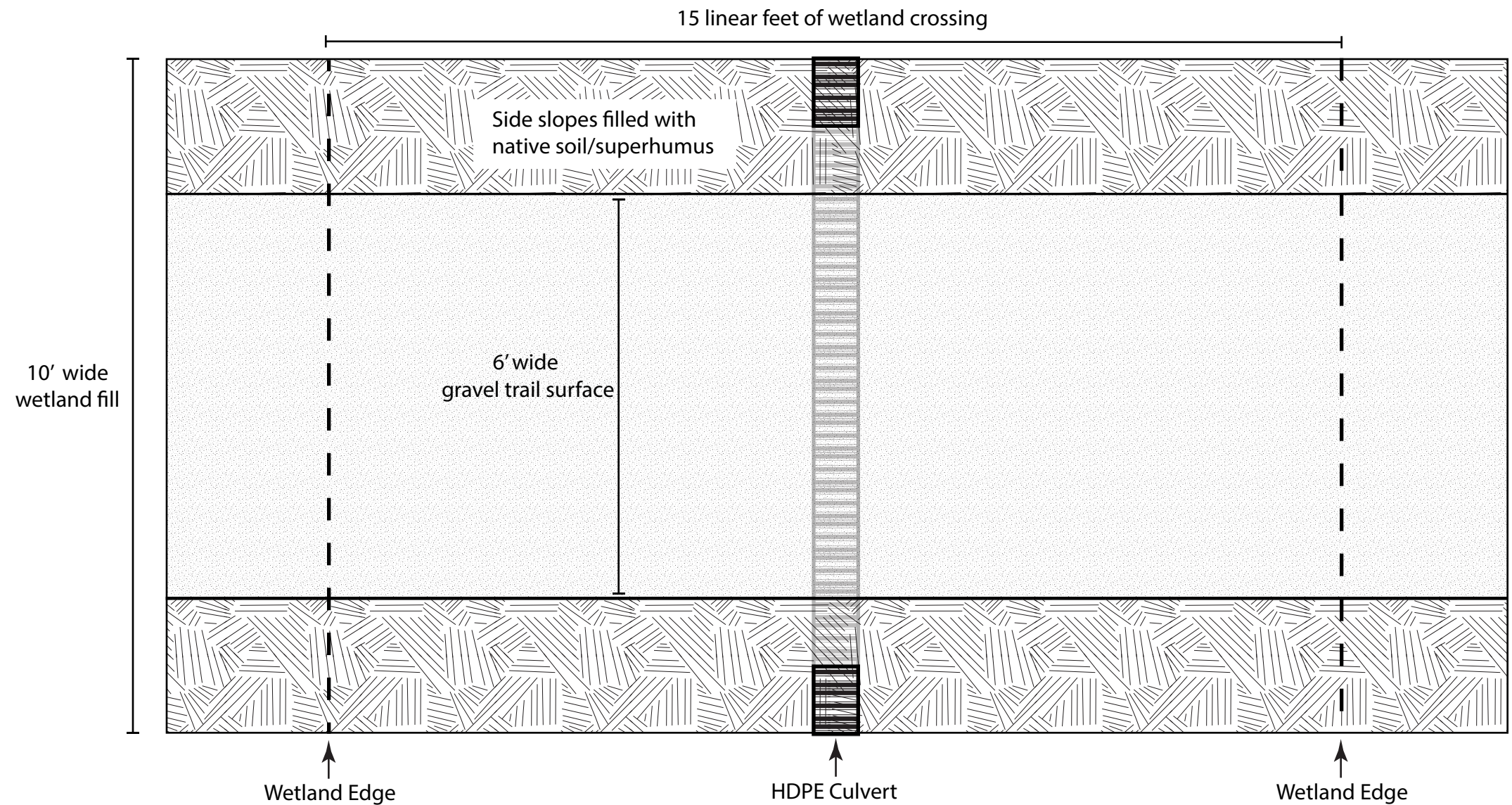

FIGURE 4:

Crossing design for WC-3
Spear Farm Boardwalk Project



Town of Yarmouth
200 Main Street
Yarmouth, ME 04096

Plan prepared by:
Erik Donohoe
Parks Specialist
Yarmouth Community Services
Town of Yarmouth
5/24/2022

BRIDGE CROSSING AT WC-8 PLAN VIEW
 (Bridge is 7' wide, with 6' 5" clear tread and 20' long)

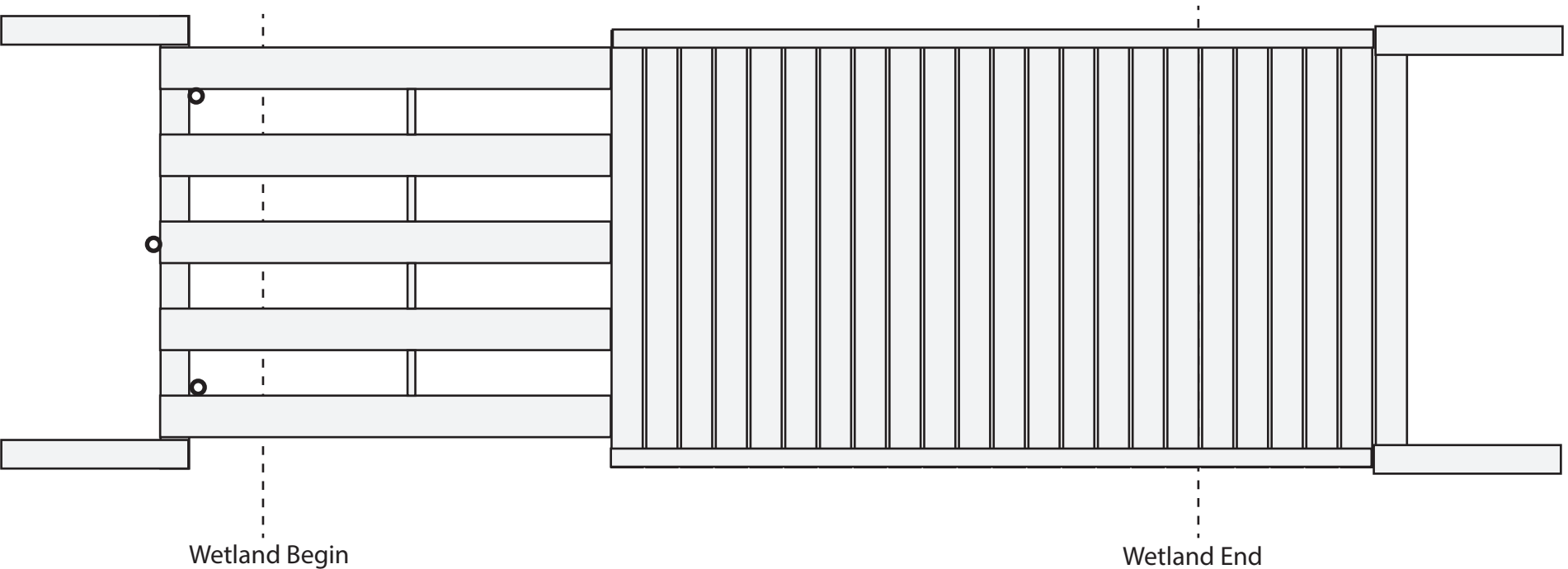

BRIDGE CROSSING AT WC-8 LANDSCAPE VIEW

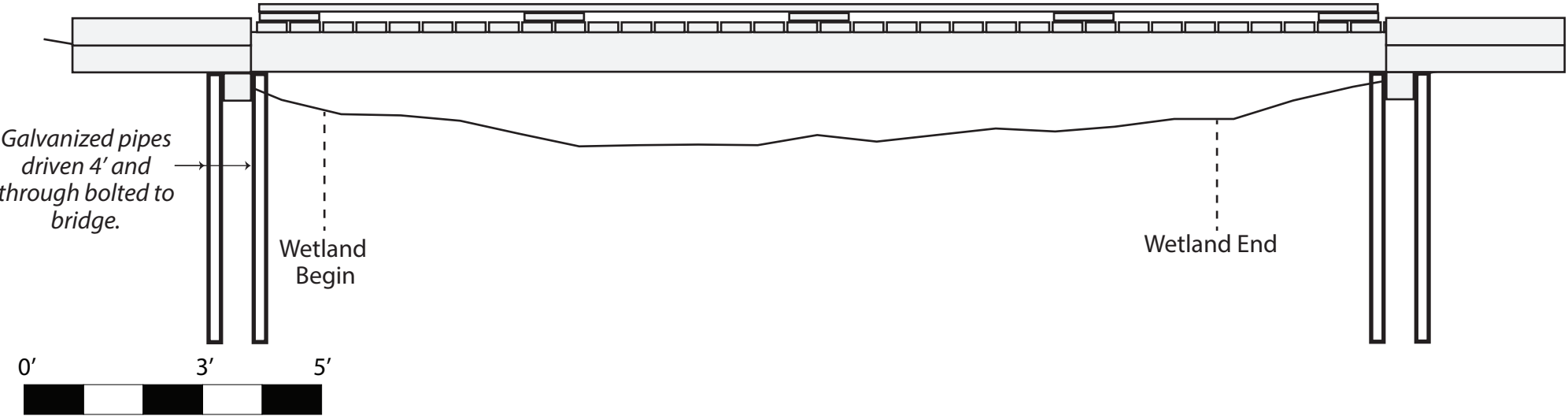

FIGURE 5:

Crossing design for WC-8
 Spear Farm Boardwalk Project



Typical raised bridge



Typical raised bridge



Town of Yarmouth
 200 Main Street
 Yarmouth, ME 04096

Plan prepared by:
 Erik Donohoe
 Parks Specialist
 Yarmouth Community Services
 Town of Yarmouth
 3/28/2023

FIGURE 6
Flood Hazard Map
Spear Farm Boardwalk Project

- ===== Trails
- Maintenance/Emergency Access Trail
- - - - - Wetland
- Stream
- Flood Hazard Zone AE
- Replace Upland Bog Bridging with Gravel

Notes:
1. WC-# equals resource crossing see attached figures for corresponding resource crossing designs.
2. The bridge at WC-8 will be anchored with galvanized pipe driven to a depth of 4' to account for expansion of flood hazard zone anticipated to become effective June of 2024.

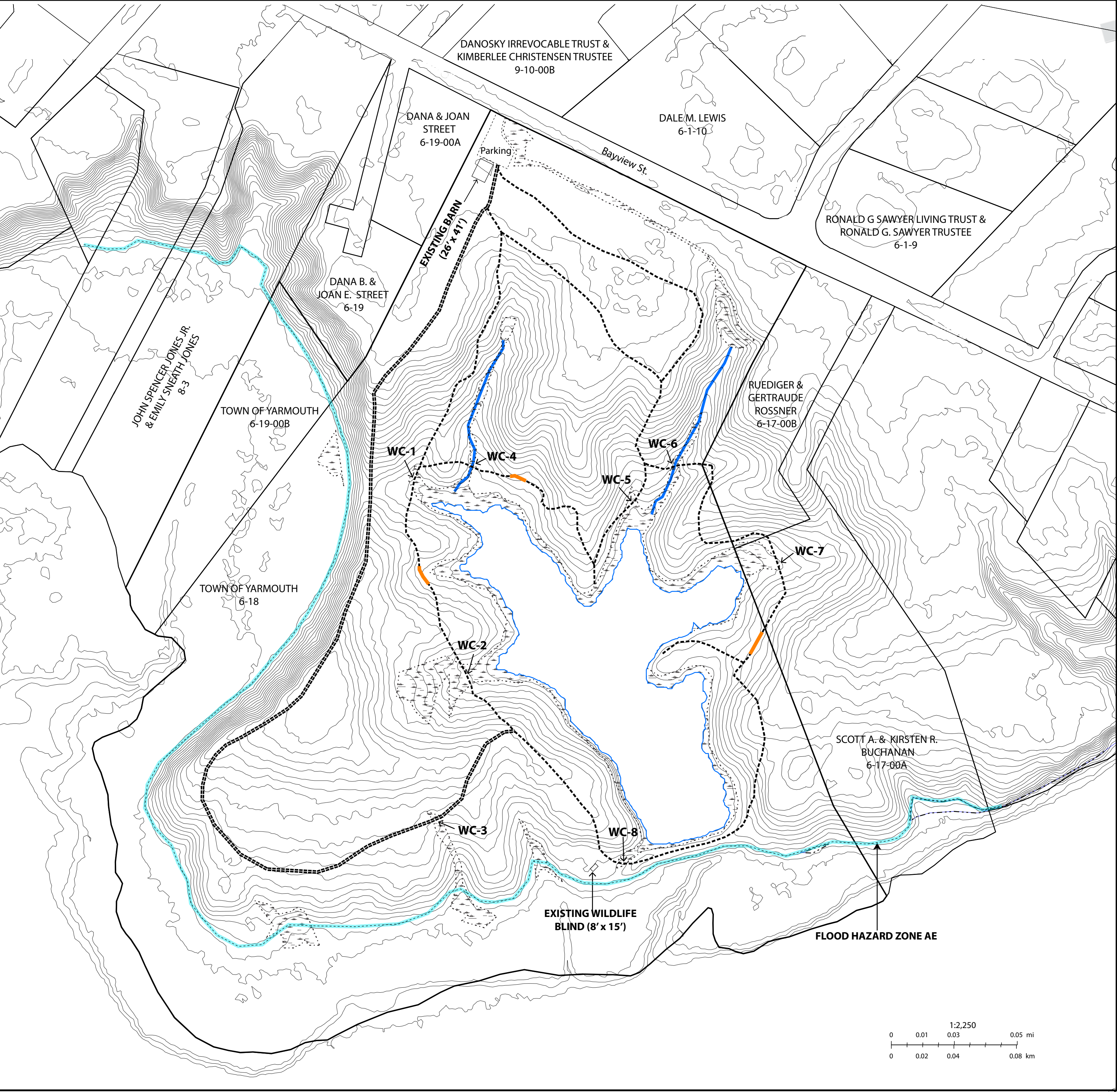

Spear Farm Boardwalk Project
Map-Lot: 6-18

Plan Prepared by:
Erik Donohoe
Parks Specialist, Yarmouth Community Services
for the Town of Yarmouth
4/6/2023



Town of Yarmouth
200 Main Street
Yarmouth, ME 04096