

### **Dog Park Rules**

- Dogs must be off leash only within the designated fenced area.
- Owners/Handlers must clean up after their dogs.
- Aggressive dogs are not allowed.
- Children under 14 years of age must be accompanied by an adult.
- Female dogs in season are not allowed at the facility.
- No smoking.



### **Throw Us A Bone & Support Our Local Dog Park**

If you would like to give a **tax deductible contribution** toward establishing the Dog Park in Tifton, please complete the information below and send in along with your contribution.

Name: \_\_\_\_\_

Address: \_\_\_\_\_

Phone: \_\_\_\_\_

E-Mail: \_\_\_\_\_

- \$2,500 Great Dane Sponsorship
- \$1,000 Golden Retriever Sponsorship
- \$500 Boxer Sponsorship
- \$250 Pug Sponsorship
- \$\_\_\_\_\_ Donation

Checks/Money Orders to be made payable to:  
"Save Our Pets"

Please send your contribution to:  
**Becky Moore, City of Tifton**  
c/o Save Our Pets—Dog Park  
Post Office Box 229  
Tifton, Georgia 31793

### **Why a Dog Park?**

This off-leash park offers a safe and controlled environment for dogs to play and exercise. This well-shaded designated off-leash area for dogs and dog owners to socialize with each other. The Tifton Dog Park will also create many community benefits by:

- socializing and exercising dogs in a safe environment.
- promoting responsible pet ownership through vaccinations and clean up.
- enabling dogs to legally run off-leash.
- promoting public health and safety.

The park will be maintained by the City of Tifton, but it will be up to the daily users to maintain the cleanliness of the park. This is a passion for many citizens to have an open space option for their dogs .

### **Proposed Timeline**

#### **PHASE ONE:**

- Install fencing for the Large & Small Dog Areas
- General Clean-Up to Take Place
- Create a Dog Friendly Entrance with Concrete Slab & Double Gate
- Create & Post Signage
- Trashcans, Clean Up Tools, Pet Waste Receptacles, & Recycling Cans

#### **PHASE TWO:**

- Install Benches & Tables
- Complete Landscaping Including Trees & Bushes

#### **PHASE THREE:**

- Create Bathing/Rinsing Station
- Implement Walking Trail
- Install Agility Apparatuses
- Put in Restrooms
- Install Splash Pond
- Lighting

#### **For more information, please contact:**

Becky Moore  
bmoore@tifton.net / 229.391.3937  
[http://www.tifton.net/residents/parks\\_and\\_recreation/dog\\_park.php](http://www.tifton.net/residents/parks_and_recreation/dog_park.php)

## **City of Tifton announces**

# **Tifton's Dog Park**



**It's off the CHAIN!**

### Walking Trail:

The committee is looking at incorporating a walking trail that will circle the dog park in its entirety.

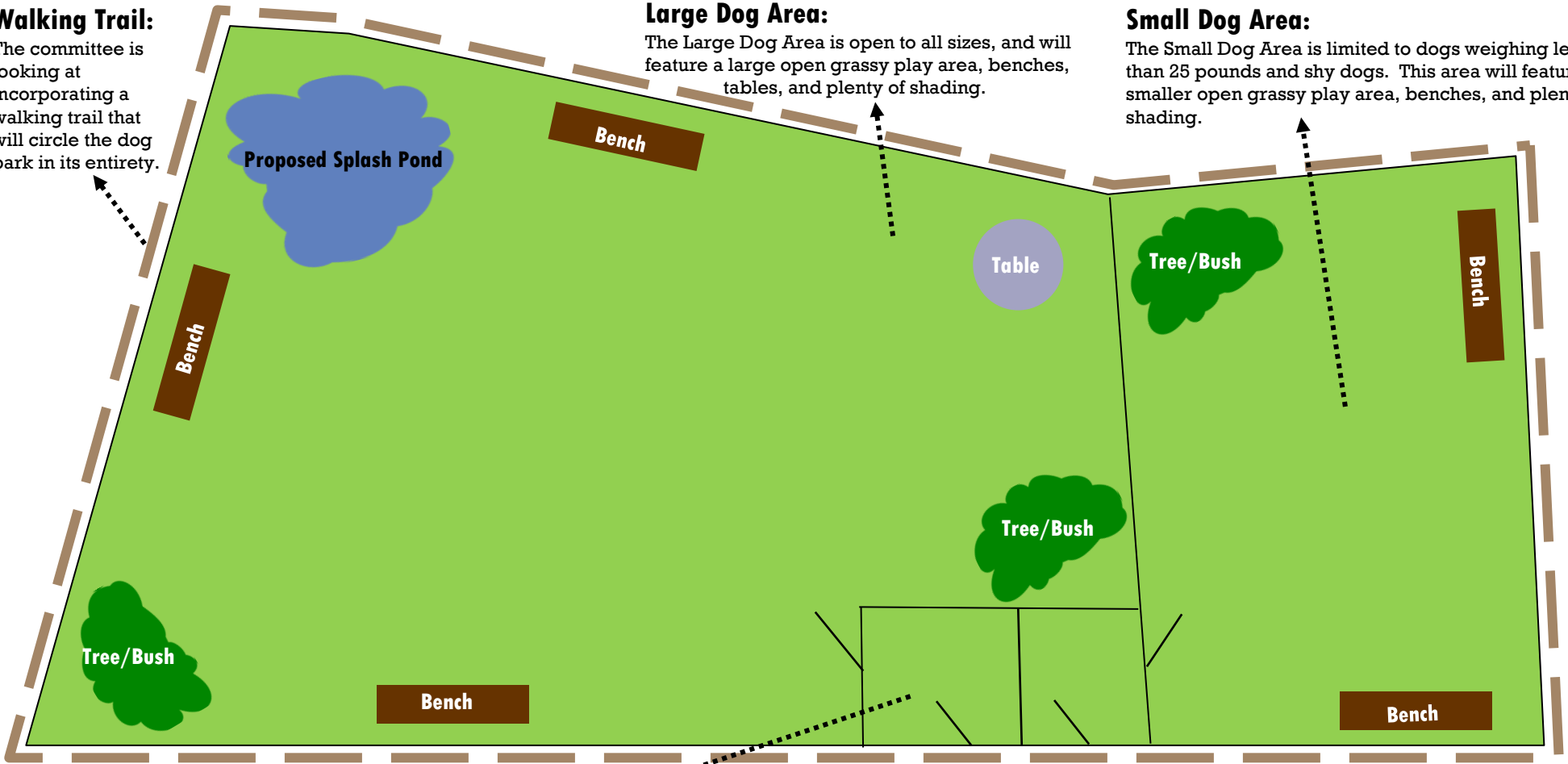

### Large Dog Area:

The Large Dog Area is open to all sizes, and will feature a large open grassy play area, benches, tables, and plenty of shading.

### Small Dog Area:

The Small Dog Area is limited to dogs weighing less than 25 pounds and shy dogs. This area will feature a smaller open grassy play area, benches, and plenty of shading.

### Entrance Area:

The park will consist of a set of Entrance Areas with double-gated areas (one for large area and one for small area) that will allow for unleashing pets prior to entering the park.

### Restrooms/Washing Station:

Restrooms and a Dog Washing Station are incorporated in Phase Three.

### Parking:

Park users traveling to the park in their vehicles will have plenty of parking available.

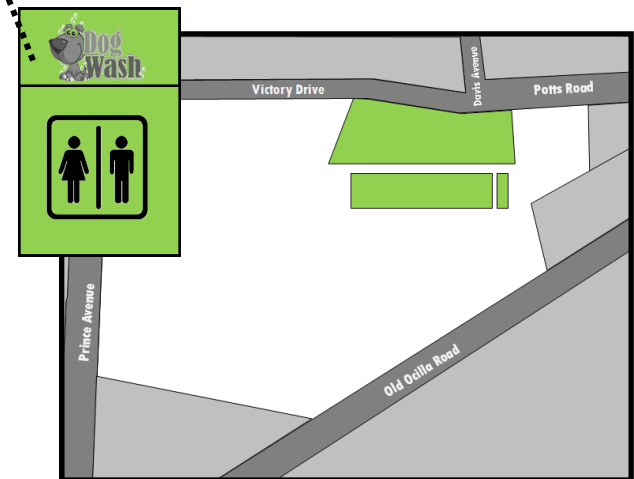

# Tifton's Community Dog Park Proposed Plan