

Right Plant: Right Place Fire edition



Kitty Connolly, Executive Director

THEODORE PAYNE FOUNDATION
for Wild Flowers and Native Plants

Theodore Payne Foundation



Theodore Payne (1873-1963)

*I made up my mind that
I would awaken
a greater interest
in the native flora.*

— Theodore Payne







Landscaping in a Fire-Prone Area



What is a native plant?



Eschscholzia californica, California Poppy
with green metallic sweat bee



California is home to nearly 7,000 native plant species, subspecies and varieties – more than in all of the other continental states combined.

One-third of these plants are endemic.

Most of the state has a Mediterranean climate (not desert).



Mediterranean Climates

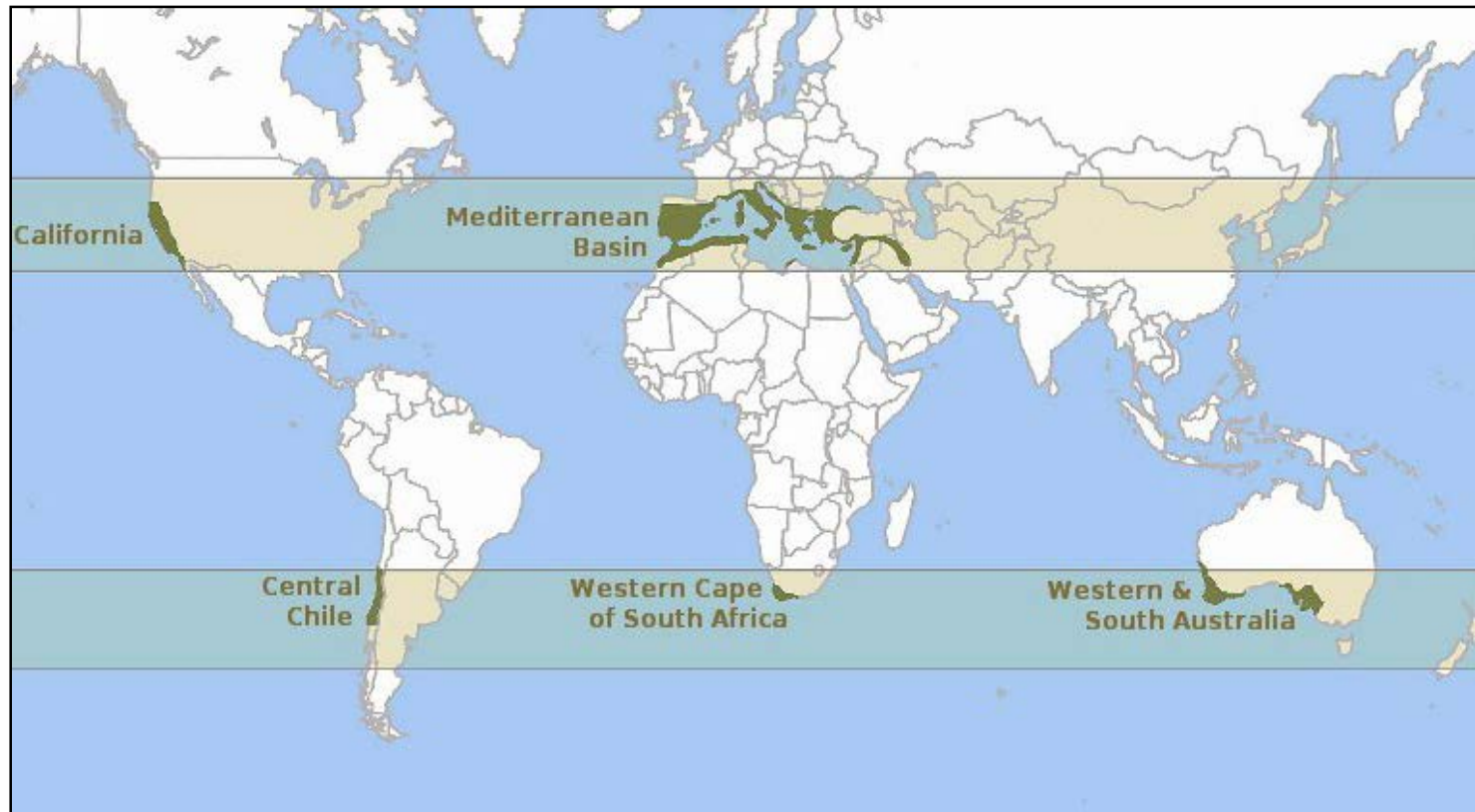

Conservation International
named the California
Floristic Province as a
Biodiversity Hotspot.

Qualifications to be a Hotspot:

1,500 endemic vascular plants

Loss of 30% of native vegetation

California:

~4,000 endemic vascular plants

Loss of 75% of native vegetation



Why use native plants?



Epilobium (Zauschneria) cv.
California Fuchsia cultivar





Theodore Payne Foundation







Theodore Payne Foundation



Native plants make better habitat!



Allen's hummingbird
on *Salvia clevelandii*, Cleveland Sage







Start with the House

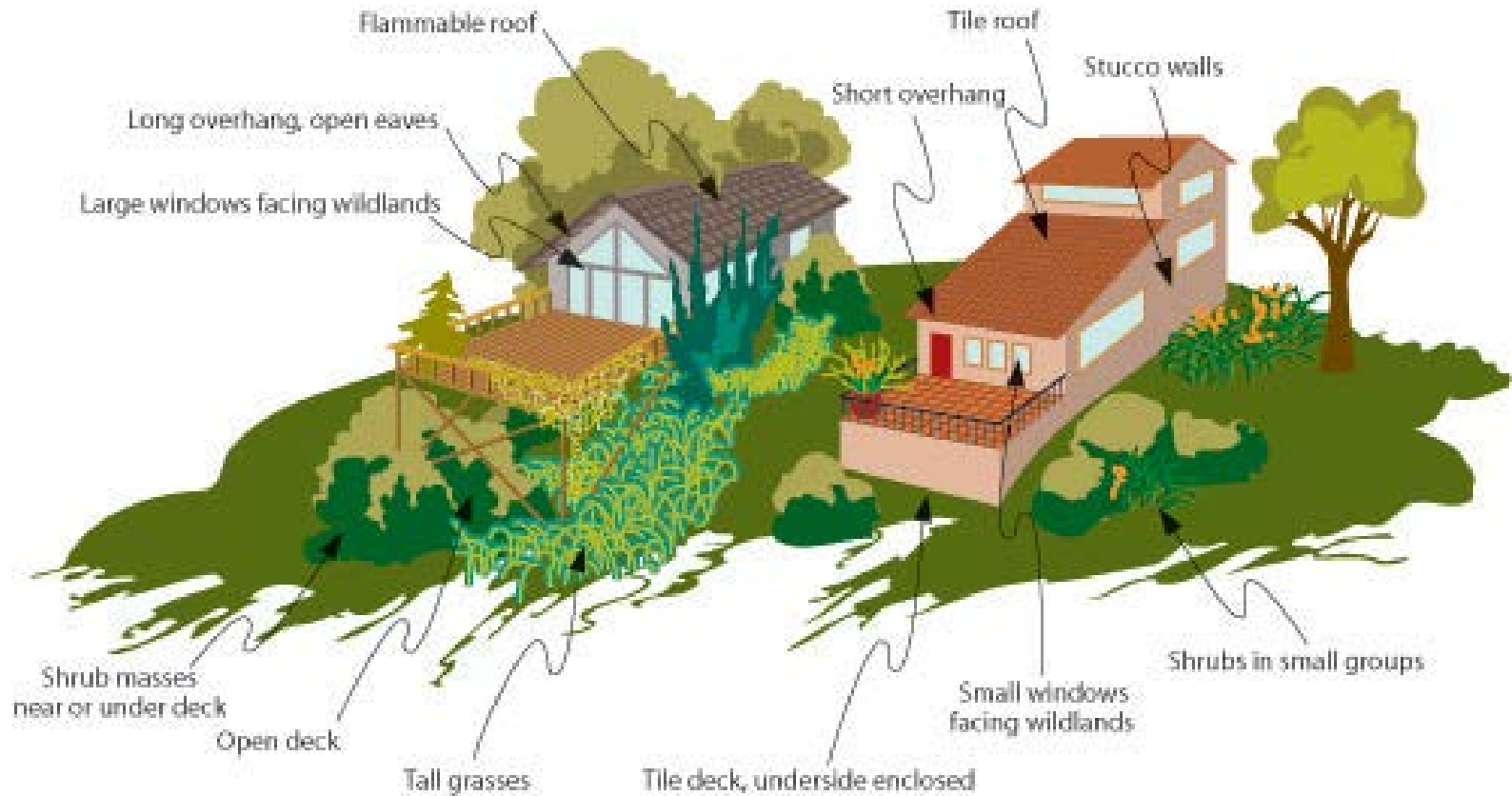

Proper Design + Maintenance = Fire Safety



Develop your garden so that you can enjoy it from indoors, leaving clear space around the house



POORLY MAINTAINED LANDSCAPE

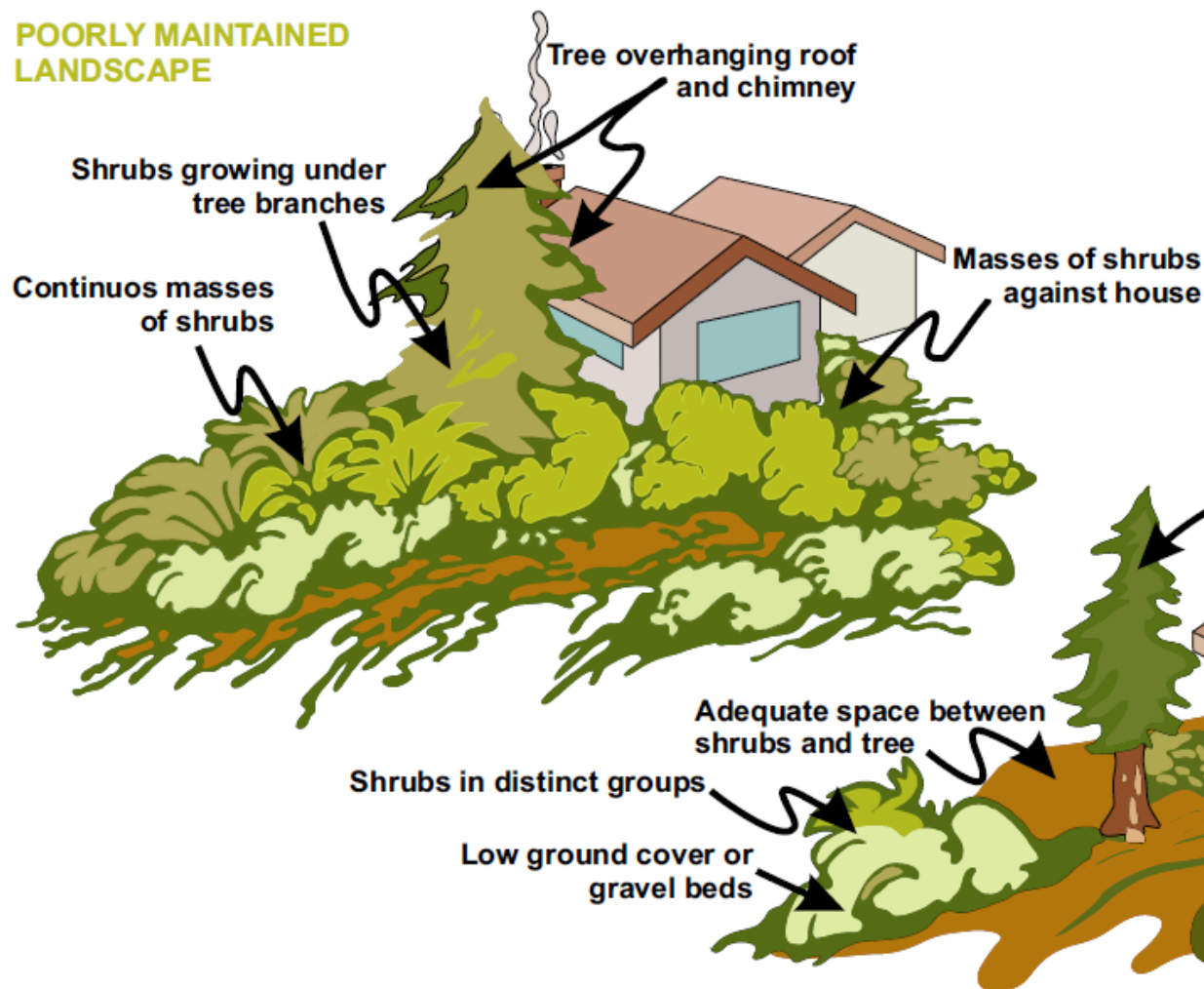

WELL MAINTAINED LANDSCAPE

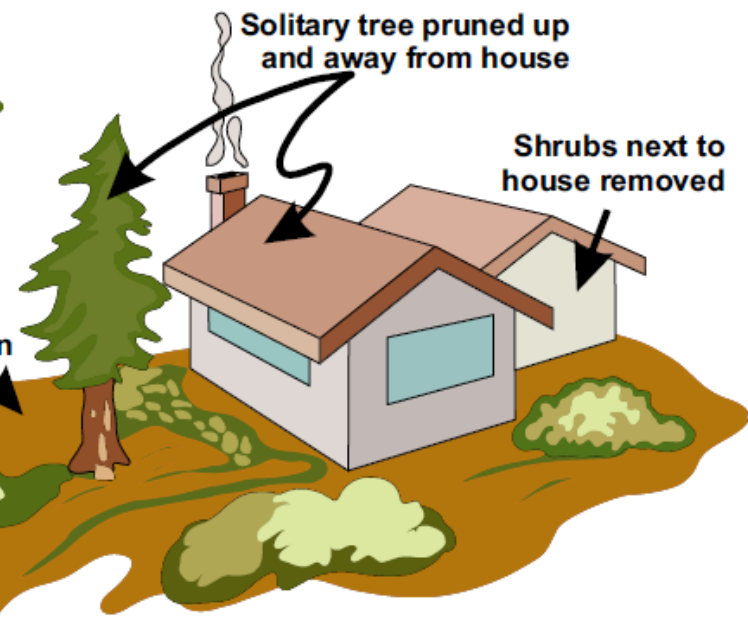

Avoid/Remove Invasive Plants



Getting Started: Assess Your Site

- Climate/Location
- Soil
- Light
- Space
- Existing plants
- Existing irrigation
- Other issues



Getting Started: Assess Your Needs

- Shade/Cooling
- Privacy
- Erosion control
- Fire management
- Non-native edibles
- Entertaining
- Color, fragrance
- Favorite wildlife
- Kids? Pets?



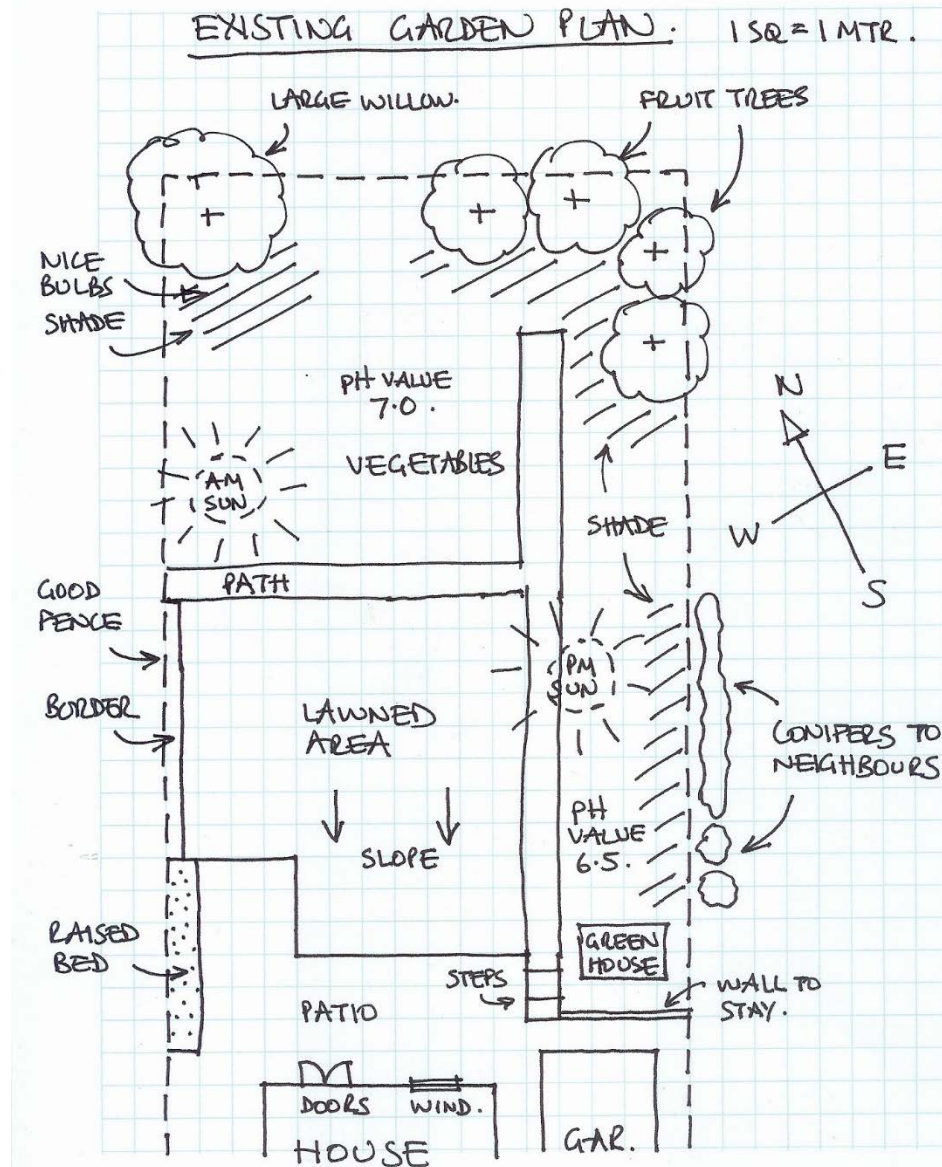

Getting Started: Assess Your Style

- Modern
- Naturalistic
- Formal
- Cottage
- Desert
- Japanese
- Meadow/Prairie
- Eclectic



Small is good!



Planting space

Think short-term and long-term.



Planting space

Think short-term and long-term.



Diplacus longiflorus
sticky monkey flower



Linum lewisii
blue flax



Planting timing: Fall is best!



Getting Plants Established

Establishment = about one year of regular deep watering.



Establishment is mostly about roots.

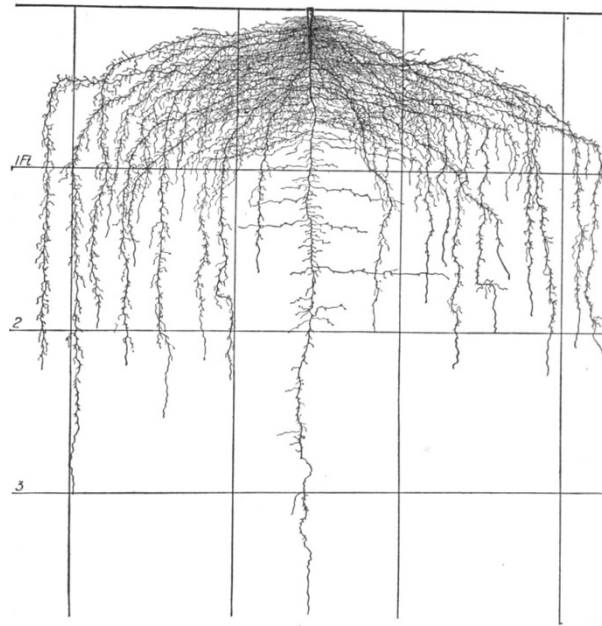

From *Roots Demystified* by Robert Kourik



So many choices! Start with...

- A simple palette of easy plants
- Plants that match your climate, soil, sun, and irrigation
- Plants that fit the space *at mature size*
- Plants that bloom at different times of the year
- Plants that are local



Encelia californica
California bush sunflower



Choose Fire-Resistant Plants



Donny LaMarr



Characteristics of Fire-Resistant Plants

- Easy to maintain
- Drought tolerant, so easy to keep hydrated
- Low-growing
- Slow-growing: not 'weedy'
- Fleshy, green leaves



Brad Kelley

Arctostaphylos glandulosa
Eastwood Manzanita



Arctostaphylos 'Emerald Carpet' manzanita

- Evergreen
- 1'H x 3-5'W
- Coast full sun; inland partial shade
- Adaptable to many soils including clay
- Selected for gardens
- Compact, neat
- Light bloomer
- Attracts hummingbirds





Arctostaphylos 'Emerald Carpet' manzanita



Arctostaphylos densiflora 'Howard McMinn' manzanita

- Evergreen
- 4-6' H x 6' W
- Full sun
- Adaptable to many soils including clay
- Adaptable to garden conditions
- Can be pruned as a hedge
- Prolific bloomer over a long season
- Attracts hummingbirds





Arctostaphylos densiflora 'Howard McMinn'
manzanita



Arctostaphylos manzanita 'Dr. Hurd' manzanatina

- Evergreen
- 15' H x 10' W
- Full sun
- Adaptable to many soils including clay
- Can be pruned as a specimen
- Prolific bloomer
- Attracts hummingbirds





Arctostaphylos manzanita 'Dr. Hurd' manzanita

Theodore Payne Foundation



Rhus integrifolia, lemonade berry

- Evergreen
- 10' H x 10-30' W
- Full sun to part sun
- Well-draining soil
- Spring blooms
- Very deep roots hold slopes
- Very drought tolerant once established
- Attracts birds





Rhus integrifolia, lemonade berry



Heteromeles arbutifolia, toyon

- Evergreen
- 8-15' H x 10-15' W
- Full to part sun
- Adaptable to many soils including clay
- White flowers in summer, red berries in winter
- Attracts birds and butterflies





Heteromeles arbutifolia, toyon



Calliandra californica, red fairyduster

- Evergreen
- 3-5' H x 5' W
- Full sun
- Adaptable to many soils including clay
- Blooms year round
- Very drought tolerant once established
- Attracts hummingbirds, song birds, and butterflies





Calliandra californica, red fairyduster



Ceanothus gloriosus 'Anchor Bay' California lilac

- Evergreen
- 1-2' H x 6-8' W
- Full sun
- Adaptable to many soils including clay
- Conspicuous blue blooms in spring
- Attracts bees and butterflies





Ceanothus gloriosus 'Anchor Bay'

Theodore Payne Foundation



Ceanothus 'Concha' California lilac

- Evergreen
- 5-6' H x 6' W
- Full to part sun
- Well-draining soil
- Spring blooms
- Selected for garden conditions
- Attracts song birds





Ceanothus 'Concha' California lilac



Muhlenbergia rigens, deer grass

- Evergreen
- 2-4' H x 4' W
- Full sun to part sun
- Adaptable to most soils including clay
- Decorative seed heads
- Deep roots hold slopes
- Winter refuge
ladybugs, forage for
caterpillars & seed for
songbirds





Muhlenbergia rigens, deer grass



Chilopsis linearis, desert willow

- Deciduous
- 20' H x 15' W
- Full sun to part sun
- Adaptable to many soils including clay
- Pink blooms in summer
- Very drought tolerant once established
- Attracts hummingbirds, songbirds & butterflies





Chilopsis linearis, desert willow



Cersis occidentalis, western redbud

- Deciduous
- 15' H x 10' W
- Full sun to part shade
- Adaptable to most soils including clay
- Spring bloom
- Moderate water
- Attracts humming birds, butterflies & bees





Cercus occidentalis, western redbud



Abutilon palmeri, Indian mallow

- Evergreen
- 4' H x 4' W
- Full sun
- Adaptable to most soils including clay
- Blooms year round
- Attracts song birds & butterflies





Abutilon palmeri, Indian mallow



A Singular Resource

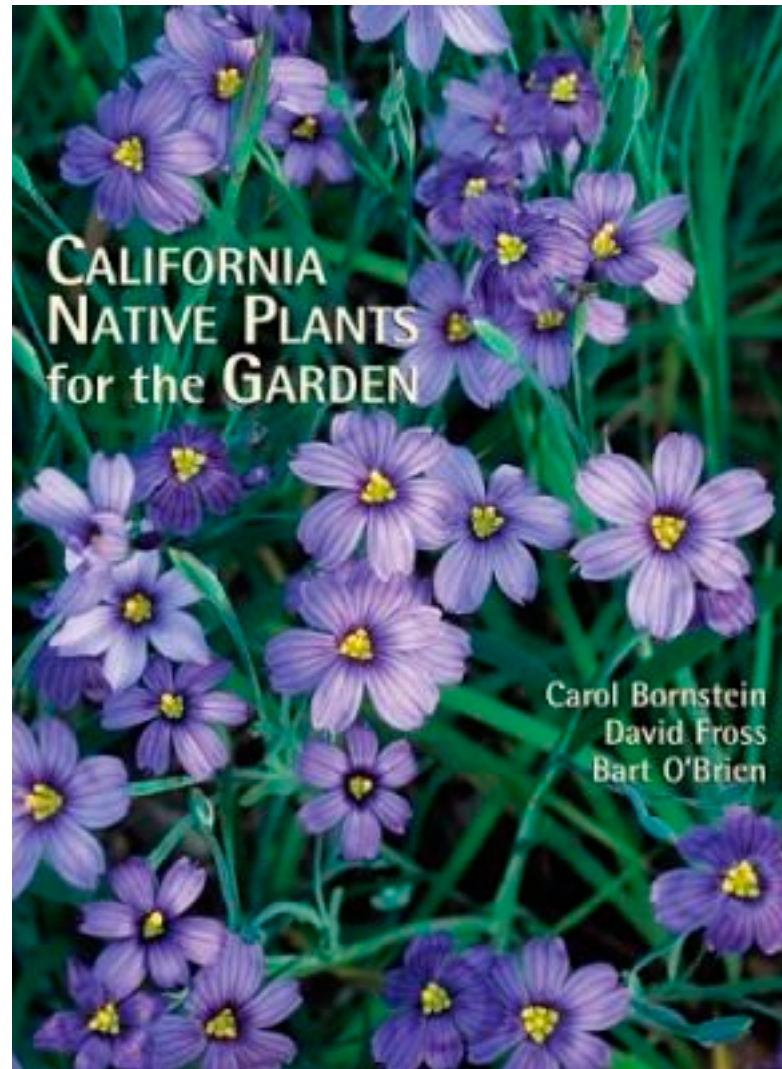

New and very good!

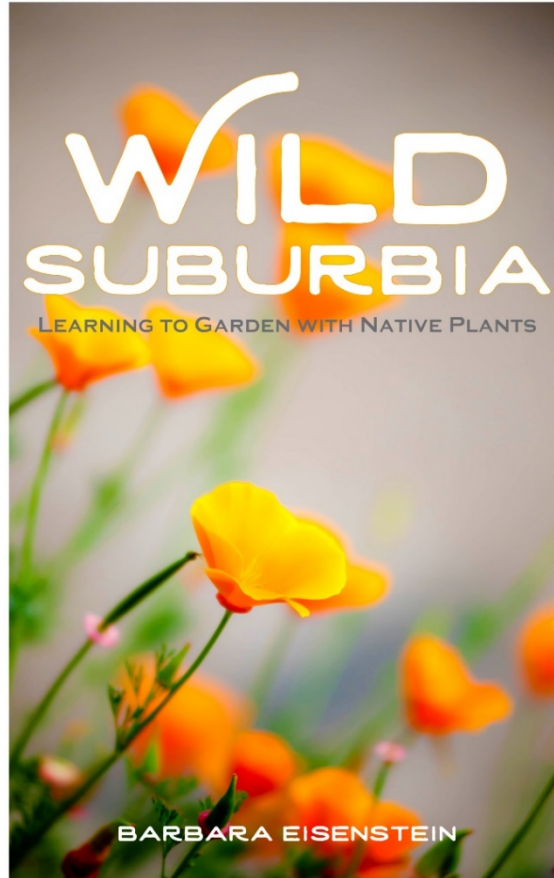

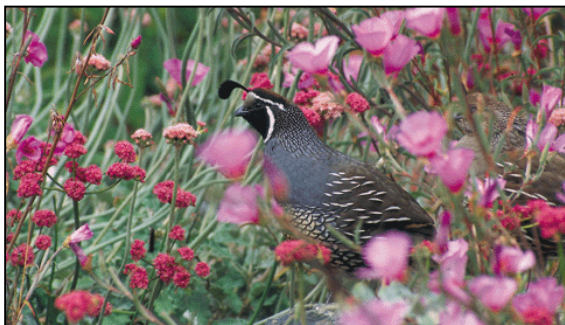

**Grow local.
Plant native!**

THEODORE PAYNE NURSERY & STORE

Hours through July 1

Tuesday-Saturday, 8:30am-4:30pm

NATIVE PLANT GARDEN TOUR

Sat & Sun, April 14 & 15

Theodore Payne Foundation for Wild Flowers & Native Plants

10459 Tuxford Street, Sun Valley, CA 91352 | theodorepayne.org

Theodore Payne Foundation

























*Theodore Payne Foundation
inspires and educates
Southern Californians about
the beauty and ecological benefits of
California native plants in landscapes.*





















Theodore Payne Foundation for Wild Flowers & Native Plants

theodorepayne.org

Theodore Payne Foundation

