

# Robbinsville

## TOWNSHIP

BE AT THE CENTER OF IT ALL

## Land Preservation

Robbinsville Township  
Mercer County, New Jersey

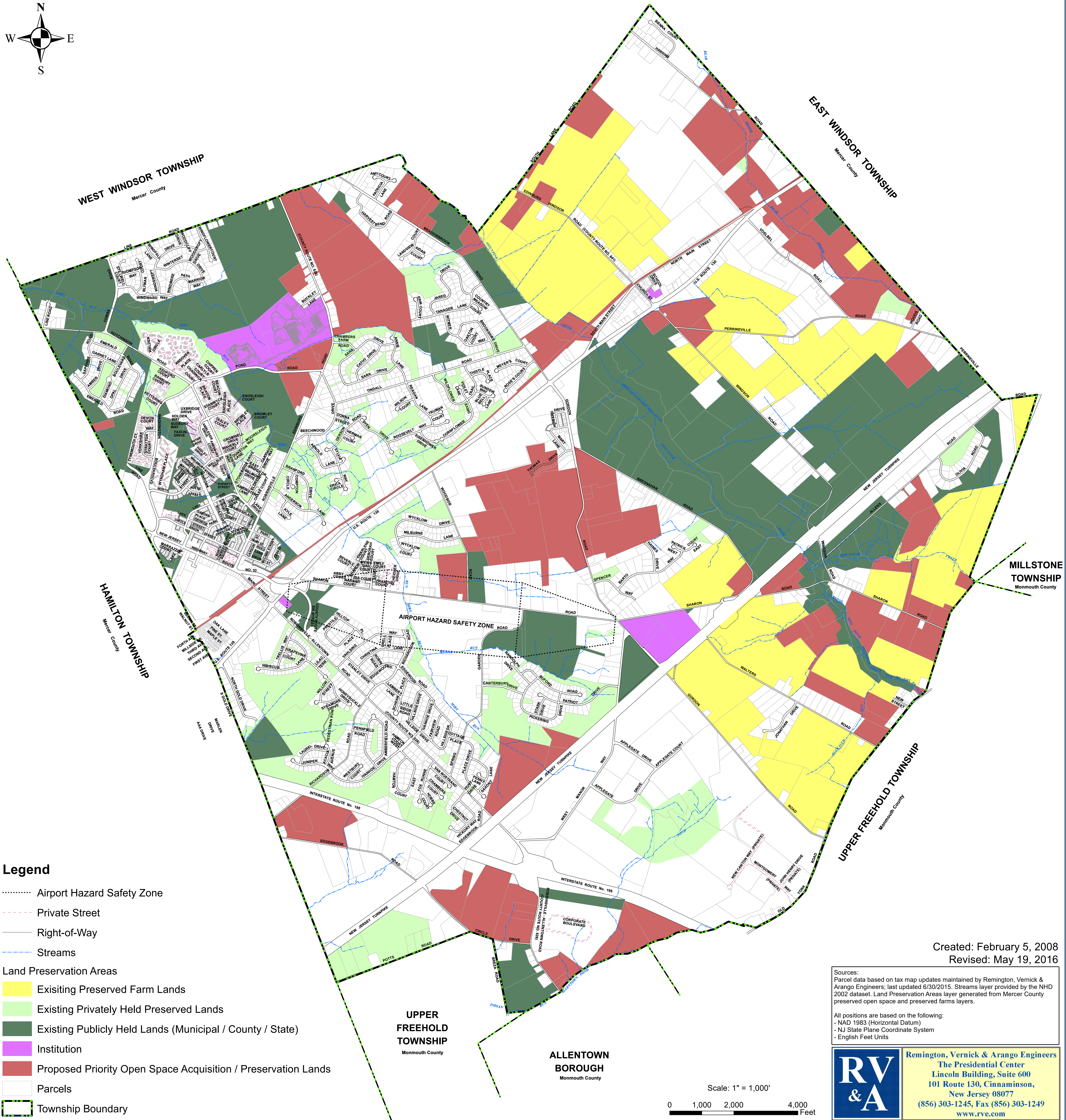
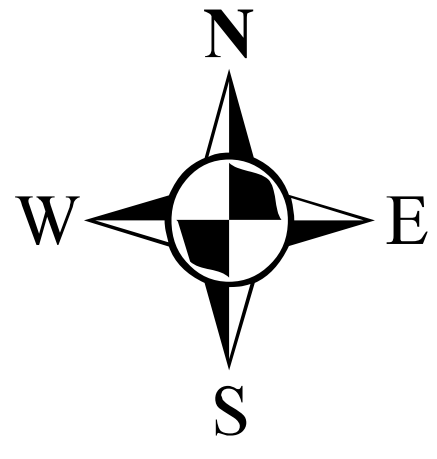

### Legend

- ..... Airport Hazard Safety Zone
- - - Private Street
- Right-of-Way
- Streams

### Land Preservation Areas

- Existing Preserved Farm Lands
- Existing Privately Held Preserved Lands
- Existing Publicly Held Lands (Municipal / County / State)
- Institution
- Proposed Priority Open Space Acquisition / Preservation Lands
- Parcels
- Township Boundary

Created: February 5, 2008  
Revised: May 19, 2016

Sources:  
Parcel data based on tax map updates maintained by Remington, Vernick & Arango Engineers; last updated 6/30/2015. Streams layer provided by the NHD 2002 dataset. Land Preservation Areas layer generated from Mercer County preserved open space and preserved farms layers.

All positions are based on the following:  
- NAD 1983 (Horizontal Datum)  
- NJ State Plane Coordinate System  
- English Feet Units



Remington, Vernick & Arango Engineers  
The Presidential Center  
Lincoln Building, Suite 600  
101 Route 130, Cinnaminson,  
New Jersey 08077  
(856) 303-1245, Fax (856) 303-1249  
www.rve.com

Scale: 1" = 1,000'

0 1,000 2,000 4,000 Feet