

**DAVIS • MARTIN • POWELL**  
ENGINEERS & SURVEYORS

6415 OLD PLANK RD., HIGH POINT, NC 27685 | T: (336) 986-4651 | F: (336) 986-4658 | WWW.DMP-NC.COM | LICENSE E-4045

REV	DATE	DESCRIPTION	BY	PROJECT	DATE	DESIGNED	DRAWN	CHECKED	SCALE	AS NOTED	SURVEYED
1	5/14/14	PLANNING SUBMITTAL		IL0058	MAY 2014	GHS					N/A
2											
3											
4											
5											
6											

PROPOSED CONCEPT PLAN  
6835 MATHEWS MINT HILL ROAD  
MINT HILL, NORTH CAROLINA

LANDSCAPE PLAN  
SHEET NO. L-1

**PLANTING AND SEEDING NOTES**

- ROUGH GRADING TO BE COMPLETED PRIOR TO THE START OF PLANT INSTALLATION. SUBSTANTIAL COMPLETION SIGN-OFF BY PROJECT MANAGER OF THE ROUGH GRADING SHALL OCCUR PRIOR TO THE START OF PLANTING INSTALLATION.
- BALLED AND BURLAPPED PLANTS/TREES TO BE PLANTED PRIOR TO CONTAINER OR BEDDING PLANTS.
- CONTRACTOR RESPONSIBLE FOR LOCATING ALL UTILITIES AND UNDERGROUND IMPEDIMENTS PRIOR TO BEGINNING PLANTING.
- ALL WEEDS, NON-NATIVE INVASIVE SPECIES, AND EXOTIC SPECIES LOCATED WITHIN THE PROJECT LIMITS SHALL BE ELIMINATED PRIOR TO PLANTING BED CREATION AND PLANTING.
- PLANTS ARE TO BE PURCHASED BY SCIENTIFIC NAMES. THEY SHALL BE REPRESENTATIVE OF THEIR SPECIES, MEET ALL NOTED CONDITIONS OF SPECIFICATIONS, AND SHALL BE IN VIGOROUS GROWING CONDITION MEETING ANS1 STANDARD Z60.
- PROJECT MANAGER OR DESIGNEE MAINTAINS RIGHT TO REJECT ANY PLANT DUE TO AESTHETICS OR STRUCTURAL DEFICIENCY AT ANY TIME.
- CONTRACTOR SHALL LOCATE ALL PLANTS AWAY FROM KNOWN PERMANENT FIXTURES. IF CONFLICT ARISES WITH PLAN, CONTRACTOR SHALL NOTIFY PROJECT MANAGER OR DESIGNEE PRIOR TO PROCEEDING.
- CONTRACTOR RESPONSIBLE FOR FURNISHING AND INSTALLING ALL PLANTS SHOWN ON PLANS IN LOCATIONS SHOWN. QUANTITIES GIVEN ON THE PLAN LEGEND ARE FOR CONTRACTOR'S CONVENIENCE ONLY. IF DISCREPANCIES OCCUR, THE PLANS SHALL OVERRULE THE PLAN LEGEND.
- IF ANY SUBSTITUTIONS ARE REQUESTED BY CONTRACTOR, THEN NOTICE SHALL BE GIVEN TO PROJECT MANAGER OR DESIGNEE AT MINIMUM SEVENTY-TWO (72) HOURS (NOT INCLUDING WEEKENDS) PRIOR TO DESIRED ORDERING DATE/TIME. WHEN SUBSTITUTIONS ARE REQUESTED BY CONTRACTOR, SUGGESTED ACCEPTABLE REPLACEMENTS SHALL ALSO BE PRESENTED AT TIME FOR FULL AND COMPLETE REVIEW BY PROJECT MANAGER OR DESIGNEE.
- SEED / SOD BED PREPARATION: ALL AREAS TO BE SODDED / SEEDING ARE TO RECEIVE A MINIMUM OF 2" OF APPROVED TOPSOIL. ALL DEBRIS, ROCKS, ETC. LARGER THAN 5" ARE TO BE REMOVED PRIOR TO SEEDING OR PLANTING. APPROVED TOPSOIL IS TO BE PREFERABLY FROM ON-SITE STOCKPILE FROM STRIPPING OPERATIONS - SEE EROSION AND SEDIMENT CONTROL PLANS. IF ON-SITE TOPSOIL IS NOT AVAILABLE, CONTRACTOR SHALL PROVIDE TO SITE ACCORDINGLY.
- TREES TO BE STAKED WILL BE DESIGNATED BY THE LANDSCAPE ARCHITECT. TREE STAKING FOR CANOPY AND LARGE EVERGREEN TREES SHALL NOT EXCEED 90 DAYS.
- ALL PLANT BEDS ARE TO RECEIVE A MINIMUM OF 4" OF APPROVED TOPSOIL TILLED IN TO A DEPTH OF 8" TO ENSURE INTEGRATION WITH EXISTING SOIL. APPROVED TOPSOIL IS TO BE PREFERABLY FROM ON-SITE STOCKPILE FROM STRIPPING OPERATIONS - SEE EROSION AND SEDIMENT CONTROL PLANS. IF ON-SITE TOPSOIL IS NOT AVAILABLE, CONTRACTOR SHALL PROVIDE TO SITE ACCORDINGLY.
- ALL MULCH TO BE CERTIFIED TO BE FREE OF WEEDS, NON-NATIVE INVASIVE SPECIES AND THEIR LARVAE. MULCH SAMPLE SUBMITTAL WILL BE PROVIDED TO LANDSCAPE ARCHITECT BEFORE SITE DELIVERY.
- PLANTING SHOULD OCCUR IMMEDIATELY AFTER CONSTRUCTION TO STABILIZE AREAS OF BARE SOIL.
- PRIOR TO PERMANENT PLANTINGS AND SODDING, THE SITE SOILS SHALL BE PREPARED FOR PLANTING. WHERE NEEDED THE SOILS SHOULD BE PLOWED OR RIPPED TO IMPROVE COMPACTED SOILS AND ELIMINATE CHANNELIZED FLOW FROM NON-TARGET AREAS.
- IT IS THE RESPONSIBILITY OF THE CONTRACTOR TO ENSURE A HEALTHY AND VIABLE PLANT AND THE PLANT SHALL BE REJECTED IF DEEMED UNHEALTHY OR UNFIT AT ANY TIME DURING THE CONTRACT OR WARRANTY DURATION.
- ALL PLANT MATERIAL SHALL CONFORM TO OR EXCEED THE AMERICAN STANDARD FOR NURSERY STOCK (LATEST EDITION) AS PUBLISHED BY THE AMERICAN ASSOCIATION OF NURSERYMEN.
- IT SHALL BE NOTED THAT ALL SECTIONS OF THE SITE THAT ARE SLOPED 3:1 OR HIGHER WILL BE COVERED WITH EROSION CONTROL STABILIZATION COIR FABRIC (WITH 1" SQUARE OPENINGS) PRIOR TO PLANTING TO ENSURE IMMEDIATE STABILIZATION. LANDSCAPE CONTRACTOR SHALL CUT FABRIC AT EACH PLANT LOCATION AND PLACE PLANTS ACCORDING TO PLAN. ALL FABRIC SHALL BE RE-STAKED PER ENGINEERS ORIGINAL DRAWINGS IMMEDIATELY AFTER PLANTING.

**TOWN OF MINT HILL LANDSCAPE REQUIREMENTS**

- SERVICE YARD:**  
PLANTING/BUFFER REQUIRED: 5' HT. OPAQUE FENCE OR EVERGREEN SHRUBS AT 5' O.C (PLANTED AT 3' HT AND TO GROW TO 6' HT WITHIN 2 YEARS)  
PLANTING/BUFFER PROVIDED: SEE PLANS - ILD AT 5' O.C. MIXED WITH OSF PLANTED AS SHOWN(ALL PLANTED AT 3' HT).
- PARKING AREAS VISIBLE FROM STREETS (PERIMETER YARD NON-RESIDENTIAL):**  
PLANTING/BUFFER REQUIRED: 4' HT. OF 75% EVERGREEN SHRUBS  
PLANTING/BUFFER PROVIDED: SEE PLANS - ILD AT 5' O.C.
- PARKING AREA ISLANDS:**  
TREES REQUIRED: 1 WITHIN 60' OF EACH SPACE  
TREES PROVIDED: 1+ WITHIN 60' OF EACH SPACE (SEE PLAN)
- ENHANCED LANDSCAPE AREAS:**  
SEE PLANS FOR PLANTINGS
- STREETScape:**  
MATHEWS MINT HILL ROAD: 264 LF  
TREES REQUIRED: 1 TREE PER 50 LF. = 6 TREES AT 2.5" CALIPER  
TREES PROPOSED: 6 TREES (QUB) AT @ 2.5" CAL.
- EVANS DRIVE: 192 LF  
TREES REQUIRED: 1 TREE PER 50 LF. = 4 TREES AT 2.5" CALIPER  
TREES PROPOSED: 4 TREES (RED MAPLES) - EXISTING

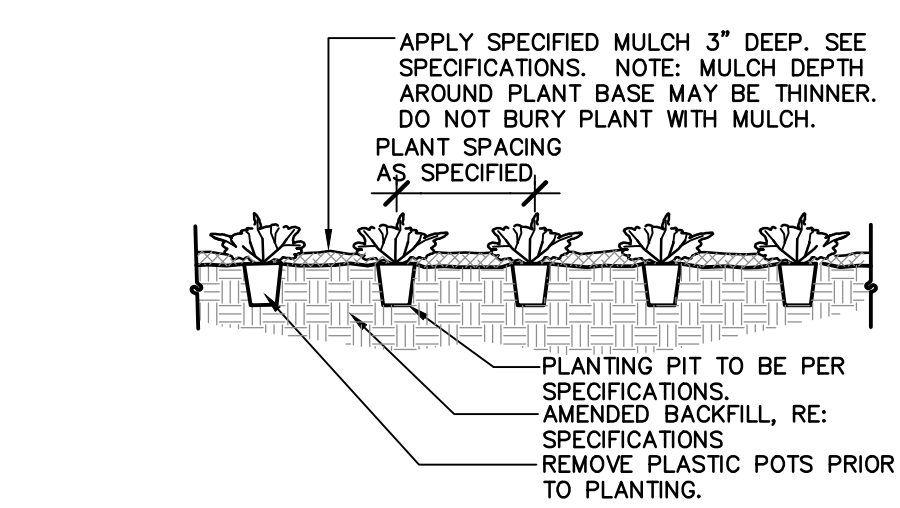

1 PERENNIALS/GROUND COVERS  
NOT TO SCALE

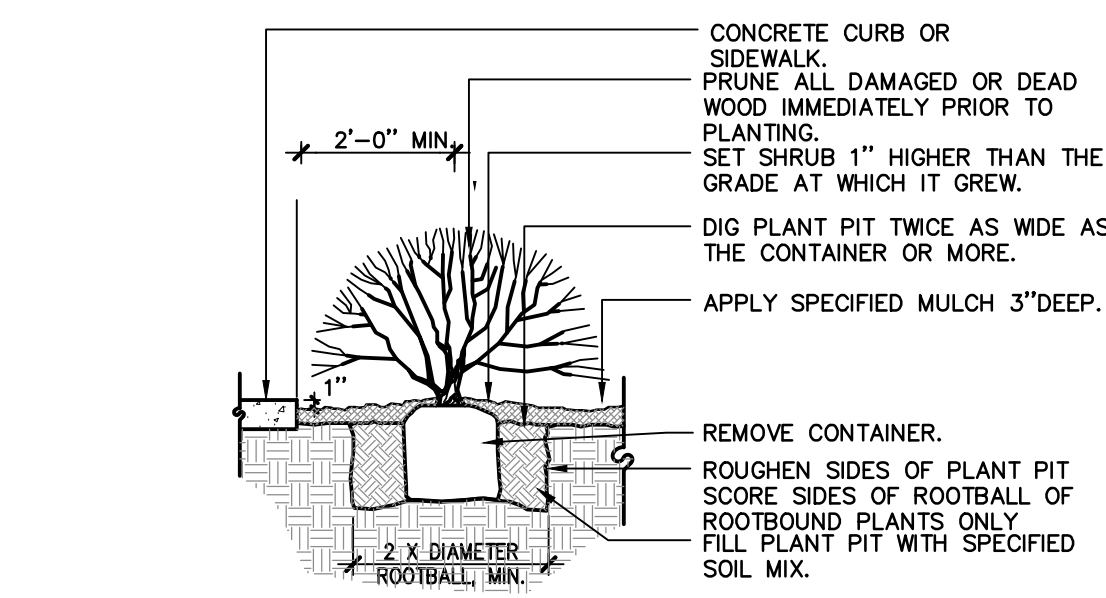

2 SHRUB PLANTING  
NOT TO SCALE

PLANT SPACING CHART

SPACING 'D'	ROW 'A'	PLANTS /s.f.
6" o.c.	5.20' o.c.	4.61
8" o.c.	6.93' o.c.	2.60
10" o.c.	8.66' o.c.	1.66
12" o.c.	10.40' o.c.	1.00
15" o.c.	13.00' o.c.	0.73
18" o.c.	15.60' o.c.	0.51
24" o.c.	20.80' o.c.	0.29

3 TRIANGULAR SPACING FOR SHRUBS & GROUNDCOVERS (TYPICAL)  
NOT TO SCALE

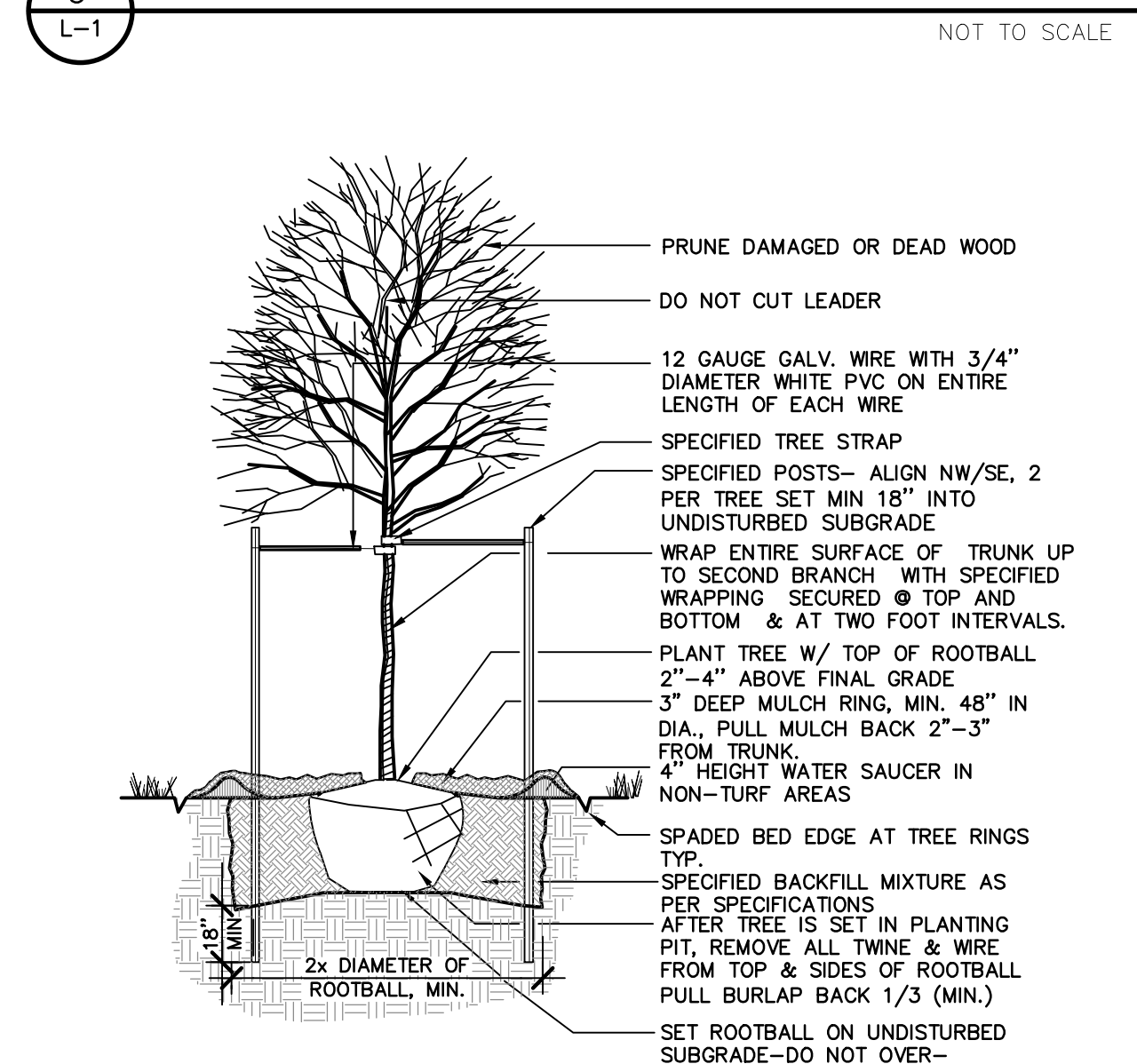

4 DECIDUOUS TREE PLANTING  
NOT TO SCALE

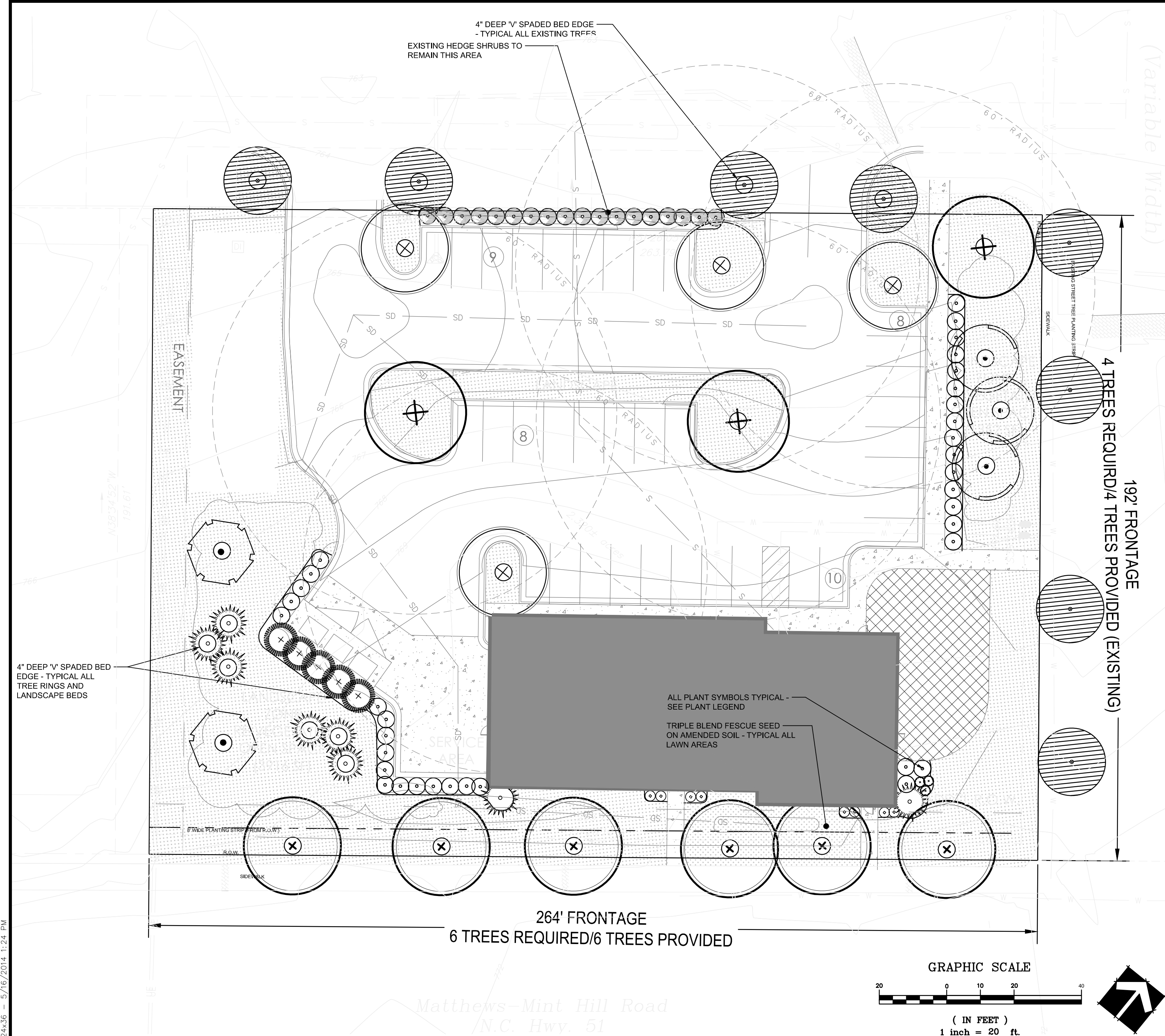

**PLANTING LEGEND**

SYMBOL	TOTAL QTY	SCIENTIFIC NAME	COMMON NAME	INSTALL SIZE	INSTALL STYLE	NOTES
<b>TREES</b>						
CAC	2	<i>Carpinus caroliniana</i>	American Hornbeam	2.5" CAL.	B/B	Full, Dense Crown
LIR	3	<i>Liriodendron tulipifera</i>	Tulip Poplar	2.5" CAL.	B/B	Full, Dense Crown
PSA	3	<i>Prunus sargentii</i>	Sargent Cherry	2.5" CAL.	B/B	Full, Dense Crown
QUB	6	<i>Quercus bicolor</i>	Swamp White Oak	2.5" CAL.	B/B	Full, Dense Crown
ZKG	4	<i>Zelkova serrata</i> 'Green Vase'	Green Vase Zelkova	2.5" CAL.	B/B	Full, Dense Crown
<b>SHRUBS</b>						
ILD	18	<i>Ilex cornuta</i> 'Burfordii Nana'	Dwarf Burford Holly	24" HT./SPR.	Container	Full, Dense
ILD*	17	<i>Ilex cornuta</i> 'Burfordii Nana'	Dwarf Burford Holly	36" HT./SPR.	Container	Full, Dense
INS	8	<i>Ilex x 'Nellie Stevens'</i>	Nellie Stevens Holly	6'HT.	Container	Full, Dense
NAD	8	<i>Nandina domestica</i>	Nandina	24"HT./SPR.	Container	Full, Dense
OSF*	5	<i>Osmanthus x fortunei</i>	Fortunes Osmanthus	36"HT./SPR.	Container	Full, Dense
RRA	3	<i>Rosa 'Radrazz'</i>	Radrazz Knock Out Rose	20" HT./SPR.	Container	Full, Dense
<b>PERENNIAL / GRASSES</b>						
<b>TURF</b>						
SEED		Tri-Blend Fescue Mix	Zoysiagrass		Sod	

\*NOTE: THESE PLANTS INTENDED FOR SCREENING SERVICE AREAS. INSTALL AT THE SPECIFIED INSTALL SIZE AS SHOWN ON PLAN.

DRAWING NAME: C:\GIS\DMW\_Data\2014\05\15\14xxx\_MintHillSVA.DWG - CD\CD\_CADD\Works\_In\_Progress\14xxx-DHMBase.dwg - 24.56 - 5/16/2014 1:24 PM

