

NOTES:

1. TRAIL WIDTH SHALL BE A MINIMUM OF 10' WITHIN A 20' PERMANENT MAINTENANCE EASEMENT. TRAIL MAINTENANCE WILL BE THE RESPONSIBILITY OF THE HOA.
2. TRAIL SHALL BE CLEARED AND GRUBBED OF VEGETATION USING A SKID STEER WITH MAXIMUM BUCKET WIDTH OF 10-FT.
3. CARE SHALL BE TAKEN TO PRESERVE TREES WITH A CALIPER GREATER THAN 4-INCHES (AS MEASURED AT EYE LEVEL). THE TRAIL MAY MEANDOR WITHIN THE PROPOSED 20-FT EASEMENT TO ACCOMMODATE.
4. TRAIL SURFACE TO BE CONSTRUCTED TO TOWN OF MINT HILL RECOMMENDATIONS.
5. TRAIL SHALL HAVE A CROSS SLOPE BETWEEN 0.5% AND 2.0%.

10' GREENWAY TRAIL SECTION

SCALE: N.T.S.

RIGHT-OUT ONLY

COMMON OPEN SPACE (COS) CALCULATIONS:

COS REQUIRED = NUMBER OF BEDROOMS X 500 SF
 LOTS WITH 3 BEDROOM UNITS: 122
 LOTS WITH 4 BEDROOM UNITS: 44
 TOTAL NUMBER OF BEDROOMS: 542
 COS REQUIRED = 542 X 500 SF = 271,000 SF OR 6.22 ACRES

COS PROVIDED:
 DOG PARK: 0.63 ACRES
 MEADOW: 0.57 ACRES
 PARK/GREENWAY: 3.12 ACRES
 LF OF GREENWAY: 3,406 LF X 16 FT = 54,496 SF OR 1.25 ACRES
 GREENWAY: 3.99 ACRES
 TOTAL COS PROVIDED = 9.56 ACRES > 6.22 ACRES, THEREFORE O.K.

BLOCK	BLOCK LENGTH TABLE	DESCRIPTION	LENGTH
STREET A	STREET B TO ALLEY A	288 FT	
STREET A	ALLEY A TO STREET C	110 FT	
STREET A	STREET C TO STREET D	151 FT	
STREET A	STREET D TO ALLEY B	111 FT	
STREET A	ALLEY B TO ALLEY C	627 FT	
STREET A	ALLEY C TO ALLEY D	361 FT	
STREET A	ALLEY D TO STREET B	609 FT	
STREET B	LAWYERS ROAD TO STREET A	133 FT	
STREET B	STREET A TO ALLEY C	644 FT	
STREET B	ALLEY C TO ALLEY D	520 FT	
STREET B	ALLEY D TO ALLEY E	706 FT	
STREET B	ALLEY E TO STREET E	162 FT	
STREET B	STREET E TO STREET F	193 FT	
STREET B	STREET F TO ALLEY F	161 FT	
STREET B	ALLEY F TO STREET A	161 FT	
STREET B	STREET A TO END OF PHASE	145 FT	
STREET C	STREET A TO ALLEY C	624 FT	
STREET D	LAWYERS ROAD TO STREET A	135 FT	
STREET D	STREET A TO ALLEY C	588 FT	
STREET E	ALLEY D TO STREET B	589 FT	
STREET F	ALLEY D TO STREET B	614 FT	
ALLEY A	STREET A TO STREET C	611 FT	
ALLEY B	STREET A TO STREET C	554 FT	
ALLEY C	STREET B TO ALLEY A	138 FT	
ALLEY C	ALLEY A TO STREET C	113 FT	
ALLEY C	STREET C TO STREET D	152 FT	
ALLEY C	STREET D TO ALLEY B	112 FT	
ALLEY C	ALLEY B TO STREET A	368 FT	
ALLEY D	STREET B TO ALLEY E	161 FT	
ALLEY D	ALLEY E TO STREET E	162 FT	
ALLEY D	STREET E TO STREET F	199 FT	
ALLEY D	STREET F TO ALLEY F	162 FT	
ALLEY D	ALLEY F TO STREET A	160 FT	
ALLEY E	ALLEY D TO STREET B	591 FT	
ALLEY F	ALLEY D TO STREET B	617 FT	
CRESTHILL	CRESTHILL TO STREET B	165 FT	
TOTAL		11,897 FT	

POTENTIAL PEDESTRIAN CROSSING
 DEVELOPER TO COORDINATE WITH RON EUBANKS
 AT MECKLENBURG COUNTY WITH REGARD TO
 BUFFER IMPACT AUTHORIZATION REQUIREMENTS

5-FT CONCRETE SIDEWALK AND
 STREET LIGHTS SHALL BE INSTALLED
 ALONG THE ENTIRE WESTERN
 EDGE OF CRESTHILL BY DEVELOPER

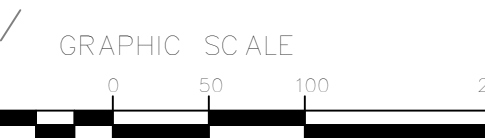
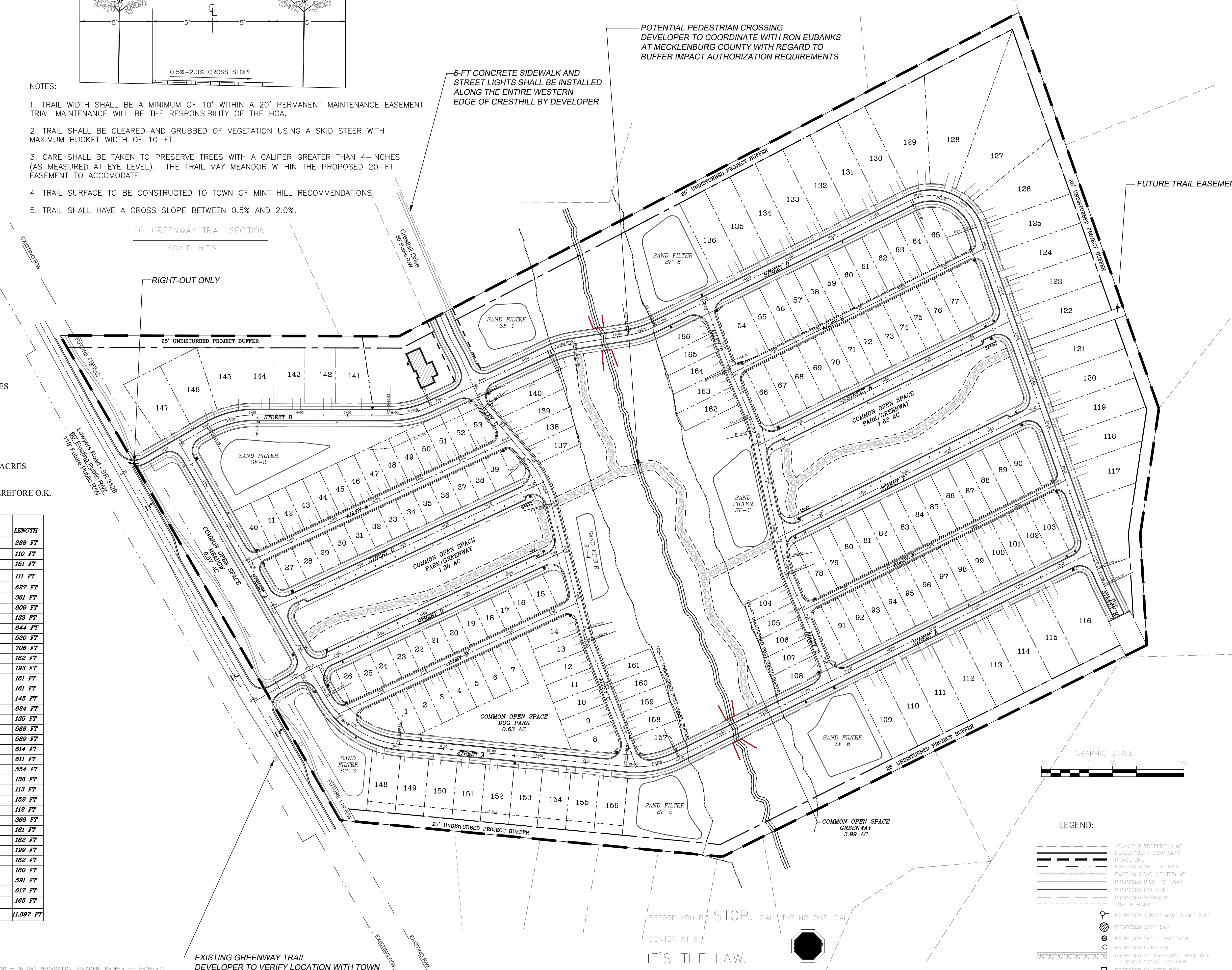

LEGEND:

- ADJACENT PROPERTY LINE
- DEVELOPMENT BOUNDARY
- PHASE LINE
- EXISTING RIGHT-OF-WAY
- EXISTING ROAD CENTERLINE
- PROPOSED RIGHT-OF-WAY
- PROPOSED LOT LINE
- PROPOSED SETBACK
- TOP OF BANK
- PROPOSED STREET NAME/LIGHT POLE
- PROPOSED STOP SIGN
- PROPOSED SPEED LIMIT SIGN
- PROPOSED LIGHT POLE
- PROPOSED 10' GREENWAY TRAIL WITH 20' MAINTENANCE EASEMENT
- PROPOSED CLUSTER BOX
- PROPOSED FIRE HYDRANT

BEFORE YOU DIG STOP. CALL THE NC ONE-CALL
 CENTER AT 811.
 IT'S THE LAW.

EXISTING GREENWAY TRAIL
 DEVELOPER TO VERIFY LOCATION WITH TOWN

COPYRIGHT © 2019, AMICUS ENGINEERING, PLLC.
 ALL RIGHTS RESERVED. REPRODUCTION OR USE OF THE CONTENTS
 OF THIS DOCUMENT, OR ADDITIONS OR DELETIONS TO THIS
 DOCUMENT, IN WHOLE OR IN PART, WITHOUT WRITTEN CONSENT
 OF AMICUS ENGINEERING, IS STRICTLY PROHIBITED. ONLY
 COPIES FROM THE ORIGINAL OF THIS DOCUMENT, AS APPROVED BY
 THE ENGINEER SHALL BE CONSIDERED TO BE VALID. TRUE COPIES.

REFERENCE: ALL PARCEL AND BOUNDARY INFORMATION, ADJACENT PROPERTIES, PROPERTY
 DIMENSIONS, TOPOGRAPHICAL INFORMATION, AND COORDINATES REFERENCED FROM A SURVEY
 COMPLETED BY NORSTAR LAND SURVEYING.



Firm License # P-1191
 331 Coddle Market Drive
 Suite 110
 Concord, NC 28027
 Civil Site Design
 Low Impact Development
 Small-Scale Building Design
 Telephone: 704.573.1621
 Facsimile: 704.248.7951

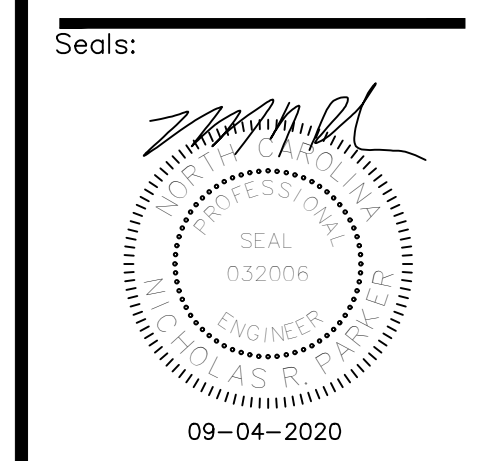

MCEWEN MANOR
 DEVELOPMENT
 MINT HILL, NORTH CAROLINA
 BY
 STREETScape LAND PARTNERS
 10815 SIKES PLACE, SUITE 300
 CHARLOTTE, NC 28277

Project Number: 17.18.082
 Date: 09/04/2020
 Drawn By: EML
 Checked By: NRP

Revisions:	
09/14/18	ORIGINAL SUBMITTAL
05/01/19	PER TOH 4 MECK. COUNTY
07/02/19	PER TOH 4 MECK. COUNTY
03/11/20	PER APPLICANT
09/04/20	PER APPLICANT

Sheet Title:

Site Plan

Sheet No:

C-2.0