

GENERAL NOTES

1. THESE PLANS ARE BASED ON A TOPOGRAPHIC SURVEY CONDUCTED WITH A THREE SECOND TOTAL STATION ON 3/13/17
2. ELEVATION IS BASED ON ASSUMED DATUM
3. COORDINATE SYSTEM IS BASED ON ASSUMED DATUM
4. FOR CLARITY, TEXT DENOTING EXISTING ITEMS IS SHOWN IN LOWER CASE, AND TEXT DENOTING PROPOSED ITEMS IS UPPERCASE AND BOLD.
5. THIS IS NOT A BOUNDARY SURVEY.

CONSTRUCTION NOTES

1. EXISTING BITUMINOUS CONCRETE PAVEMENT TO BE REMOVED AND PROPERLY DISPOSED OFF-SITE.
2. EXISTING BASE MATERIAL TO BE REGRADED TO PROVIDE A SUBBASE A MINIMUM OF 10" BELOW PROPOSED FINISHED GRADE.
3. GRADED SUBGRADE TO BE ROLLED AND COMPACTED.
4. BASE MATERIAL SHALL BE A MINIMUM 6" OF COMPACTED CRUSHED GRAVEL.
5. TOP COURSE PAVING SHALL BE PLACED WITHIN 24 HOURS OF BASE COURSE.
6. COURT STRIPING SHALL BE COMPLETED PER MANUFACTURERS RECOMMENDATIONS.

SAFETY NOTES

1. CONTRACTOR SHALL BE RESPONSIBLE FOR INITIATING, MAINTAINING AND SUPERVISING ALL WORK SAFETY PRECAUTIONS AND PROGRAMS IN CONNECTION WITH THE WORK. CONTRACTOR SHALL TAKE ALL NECESSARY PRECAUTIONS TO PREVENT DAMAGE, INJURY OR LOSS TO:
 - A. ALL EMPLOYEES ON THE WORK SITE AND OTHER PERSONS WHO MAY BE AFFECTED.
 - B. THE WORK SITE AND ALL THE MATERIALS AND EQUIPMENT TO BE INCORPORATED WHETHER IN STORAGE ON OR OFF THE SITE.
 - C. OTHER PROPERTY AT THE SITE OR ADJACENT, INCLUDING BUT NOT LIMITED TO RESIDENTS, FARMS, MILLS, FARMERS, ROADS, STRUCTURES AND UTILITIES NOT DESIGNATED FOR REMOVAL, RELINQUISH OR REDEMPTION IN THE COURSE OF CONSTRUCTION.
2. CONTRACTOR SHALL COMPLY WITH ALL APPLICABLE LAWS, ORDINANCES, RULES, REGULATIONS AND ORDERS (INCLUDING O.S.H.A. REGULATIONS) OF ANY PUBLIC BODY HAVING JURISDICTION OVER THE SAFETY OF PERSONS OR PROPERTY.
3. THE CONTRACTOR SHALL NOTIFY OWNERS OF ADJACENT PROPERTY AND UTILITIES WHEN EXECUTION OF THE WORK WILL AFFECT THEM.
4. THE CONTRACTOR'S DUTIES AND RESPONSIBILITIES FOR THE SAFETY AND PROTECTION OF THE WORK SHALL CONTINUE UNTIL SUCH TIME AS ALL THE WORK IS COMPLETED.
5. CONTRACTOR SHALL COORDINATE WITH DGS-SAFE (888)-344-7233 OR WWW.DGSAFE.COM A MINIMUM OF 48 HOURS PRIOR TO PERFORMING ANY EXCAVATION.

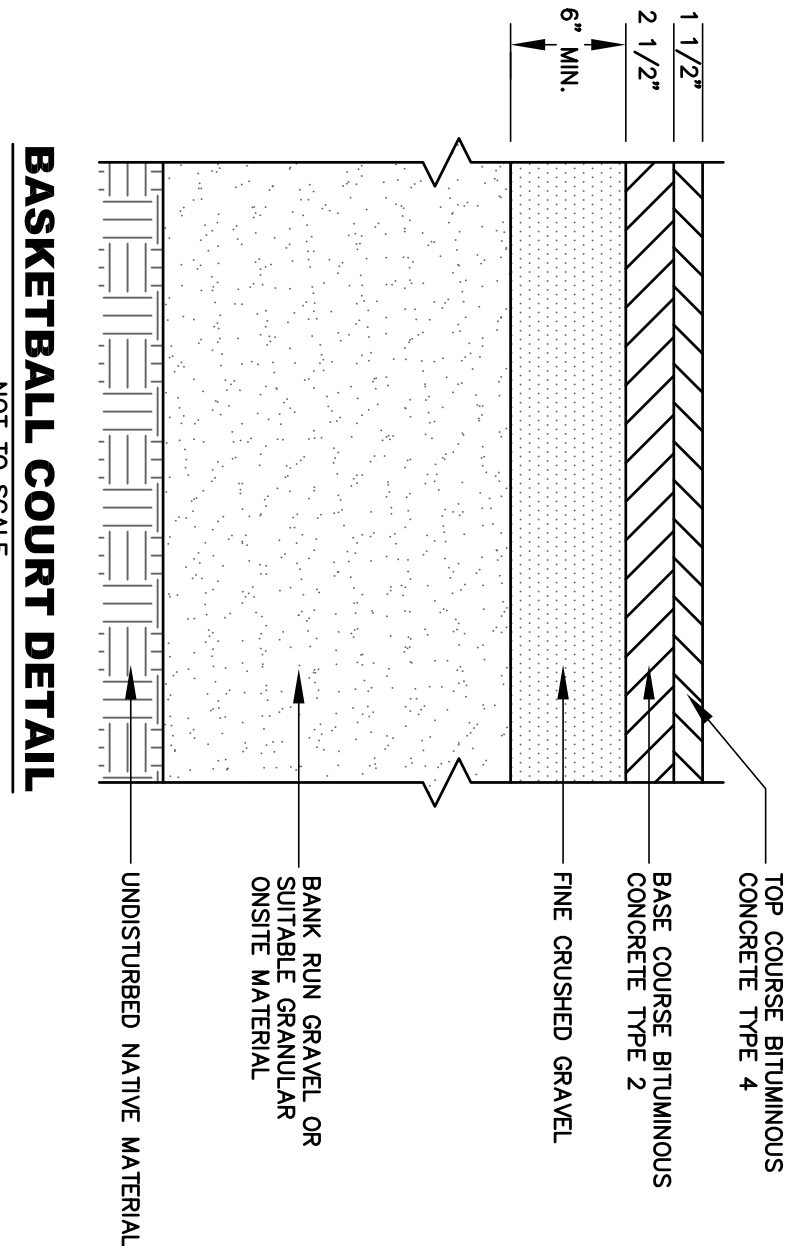

BASKETBALL COURT DETAIL
NOT TO SCALE

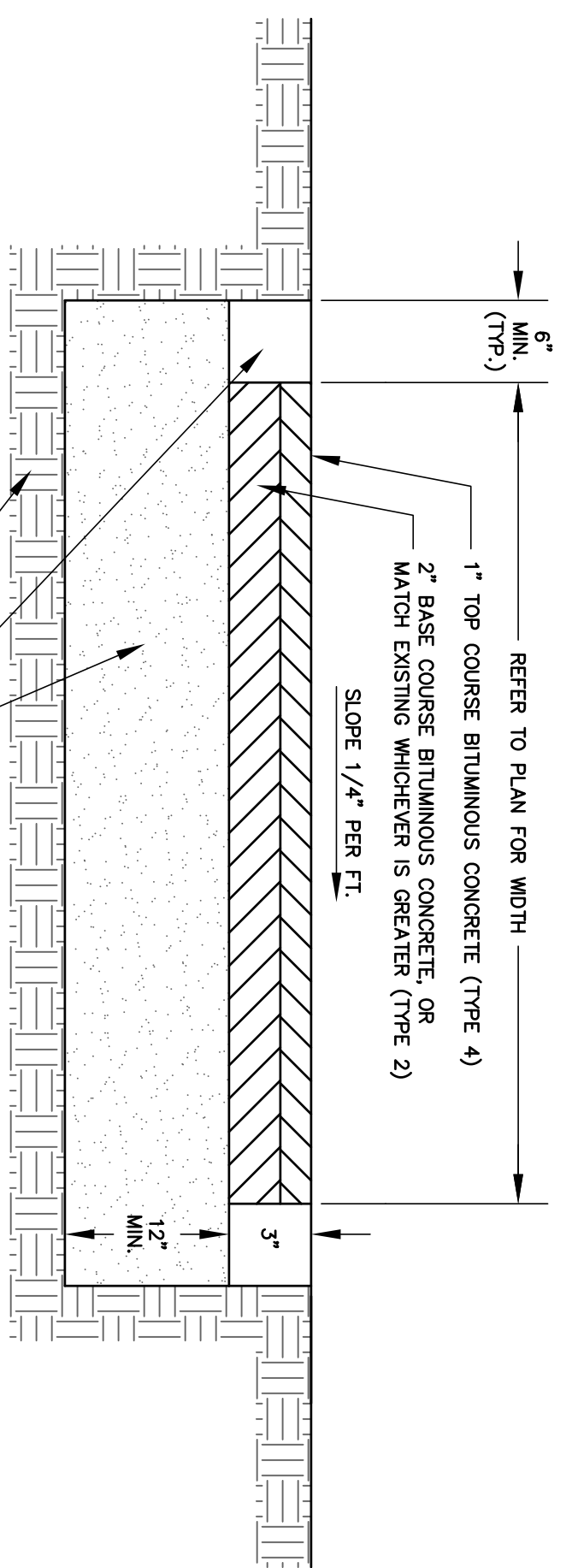

BITUMINOUS CONCRETE SIDEWALK DETAIL
NOT TO SCALE

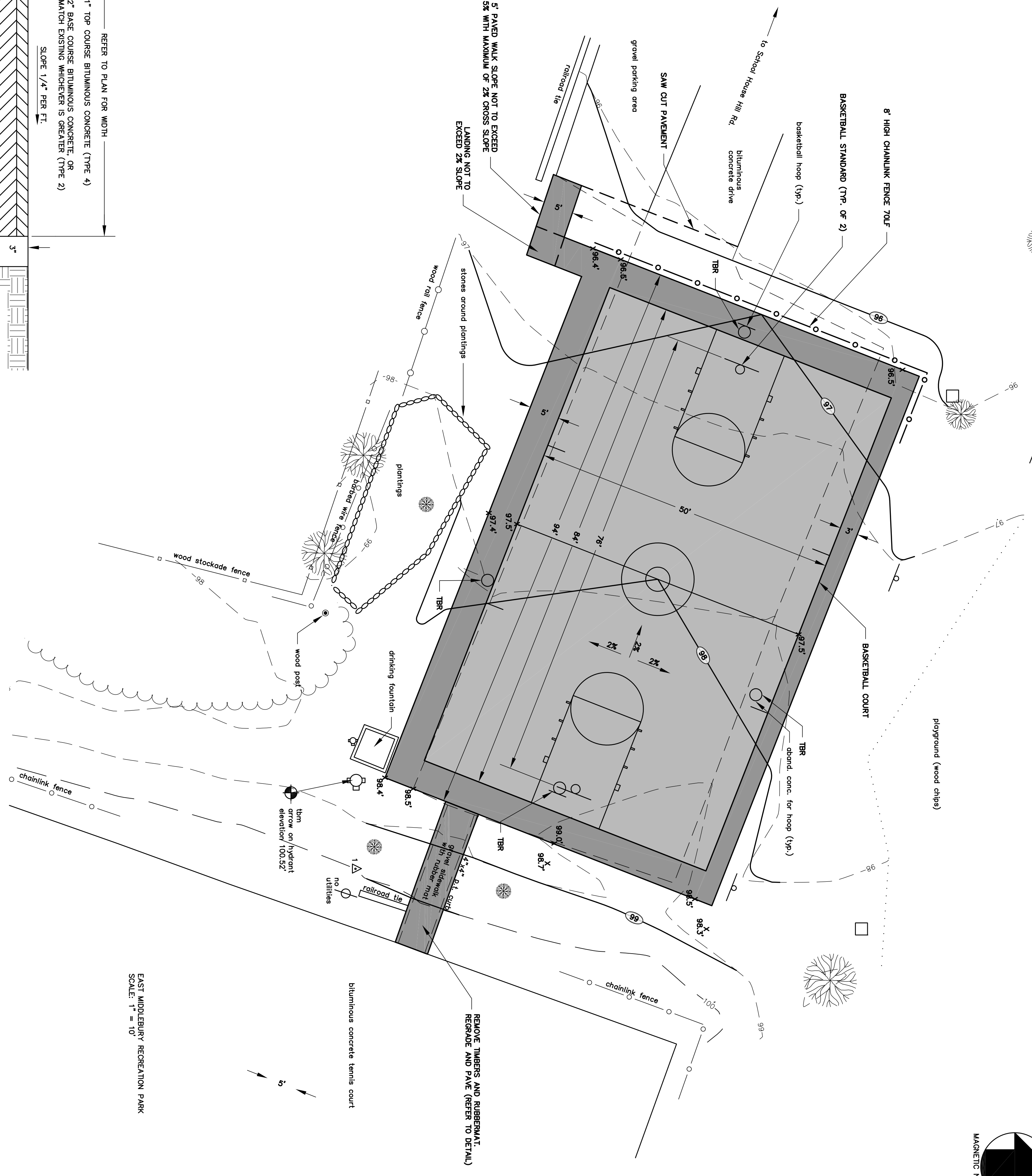

EAST MIDDLEBURY RECREATION PARK
SCALE: 1" = 10'

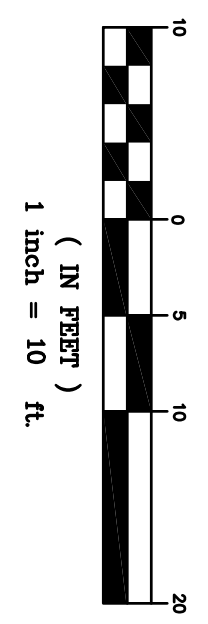

EAST MIDDLEBURY RECREATION PARK
HAROLD CURTIS PARK
BASKETBALL COURT REPLACEMENT
EAST MIDDLEBURY, VERMONT

Scale:	1" = 10'
Date:	3/27/18
Drawing number:	1