

Middlebury Fire Department
Engine Replacement Committee
Summary of Work

In November 2019, Chief David Shaw appointed a committee to develop specifications for a new truck to replace Engine 1. Engine 1 was purchased in 1996 at a cost of \$ 219,000.00 was the first piece of apparatus paid for through the fire equipment fund. Engine 1, which is older than the National Fire Protection Association recommendation of 20 years, will be retired and the new engine will become the department's primary engine, responding as the first-due apparatus for nearly in-town every call; the new engine will become the primary engine. The current Engine 3 will become a secondary engine housed at Station 2 in East Middlebury, while Engine 2 will move from Station 2 to Engine 1 to become the primary mutual aid engine.

The Engine Replacement Committee is chaired by Captain Tim Porter and includes Captains Jeff Carpenter and LeRoy Graham, Lieutenant Donald Patterson, and Chief Shaw serves on the committee *ex officio*. Once convened, the committee generated a list of nearly 100 requirements for the new truck. For each requirement, the committee assigned it a value of 1 to 3 to signify the criticality of the need, with 3 being essential as stated, 2 required but could be fulfilled by an appropriate substitution, and 1 nice to have but not essential.

The committee contacted 10 fire apparatus dealers in the Northeast representing 13 manufacturers¹ asking them if they were interested in submitting a proposal to meet those requirements. The committee had active interest from six of the dealers and met with five of them, looking at demonstration or actual trucks from four dealers.

The committee received four completed proposals: Lakes Region Fire Apparatus, Inc. for HME Ahrens-Fox; New England Fire Equipment & Apparatus for Smeal; New England Rosenbauer Direct for Rosenbauer; and Shakerley Fire Truck Sales/VRS Sales for Toyne. The committee reviewed each proposal and worked with dealers to clarify requirements and items included in the proposals, and ultimately, the committee recorded in the scoring sheet the degree to which each dealer met the stated requirements, using the 1-3 scoring mechanism noted above.

In late July 2020, the committee asked the four dealers to submit last and final specifications and pricing. The committee received last and final responses from three dealers: Lakes Region Fire Apparatus, Inc.; New England Rosenbauer Direct; and Shakerley Fire Truck Sales/VRS Sales. In mid-August, the committee will conduct a final line-by-line review of the last and final specifications against the scoring rubric and will make a recommendation for the new engine at the August 25, 2020 Selectboard meeting. The department is planning for a late summer-early autumn 2021 delivery.

¹ Adirondack EVG, Inc. (BME and Ferrara Fire Apparatus); Bull Dog Fire Apparatus (KME); Desourcie Emergency Products, LLC (E-One); Dingee Machine (Sutphen); Fleetmasters, Inc. (Seagrave); Lakes Region Fire Apparatus, Inc. (Alexis and HME Ahrens-Fox); Minuteman Trucks, Inc. (Pierce); New England Fire Equipment & Apparatus (Smeal and Spartan); New England Rosenbauer Direct (Rosenbauer); Shakerley Fire Truck Sales/VRS Sales (Toyne)

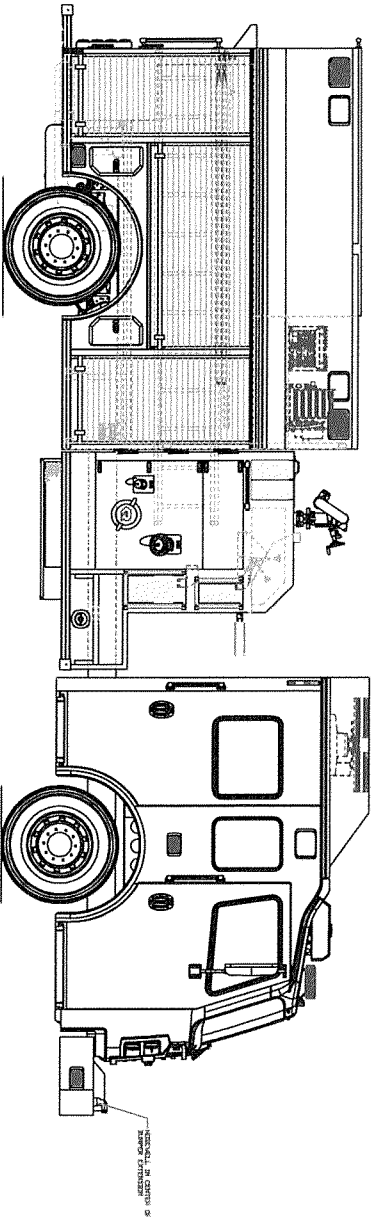
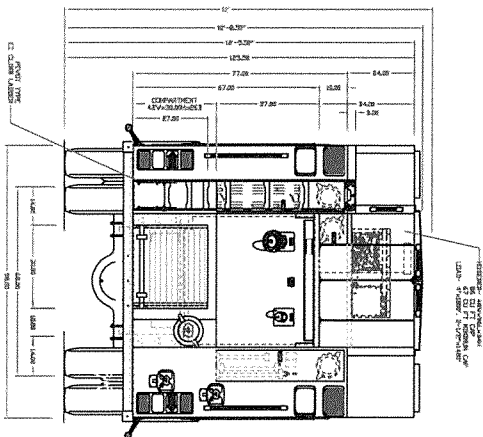
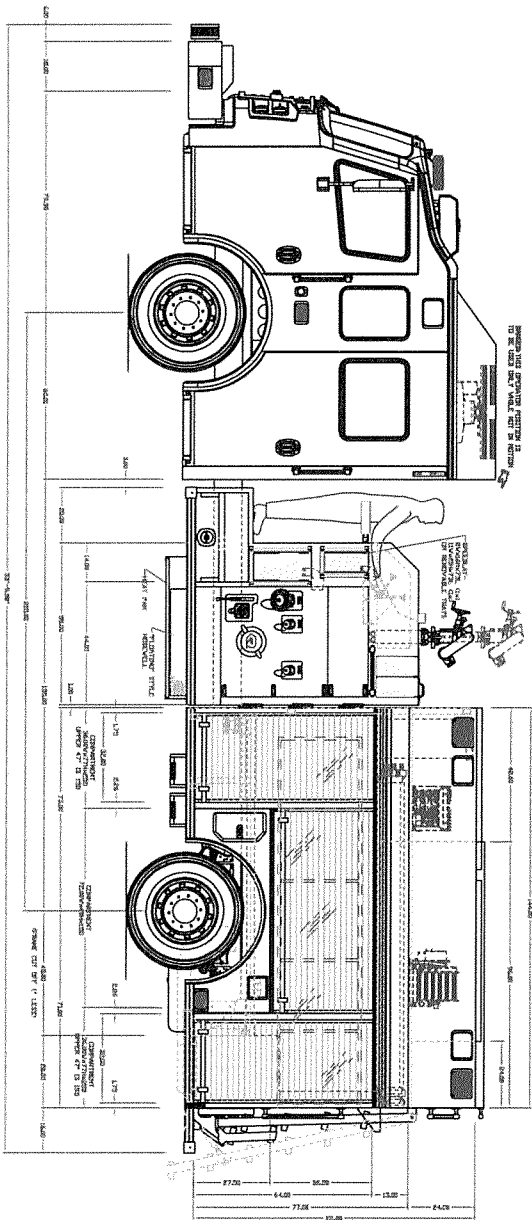

- NOTES:
1. Overall height is in loaded condition. Unloaded heights may be 4" above heights shown.
 2. Do not scale drawing.
 3. All dimensions are approximate and subject to engineering changes.
 4. Drawing may or may not show all detail specifications.
 5. Inclusion of an item on the drawing does not constitute a contract unless shown with the final delivered unit.
 6. The ejective door openings will be compartment opening for roll up doors and up to approx. 4" less for hinged doors.

APPROVED BY:

REVISION	DATE	DATE	DATE
1	05-10-85	04-27-85	04-27-85
<p>PROPRIETARY AND CONFIDENTIAL THE INFORMATION CONTAINED IN THIS DRAWING IS THE PROPERTY OF ROSENBAUER. IT IS TO BE KEPT IN CONFIDENTIALITY AND NOT TO BE REPRODUCED OR TRANSMITTED IN ANY FORM OR BY ANY MEANS, ELECTRONIC OR MECHANICAL, INCLUDING PHOTOCOPYING, RECORDING, OR BY ANY INFORMATION STORAGE AND RETRIEVAL SYSTEM, WITHOUT THE WRITTEN PERMISSION OF ROSENBAUER.</p>			
<p>MAXIMUM HEIGHT NONE</p> <p>MAXIMUM LENGTH NONE</p> <p>BODY WIDTH 98"</p>			
<p>PANEL MTL. LINE X</p> <p>COMP. INTERIOR. NATURAL FINISH</p>			
<p>CHASSIS: COMMANDER 8011</p>			
<p>PUMP: WATEROUS 1250 GPM</p>			
<p>TANK: POLY/1000</p>			
<p>ROSENBAUER CRT S/S</p>			

MIDDLEBURY
F.D., VT



Middlebury, VT

(Rosenbauer)