

X:\CADD\Virginia\Dominion\Civil\Branch\Civil\CP Plans\Rev01\194-1058-002SCP200.dwg

NOTES:

1. LIDAR OBTAINED FROM VGIN VIRGINIA LIDAR INVENTORY WEB MAPPING. SUBJECT AND ADJOINING PROPERTY LINES ARE SOURCED FROM [HTTPS://VGIN.ARCGIS.COM/APPS/VIEWER/INDEX/HTML](https://vgin.arcgis.com/apps/viewer/index/html).
2. IMAGERY OBTAINED FROM [HTTPS://VGIN.MAPS.ARCGIS.COM/APPS/VIEWER/INDEX.HTML](https://vgin.maps.arcgis.com/apps/viewer/index.html).
3. AQUATIC RESOURCES (I.E., STREAMS AND WETLANDS) AS SHOWN WERE ESTIMATED/OBTAINED VIA DESKTOP REVIEW. FIELD DELINEATIONS OF AQUATIC RESOURCES WILL BE COMPLETED AT A LATER DATE PRIOR TO FINAL DESIGN.
4. UTILITY LOCATIONS AS SHOWN WERE OBTAINED VIA DESKTOP REVIEW AND, THEREFORE, ARE APPROXIMATE. FIELD SURVEY IS REQUIRED IN ORDER TO OBTAIN EXACT LOCATIONS.
5. VA MISS TICKET NUMBER REQUESTS FOR EXISTING UTILITIES: A115300587-00A, A115203624-00A, B115202062-00B
6. FLOODPLAIN DATA OBTAINED FROM [HTTPS://HAZARDS-FEMA.MAPS.ARCGIS.COM/APPS/WEBAPPVIEWER/INDEX.HTML?ID=8B0ADB5199644D48793338B5529A9ACD](https://hazards-fema.maps.arcgis.com/apps/webappviewer/index.html?id=8b0adb5199644d48793338b5529a9acd)
7. A SETBACK OF 400 FEET FROM RESIDENTIAL (NON-PARTICIPATING) STRUCTURES BASED ON LUNENBURG COUNTY ORDINANCE FOR SOLAR ENERGY FACILITIES, ADOPTED 09 SEPT 2021. A SETBACK OF 200 FEET ADJOINING OR ABUTTING PUBLIC RIGHT OF WAY BASED ON LUNENBURG COUNTY ORDINANCE FOR SOLAR ENERGY FACILITIES, ADOPTED 09 SEPT 2021. A MINIMUM SETBACK OF 100 FEET NON-DISTURBANCE DISTANCE FROM ALL IDENTIFIED CULTURAL RESOURCES BASED ON LUNENBURG COUNTY ORDINANCE FOR SOLAR ENERGY FACILITIES, ADOPTED 09 SEPT 2021.
8. PROPOSED SOLAR ARRAY LAYOUTS AS SHOWN WERE DEVELOPED BASED ON EXISTING CONTOURS, ASSUMED ZONING/ORDINANCE SETBACK REQUIREMENTS, AND EXISTING CONSTRAINTS (E.G., STREAMS, WETLANDS, UTILITIES, ETC.) THAT WERE OBTAINED VIA DESKTOP REVIEW. ENHANCEMENTS TO THE PROPOSED SOLAR ARRAY LAYOUTS RESULTING FROM PROPOSED GRADING HAVE ALSO BEEN CONSIDERED.
9. LAYDOWN APPURTENANCES WILL HAVE HEIGHTS RANGING FROM 16' TO 65'+ MASTS. INVERTERS WITHIN THE ARRAYS WILL BE APPROXIMATELY 10' TALL.
10. LAYDOWN YARDS ARE TYPICALLY DIMENSIONED 350' BY 55' AS SHOWN ON THE DRAWINGS. THE LAYOUT AND CONFIGURATION OF THE LAYDOWN YARDS' APPURTENANCES SUCH AS CONSTRUCTION TRAILERS, PARKING LAYOUT, PORTA JOHNS, DUMPSTERS, MATERIAL STORAGE AND DROP-OFF ETC. WILL BE DETERMINED DURING CONSTRUCTION LEVEL PLANS.
11. ENTRANCE RADII HAVE BEEN GENERALLY EVALUATED USING A STANDARD 53 FOOT TRACTOR-TRAILER (AASHTO WB-67). THE RADII SHOWN ARE 60' AND MAY BE SUBJECT TO CHANGE BASED ON DETAILED STUDIES AND CONSTRUCTION LEVEL DRAWINGS.
12. SUBSTATION APPURTENANCES WILL HAVE HEIGHTS RANGING FROM 16' TO 65'+ MASTS. INVERTERS WITHIN THE ARRAYS WILL BE APPROXIMATELY 10' TALL.
13. MEDIUM VOLTAGE ROUTING DEMONSTRATES AREAS WHICH MAY EXPERIENCE TRENCHING BUT IS NOT REPRESENTATIVE OF FINAL CIRCUIT ROUTING OR CONDUCTOR COUNTS.
14. ALL EXISTING RESIDENTIAL STRUCTURES WILL RETAIN A 400' BUFFER. NON-RESIDENTIAL STRUCTURES WILL RETAIN A 30' BUFFER, ALL STRUCTURES ARE SUBJECT TO THESE BUFFERS UNLESS OTHERWISE AGREED UPON WITH RESPECTIVE LANDOWNERS. STRUCTURE(S) TO BE DEMOLISHED ARE STILL BEING DETERMINED AND LANDOWNER APPROVAL WILL BE OBTAINED PRIOR TO DEMOLITION.

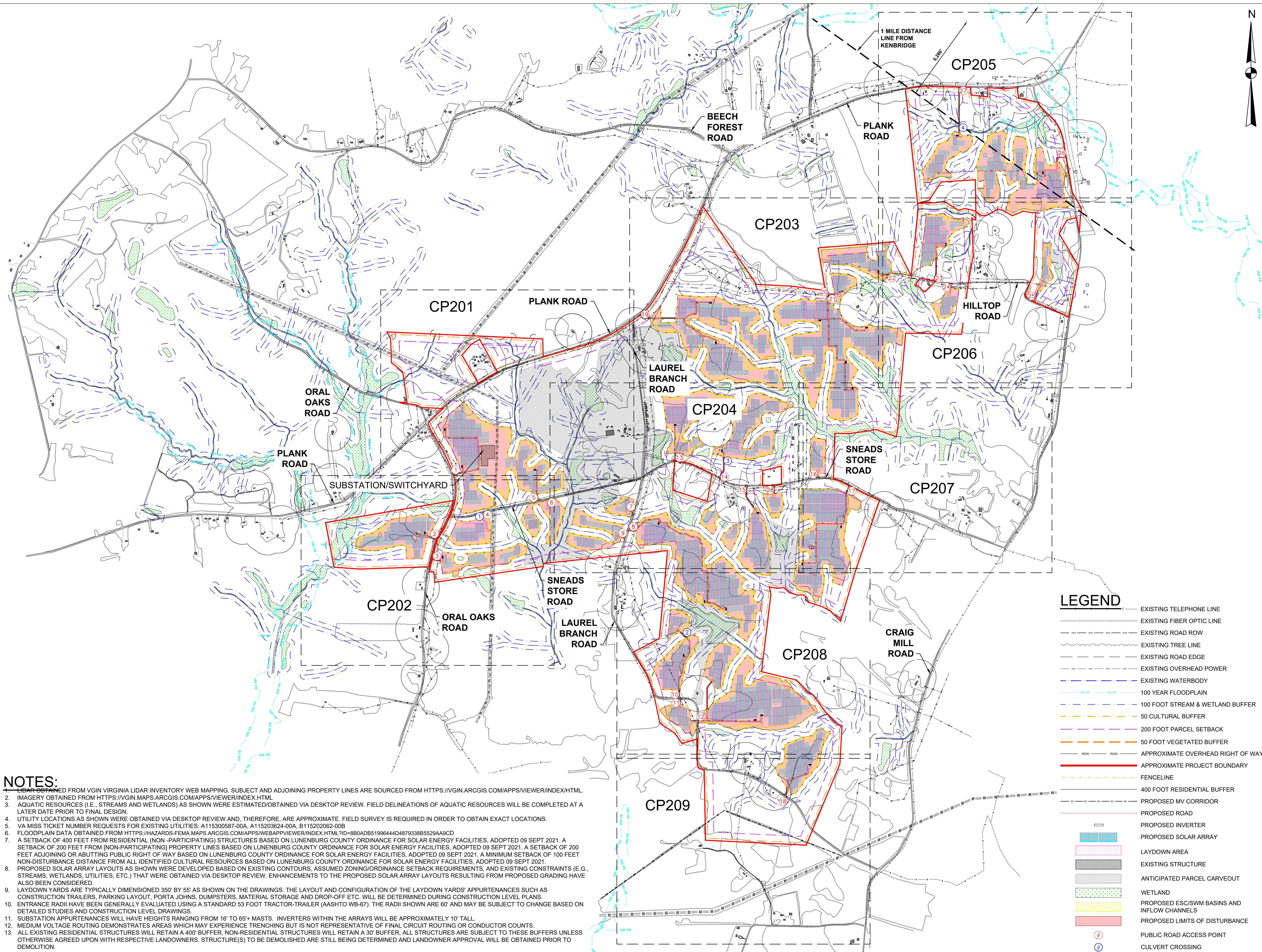

TETRA TECH, INC.
4101 COX ROAD,
SUITE 120
GLEN ALLEN, VA 23060
TEL: (804) 290-4321
FAX: (804) 270-2739

STAMP:



LAUREL BRANCH SOLAR PROJECT

DOMINION ENERGY VIRGINIA LUNENBURG COUNTY VIRGINIA

PROJECT NUMBERS:
194-1058-0025

SHEET TITLE:
POST-DEVELOPMENT
CONDITIONS
INDEX SHEET

SHEET SIZE: ARCH "D"
24" X 36" (610 x 914)
0 1/2" 1"

THIS DOCUMENT IS THE PROPERTY OF TETRA TECH WHO HAS UNLIMITED RIGHTS. THIS DOCUMENT IS PROVIDED UPON CONDITION THAT IT WILL NEITHER BE REPRODUCED, COPIED, OR ISSUED TO A THIRD PARTY AND WILL BE USED SOLELY FOR THE ORIGINAL INTENDED PURPOSE.

NO.	REVISION	DATE	INIT.
00	CUP APPLICATION	05/17/2022	GAR
01	CUP APPLICATION	09/2/2022	GAR



DATE:	09/2/2022
DRAWN BY:	GR
ENGINEER:	MS
APPROVED BY:	EO

PROJECT PHASE:
CONDITIONAL USE PERMIT SITE PLANS

SCALE:
1" = 800'

SHEET NO.:

CP200