

# CERTIFICATE OF LOCATION OF GOVERNMENT CORNER

East quarter Corner of Section 15, Township 40, Range 23, 4<sup>TH</sup> P.M.

STATE OF MINNESOTA, County of KANABEC

At the corner location shown on the sketch:  
*found 1/2 inch iron pipe on E and fence to east.*

Kanabec County U.S. Survey Feet Coordinates  
 NAD 1983, HARN 1996 Adjustment  
 Obtained by RTK GPS Observation

Northing= 182368.99

Easting= 427682.14

Note: NAD 1983, HARN 1996 Adjustment coordinates are NOT compatible with NAD 1983 coordinates

Note: 1 Meter=3937/1200 U.S. Survey Feet

## SKETCH OF REFERENCE TIES

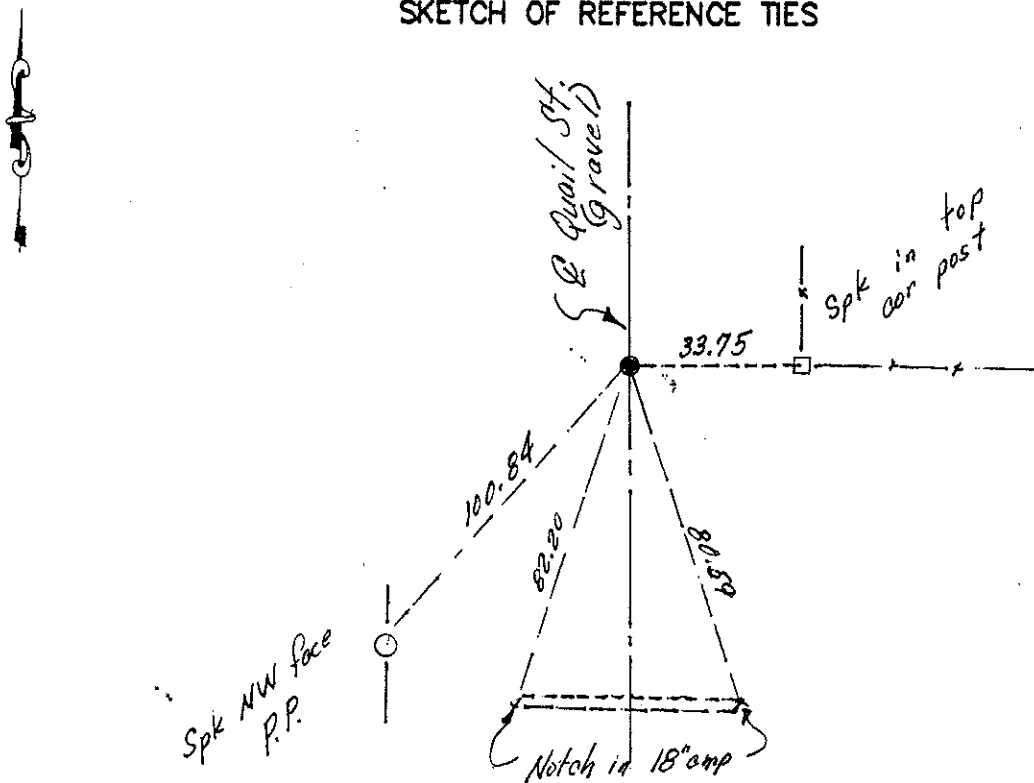

Statement of evidence relative to this corner location is on back of page.

I hereby certify that this document and the data contained herein was prepared by me or under my direct supervision.

*Ernest J. Red*  
 Signature

1-1-13  
 Date

Registration No. 9808

Land Surveyor,  Professional Engineer

County Surveyor,  County Engineer

## OFFICE OF THE COUNTY RECORDER

County of \_\_\_\_\_

I hereby certify that this document was filed in the County Recorder's office at \_\_\_\_\_ M. on the

\_\_\_\_\_ day of \_\_\_\_\_ A.D., 20\_\_\_\_

County Recorder \_\_\_\_\_

BY \_\_\_\_\_ Deputy

DOCUMENT NO. \_\_\_\_\_

The original Government post was set by Deputy Surveyor John M Gley in September 1851 and 2 bearing trees were noted as:

5" Tamarack bearing South 35° West at 10 links

4" Tamarack bearing North 50° East at 11 links

No visible evidence remains today for the post or its accessories.

This corner falls in the centerline of Quail Street running north to south and an old fence running to the east. At this location we found a ½" iron pipe that fit within 1 ½ feet from a split between northeast and southeast corners of section 15. We accepted this monument to be the best evidence for the perpetuation of this corner. Ties were taken and Kanabec County coordinates established on this position.