

CERTIFICATE OF LOCATION OF GOVERNMENT CORNER

N. W. Corner of Section 26, Township 40, Range 23, 4TH P.M.

STATE OF MINNESOTA, County of KANABEC

At the corner location shown on the sketch

On 9 - 24 - 82 found a 2" IRON PIPE
Date

left monument as found, [] lowered monument, [] removed monument (explain)

On 9 - 24 - 82 placed a 4" x 17" C.I.M. ON TOP
Date

SKETCH OF REFERENCE TIES

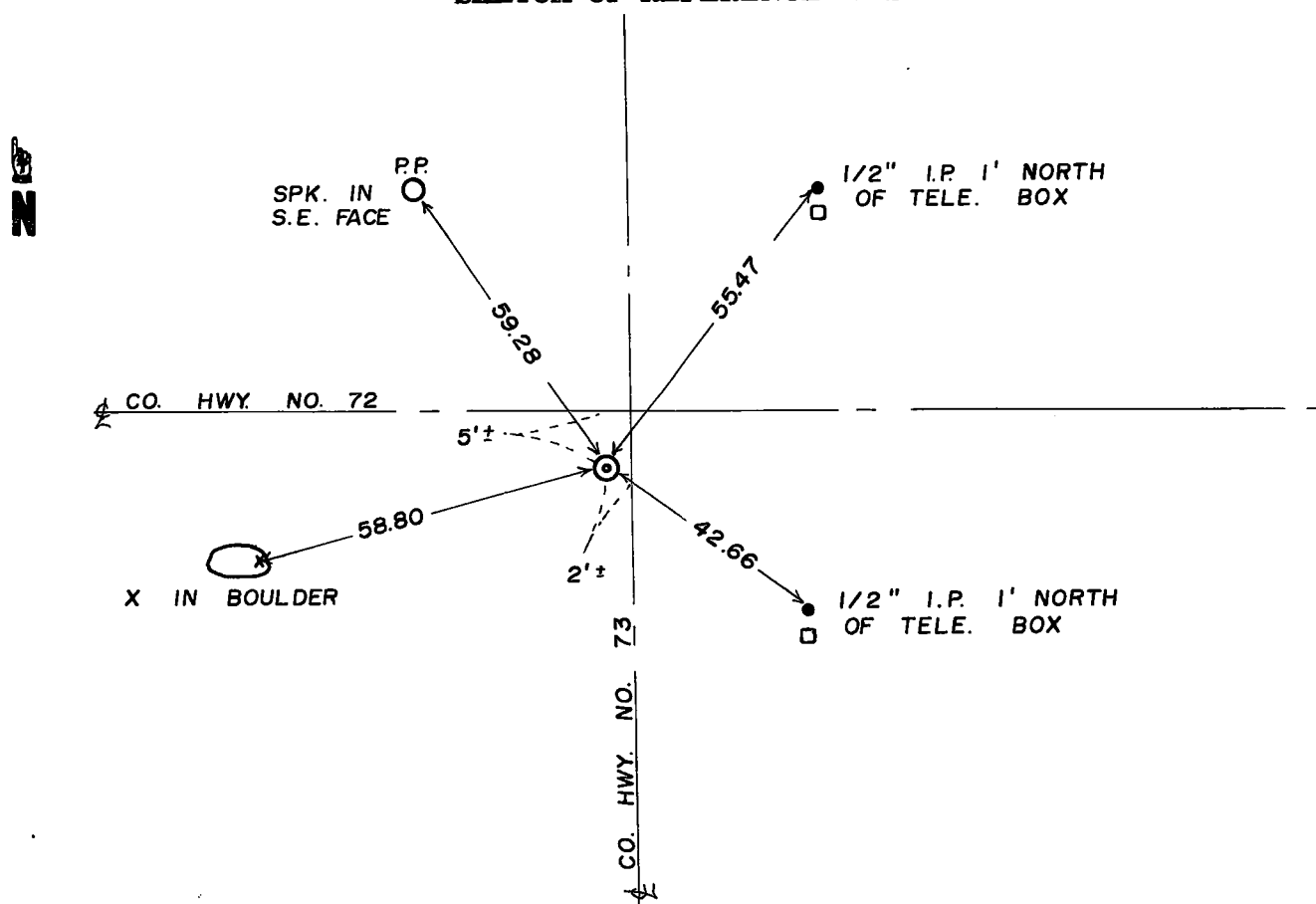

42/23

Statement of evidence relative to this corner location is on back of page.

I hereby certify that this document and the data contained herein was prepared by me or under my direct supervision.

M. D. Paul Signature 10-6-82 Date

Registration No. 8195

Land Surveyor, [] Professional Engineer

County Surveyor, [] County Engineer

County Recorder
OFFICE OF THE REGISTER OF DEEDS

County of Kanabec

I hereby certify that this document was filed in the Register of Deeds office at 10:45 A.M. on the 20 day of October A.D., 1982

County Recorder Velma J. Besser
Register of Deeds

By _____, Deputy

DOCUMENT NO. _____

STATEMENT OF EVIDENCE

All of the original bearing trees are now gone.

In 1929, Charles Handschu, a Land Surveyor, found a sandstone marked with an "+" that was broken and drove a 2" iron pipe into the center of the broken sandstone.

In 1936, a Certificate of Government Corner was filed for this corner which shows an iron pin - Certificate No. 151.

This corner is at the intersection of roads north-south-east and west.

On September 24, 1982, we made an excavation with the County backhoe and at 1.5 feet below the surface we found a 2" iron pipe per Handschu's record. We lowered the 2" iron pipe and set a 4" by 17" cast iron monument on top of the 2" iron pipe.