

CERTIFICATE OF LOCATION OF GOVERNMENT CORNER

NORTH QUARTER Corner of Section 13, Township 40, Range 23, 4TH P.M.

STATE OF MINNESOTA, County of KANABEC

At the corner location shown on the sketch:

FOUND SANDSTONE
AND ESTABLISHED G.P.S. COORDINATES ON ITS LOCATION.

Kanabec County U.S. Survey Feet Coordinates
NAD 1983, HARN 1996 Adjustment
Obtained by RTK GPS Observation

Northing= 184996.46

Easting= 435618.25

Note: NAD 1983, HARN 1996 Adjustment
coordinates are NOT compatible with
NAD 1983 coordinates

Note: 1 Meter=3937/1200 U.S. Survey Feet

SKETCH OF REFERENCE TIES

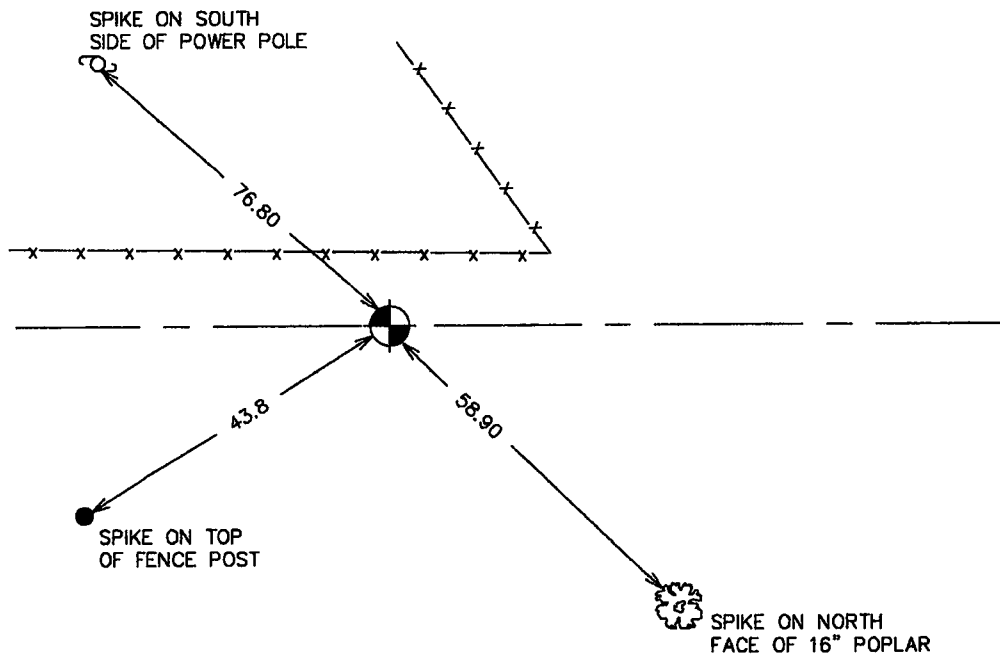

Statement of evidence relative to this corner location is on back of page.

I hereby certify that this document and the data contained herein was prepared by me or under my direct supervision.

Signature Date
Registration No. _____

Land Surveyor, Professional Engineer

County Surveyor, County Engineer

OFFICE OF THE COUNTY RECORDER

County of Kanabec

I hereby certify that this document was filed in the County Recorder's office at 8:00 A.M. on the

13th day of Sept A.D., 2006

County Recorder Rhonda Olson

BY _____ Deputy

DOCUMENT NO. _____

NORTH QUARTER CORNER SECTION 13, T40, R23

STATEMENT OF EVIDENCE

THE NORTH 1/4 CORNER OF SECTION 13 WAS SET BY DEPUTY SURVEYOR, JOHN M. GLEY IN SEPTEMBER 1851. THE ORIGINAL CORNER AND BEARING TREES NO LONGER REMAIN.

RECORDS OF ANY SUBSEQUENT SURVEYS COULD NOT BE FOUND AT THE KANABEC COUNTY COURT HOUSE.

IN JUNE 2006, E.G. RUD AND SONS RAN A SURVEY AROUND SECTIONS 1, 2, 11, AND 12 TO LOCATE EXISTING MONUMENTATION AND LINES OF OCCUPATION. THIS CORNER FALLS ON THE CENTERLINE OF AN EAST-WEST TOWNSHIP ROAD. LAND OWNERSHIP ON THE NORTH AND SOUTH SIDES OF THIS CORNER RUNS INTO BOTH QUARTER SECTIONS.

ON JULY 25, 2006 AN EXCAVATION WAS MADE ON THE CENTERLINE OF THE ROAD AND EQUIDISTANT FROM THE NORTHEAST AND NORTHWEST CORNERS OF SECTION 13.

AT 14" DOWN A 12" SQUARE SANDSTONE WAS FOUND. THIS SANDSTONE WAS 0.5' SOUTH AND 2.18 FEET EAST OF LINE AND SPLIT. THIS SANDSTONE WAS ACCEPTED AS THE PERPETUATED LOCATION FOR THIS CORNER. TIES WERE TAKEN AND KANABEC COUNTY COORDINATES WERE ESTABLISHED USING G.P.S. EQUIPMENT.