

Index No. ~~302003~~ AND 4023044

CERTIFICATE OF LOCATION OF GOVERNMENT CORNER

NORTH QUARTER Corner of Section 3, Township 39, Range 23, 4TH P.M.

STATE OF MINNESOTA, County of KANABEC

At the corner location shown on the sketch:
On 10/ /2003 Found a Kanabec County Monument.

Kanabec County U.S. Survey Feet Coordinates
NAD 1983, HARN 1996 Adjustment
Obtained by RTK GPS Observation

Northing= 163845.080

Easting= 425141.359

Note: NAD 1983, HARN 1996 Adjustment
coordinates are NOT compatible with
NAD 1983 coordinates

Note: 1 Meter=3937/1200 U.S. Survey Feet

SKETCH OF REFERENCE TIES

from tie sheet 834

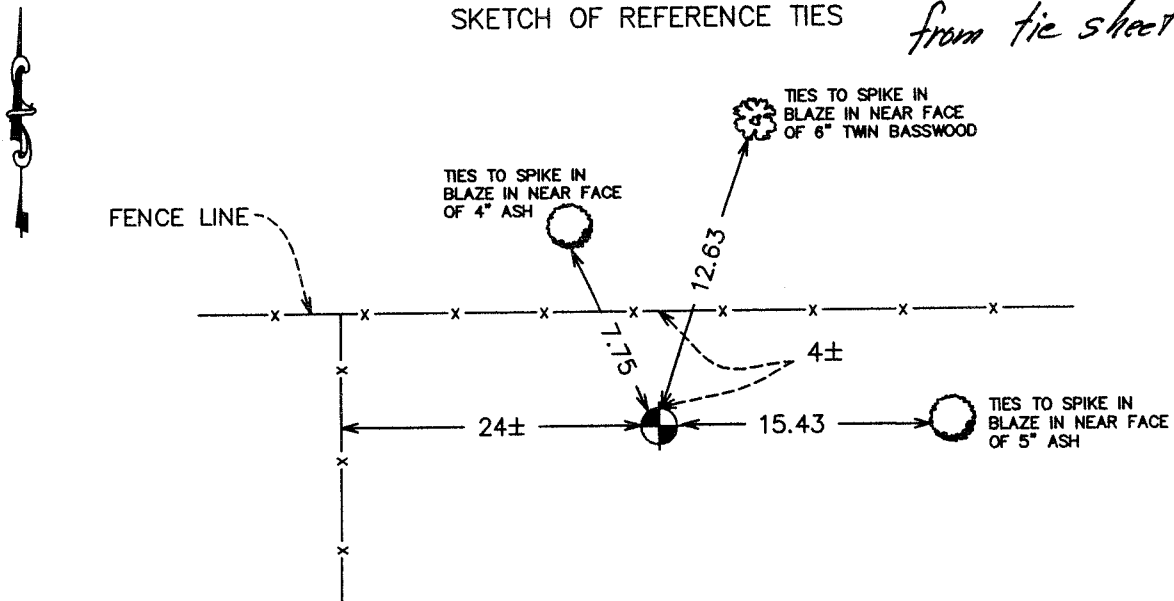

Statement of evidence relative to this corner location is on back of page.

I hereby certify that this document and the data contained herein was prepared by me or under my direct supervision.

Ernest Alud
Signature

5-19-2004
Date

Registration No. 9808

OFFICE OF THE COUNTY RECORDER

County of _____

I hereby certify that this document was filed in the County Recorder's office at _____ M. on the

_____ day of _____ A.D., 20____

County Recorder

STATEMENT OF EVIDENCE
(FROM TIE SHEET 834) (1990)

All of the original government bearing trees are now gone.

In 1910, the former County Surveyor, John Nelson, made a survey along the south line of Section 34, Township 40, Range 23, and set a sandstone marked with a "+", at the south quarter corner of Section 34, Township 40, Range 23.

On June 26, 1990, we made a survey around Section 34, Township 40, Range 23, to locate existing monuments, lines of occupation and search areas.

On June 29, 1990, we made a search by probing and excavating with a backhoe as much as possible and found nothing.

John Nelson set this corner by single proportional measurement between southeast and southwest corners of Section 34 in 1911.

We reset this corner by single proportional measurement between the southeast and southwest corners of section 34.

(2003)

In October of 2003, we did a survey around Section 2 and Section 3 and found this monument. We established Kanabec County coordinates on the corner using G.P.S. equipment.