

CERTIFICATE OF LOCATION OF GOVERNMENT CORNER

Northwest Corner of Section 4, Township 40, Range 23, 4 P.M.

STATE OF MINNESOTA, County of Kanabec

At the corner location shown on the sketch:

On 10-4-74 found a old axle hub per Certificate No. 178
DATE

left monument as found, lowered monument, removed monument (explain)

On _____ placed a _____
DATE

SKETCH OF REFERENCE TIES

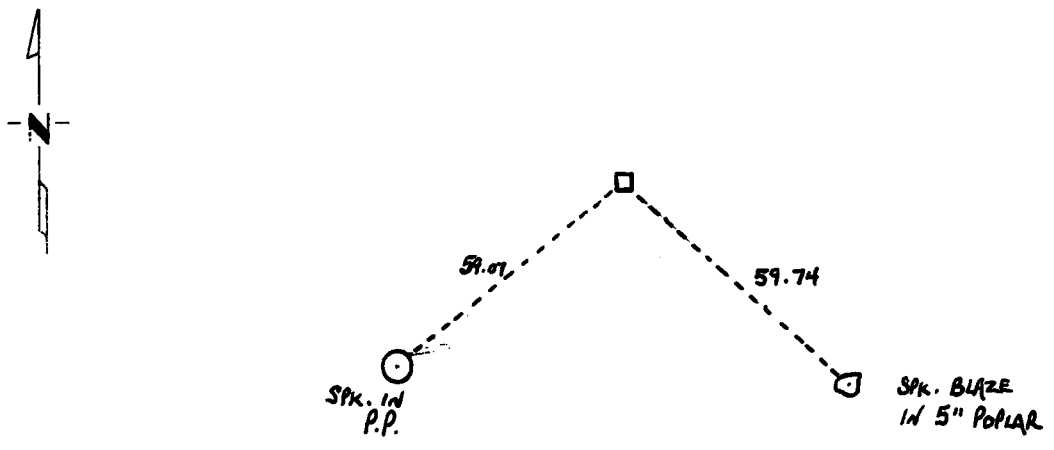

Statement of evidence relative to this corner location is on back of page.

I hereby certify that this document and the data contained herein was prepared by me or under my direct supervision.

Marshall B. Pude 11-26-74
SIGNATURE DATE

Registration No. 8195
 Land Surveyor, Professional Engineer
 County Surveyor, County Engineer

OFFICE OF THE REGISTER OF DEEDS
County of Kanabec

I hereby certify that this document was filed in the Reg. of Deeds office at 11:45 A.M. on the 27th day of January A.D., 1975

Register of Deeds Dorcas J. Nelson
By _____, Deputy

DOCUMENT NO. _____

Statement of Evidence:

Found old axle hub per Certificate No. 178.