

CERTIFICATE OF LOCATION OF GOVERNMENT CORNER

NORTHEAST Corner of Section 36, Township 40, Range 23, 4TH P.M.

STATE OF MINNESOTA, County of KANABEC

At the corner location shown on the sketch:
On 01/28/2003 Found a Kanabec County Monument.

Kanabec County U.S. Survey Feet Coordinates
NAD 1983, HARN 1996 Adjustment
Obtained by RTK GPS Observation

Northing= 169096.365

Easting= 438284.979

Note: NAD 1983, HARN 1996 Adjustment
coordinates are NOT compatible with
NAD 1983 coordinates

Note: 1 Meter=3937/1200 U.S. Survey Feet

SKETCH OF REFERENCE TIES

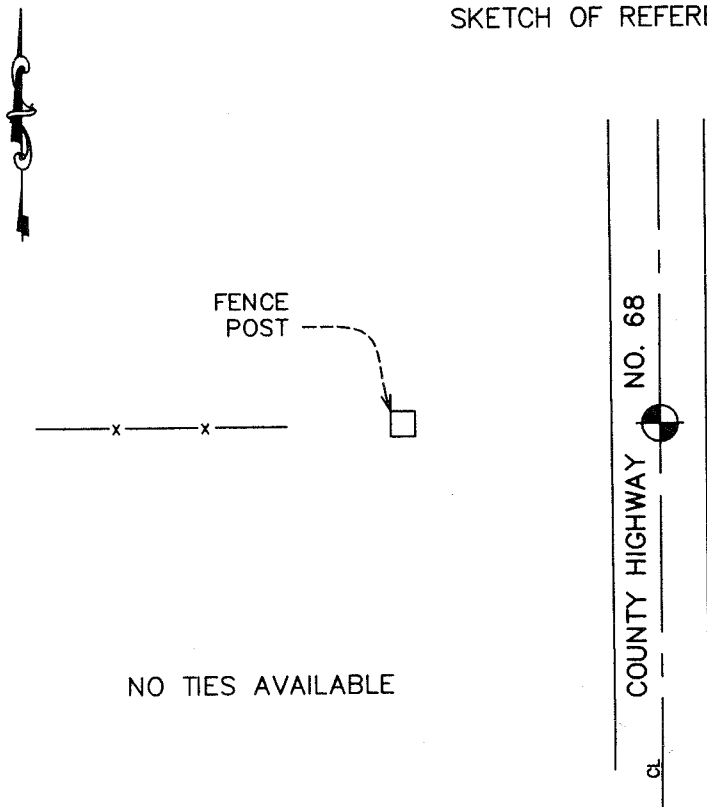

Statement of evidence relative to this corner location is on back of page.

I hereby certify that this document and the data contained herein was prepared by me or under my direct supervision.

Ernest J. Reed
Signature

5-27-2004
Date

Registration No. 9808

Land Surveyor, [] Professional Engineer

[] County Surveyor, [] County Engineer

OFFICE OF THE COUNTY RECORDER

County of _____

I hereby certify that this document was filed in the County Recorder's office at _____ M. on the _____ day of _____ A.D., 20____

County Recorder _____

BY _____ Deputy

DOCUMENT NO. _____

STATEMENT OF EVIDENCE
(FROM TIE SHEET 735)

All of the original government bearing trees are now gone.

There is no resurvey data on file for this corner. There is a town road order on file dates 1903, that establishes a town road from the northwest corner of Section 6, Township 40, Range 22, south on the town line to the southwest corner of Section 30, Township 40, Range 22.

In January of 1986, I ran a survey along the west line of Township 40, Range 22, to locate existing monuments, lines of occupation and to search the area.

This corner falls at the intersection of road north-south and a fence line west.

In July of 1986, we made an excavation with a backhoe at this location. The excavation was 15 square feet, 3 feet deep centered on the center line of road and fence line. No evidence was found in the excavation.

I accepted the center line of the road and fence per the town road order west extended east as the best available evidence of the original corner location and set a 7/8" capped rebar to mark this corner.

(2003)

On January 28, 2003, we established Kanabec County coordinates on this corner using G.P.S. equipment.