

# CERTIFICATE OF LOCATION OF GOVERNMENT CORNER

NORTH QUARTER Corner of Section 26, Township 38, Range 25, 4TH P.M.

STATE OF MINNESOTA, County of KANABEC

At the corner location shown on the sketch:  
FOUND THIS MONUMENT  
AND ESTABLISHED KANABEC COUNTY COORDINATES ON ITS LOCATION.

Kanabec County U.S. Survey Feet Coordinates  
NAD 1983, HARN 1996 Adjustment  
Obtained by RTK GPS Observation

Northing= 111645.44  
Easting= 367228.55

Note: NAD 1983, HARN 1996 Adjustment  
coordinates are NOT compatible with  
NAD 1983 coordinates  
Note: 1 Meter=3937/1200 U.S. Survey Feet

### SKETCH OF REFERENCE TIES

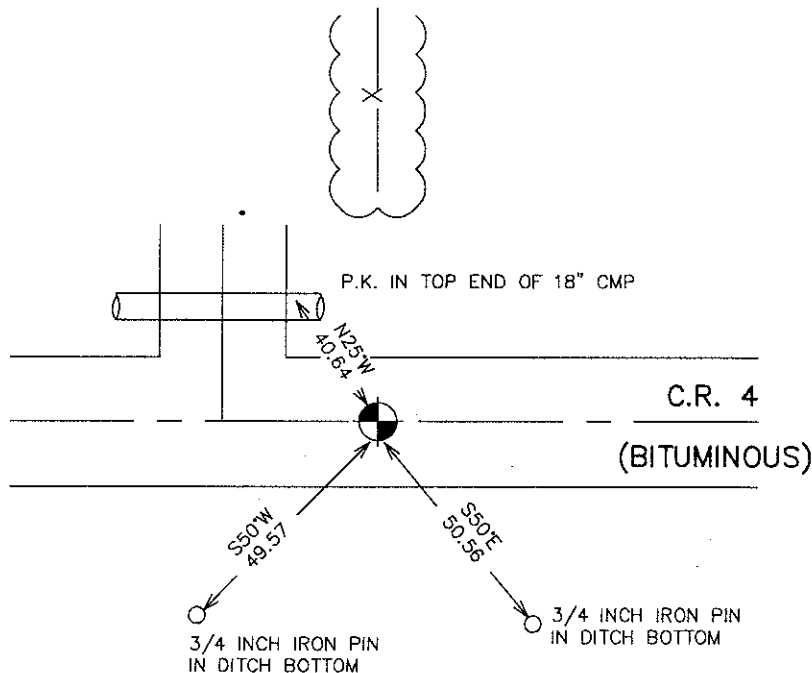

Statement of evidence relative to this corner location is on back of page.

I hereby certify that this document and the data contained herein was prepared by me or under my direct supervision.

*Ernest J. Reed*  
Signature

10-05-2007  
Date

Registration No. 9808

Land Surveyor,  Professional Engineer  
 County Surveyor,  County Engineer

### OFFICE OF THE COUNTY RECORDER

County of \_\_\_\_\_

I hereby certify that this document was filed in the County Recorder's office at \_\_\_\_\_ M. on the

\_\_\_\_\_ day of \_\_\_\_\_ A.D., 20\_\_

County Recorder \_\_\_\_\_

BY \_\_\_\_\_ Deputy

DOCUMENT NO. \_\_\_\_\_

# NORTH QUARTER CORNER SECTION 26, T38, R25

## STATEMENT OF EVIDENCE

The original public land survey was run in 1851 by Mr. D. Higbee, Deputy Surveyor, and a wood post was used to mark the corner. Bearing ties were made to a sugar maple and a pine tree.

In 1984, M.B. Rude, Kanabec County Surveyor, recorded Certificate Index No. 693, in which he States: All of the original bearing trees are now gone.

There is no resurvey data on file for this corner. On July 11, 1984, we ran a survey from the Northeast Corner of Section 26 to the Northwest Corner of Section 27, and located existing monuments and lines of occupation.

This corner falls in an East-West road, and fence line North extended South. M.B. Rude made an excavation with a backhoe at this location. The excavation was 12 feet square, 4 feet deep, 1 foot into the natural ground, and centered on the centerline of the East-West road and fence line North extended South. No evidence was found in the excavation. Mr. M.B. Rude set this corner on a line and split between the Northeast and Northwest Corners of Section 26.

In 1984, County Highway Department notes show an aluminum cap on rebar for the corner. Numerous reference ties were made for grading of CSAH 4 from CSAH 10 to T.H. 47

In July, 1984, M.B. Rude, Surveyor, made a survey for The Kanabec Co. Highway Department. On a certificate recorded in Surveyor's Record Book A, Page 267, Mr. Rude shows a Kanabec County cast aluminum cap at the North Quarter Corner of Section 26, T. 38, R. 25.

On April 28, 1999, The Minnesota Department of Transportation recovered a 7/8 inch iron rebar with no cap down 0.8 feet, as described by Mr. Rude's Certificate Index Number 693.

In January, 2002, The Minnesota Department of Transportation again found iron rebar and established bearing ties to two 14 x 24 inch iron pins, and one culvert end. The Minnesota Department of Transportation accepts this position as the correct location for the corner.

In 2006 E.G. Rud and Sons established Kanabec County Coordinates on this corner.