

3825041

CERTIFICATE OF LOCATION OF GOVERNMENT CORNER

SOUTHEAST Corner of Section 32, Township 38, Range 25, 4TH P.M.

STATE OF MINNESOTA, County of KANABEC

At the corner location shown on the sketch:
 FOUND A 1 1/2 INCH IRON PIPE DOWN 0.2 FEET AND 0.5 FEET
 NORTH OF THE CENTERLINE

Kanabec County U.S. Survey Feet Coordinates
 NAD 1983, HARN 1996 Adjustment
 Obtained by RTK GPS Observation

Northing= 101694.22
 Easting= 353932.54

Note: NAD 1983, HARN 1996 Adjustment
 coordinates are NOT compatible with
 NAD 1983 coordinates
 Note: 1 Meter=3937/1200 U.S. Survey Feet

SKETCH OF REFERENCE TIES

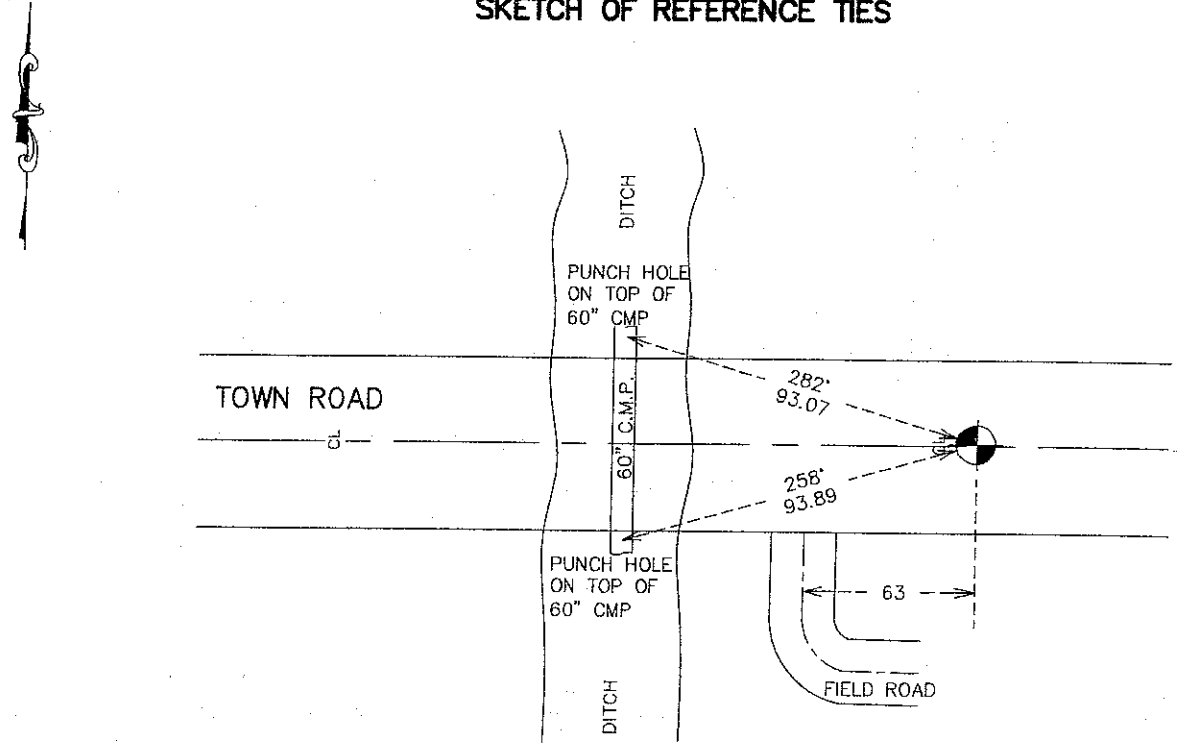

Statement of evidence relative to this corner location is on back of page.

I hereby certify that this document and the data
 contained herein was prepared by me or under
 my direct supervision.

Ernest J. Reed 9-30-2008
 Signature Date

Registration No. Minn No 9808

Land Surveyor, Professional Engineer
 County Surveyor, County Engineer

OFFICE OF THE COUNTY RECORDER
 County of _____

I hereby certify that this document was filed in
 the County Recorder's office at _____ M. on the
 _____ day of _____ A.D., 20____

County Recorder _____
 BY _____ Deputy

DOCUMENT NO. _____

SOUTHEAST CORNER SECTION 32, TOWNSHIP 38, RANGE 25

STATEMENT OF EVIDENCE

THE DEPARTMENT OF NATURAL RESOURCES, DIVISION OF LANDS AND MINERALS, CONTACTED THE FOLLOWING OFFICES FOR INFORMATION REGARDING THIS CORNER: MN SECRETARY OF STATE, ISANTI COUNTY RECORDER AND ENGINEER, MILLE LACS COUNTY RECORDER AND ENGINEER, POLARIS LAND SURVEYING, DALE ANDERSON-PASSE ENGINEERING, HANSEN SURVEYING, AND MNDOT IN ST. CLOUD.

1851

THE US GENERAL LAND OFFICE FIELD NOTES, ON FILE IN THE SECRETARY OF STATE'S OFFICE, SHOW THIS CORNER TO BE MARKED WITH A POST IN TAMARACK SWAMP AND THE FOLLOWING BEARING TREES WERE MARKED:

TAMARACK 8" N 48°W 23 LINKS (15.18")

TAMARACK 8" N 53°E 20 LINKS (13.20")

TAMARACK 14" S 44°E 46 LINKS (30.36")

TAMARACK 12" S 20°W 26 LINKS (17.16")

1916

IN AUGUST R.S. CHAPMAN FILED A RE-SURVEY OF SECTION 36, TOWN 38 NORTH-RANGE 26 WEST-4TH P.M. IN THE MILLE LACS COUNTY RECORDERS OFFICE. HE SHOWS THE FOLLOWING INFORMATION FROM THE SOUTHEAST CORNER OF SECTION 36 (SUPPOSED GOVT. COR.) TO THE NORTH QUARTER CORNER OF SECTION 2, T. 37, R. 25 (GOVT. COR.): GOVT DIST. 23,824.68 FT. AND RE-SURVEY 24,024.00 FT. [BASED ON THE INFORMATION SHOWN ON THIS PLAT, IT IS ASSUMED THAT THERE WERE NO OTHER GOVERNMENT CORNERS FOUND ALONG THIS LINE.]

1999

THE DNR SURVEY CREW LOCATED THE NORTHWEST CORNER SECTION 6 AND THE NORTH QUARTER CORNER SECTION 2. THE DISTANCE BETWEEN THEM IS 23,926.42 FEET WHICH IS APPROXIMATELY 100' LONGER THAN GLO AND 100' SHORTER THAN CHAPMAN'S DISTANCE. COUNTY CIM'S WERE FOUND AT THE NORTH QUARTER AND NORTHEAST CORNERS OF SECTION 6. LOST POSITIONS WERE COMPUTED FOR THE CORNERS ALONG THE NORTH LINE OF SECTIONS 3, 4, AND 5. THE HALF MILE PROPORTIONAL DISTANCE IS 2654.77 FEET. A 1 1/4" IRON PIPE WAS FOUND AT THE NORTH QUARTER SECTION 5 AT A DISTANCE OF 2654.93 FEET FROM THE NORTHWEST CORNER AND A 1 1/2" IRON PIPE WAS FOUND FOR THE NORTHEAST CORNER OF SECTION 5 AT A DISTANCE OF 2654.80 FEET FROM THE NORTH QUARTER CORNER. THE IRON PIPE WAS ACCEPTED AS MARKING THE CORNER AND TIES WERE TAKEN.

FOR MORE INFORMATION ON THE ABOVE SAID SURVEY IN THIS AREA PLEASE CONTACT MN DNR, DIVISIONS OF LANDS AND MINERALS, SURVEY SECTION, 1601 MINNESOTA DRIVE, BRAINERD, MN 56401.

ON APRIL 8, 2008 E.G. RUD & SONS, INC. FOUND THIS MONUMENT AND KANABEC COUNTY COORDINATES WERE ESTABLISHED ON THIS POSITION USING GLOBAL POSITIONING SYSTEM (G.P.S.) EQUIPMENT.