

CERTIFICATE OF LOCATION OF GOVERNMENT CORNER

E. 1/4 Corner of Section 19, Township 41, Range 22 4TH P.M.

STATE OF MINNESOTA, County of KANABEC

At the corner location shown on the sketch

- On found a
Date
- left monument as found, lowered monument, removed monument (explain)
- On 6 - 25 - 87 placed a 7/8" x 36" CAPPED REBAR
Date

SKETCH OF REFERENCE TIES

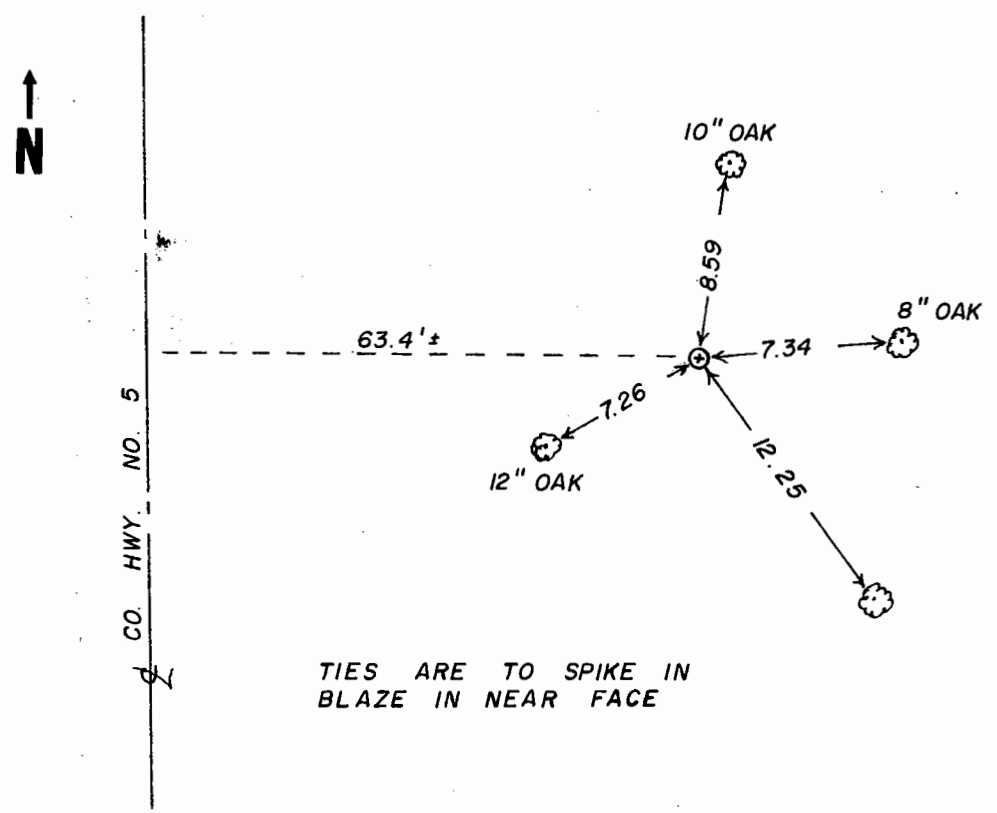

Statement of evidence relative to this corner location is on back of page.

I hereby certify that this document and the data contained herein was prepared by me or under my direct supervision.

[Signature] 6-30-87
 Signature Date

Registration No. 8195

- Land Surveyor, County Surveyor,
- Professional Engineer County Engineer

OFFICE OF THE COUNTY RECORDER

County of

I hereby certify that this document was filed in the County Recorder's office atM. on the day ofA.D., 19.....

County Recorder

By, Deputy

DOCUMENT NO.

STATEMENT OF EVIDENCE

All of the original bearing trees are now gone.

There is a township road order on file at the County Recorder's Office showing a road along the east line of Section 19 from the east quarter corner to the northeast corner. There is now a county highway near this corner.

On June 11, 1987, we made a survey around Section 19 to locate the existing monuments, lines of occupation and search the areas. No evidence was found in this area.

We set a 7/8" by 36" capped rebar and steel fence post on line and proportional distance between the northeast and the southeast corners.