

CERTIFICATE OF LOCATION OF GOVERNMENT CORNER

East Quarter Corner of Section 35, Township 41 North, Range 22 West,
4th Principal Meridian, Kanabec County, State of Minnesota

At the corner location shown on the sketch:
Set a 7/8" x 30" Rebar monument with Aluminum Cap.

Kanabec County U.S. Survey Feet Coordinates
NAD 1983, HARN 1996 Adjustment
Obtained by RTK GPS observation
Northing: 194340.8447
Easting: 455214.0442

Note: NAD 1983, HARN 1996 Adjustment
coordinates are NOT compatible with
NAD 1983 coordinates
Note: 1 Meter = 3937/1200 U.S. Survey Feet

SKETCH OF REFERENCE TIES

NOT TO SCALE

KROSCHEL LAND SURVEYORS, INC.
ASSUMES NO LIABILITY FOR THE ACCURACY
OF THE GPS COORDINATES SHOWN HEREON.
ALL COORDINATES AND DIMENSIONS
SHOULD BE FIELD VERIFIED BY THE USER.



SECTION 35

4" POPLAR
SET NAIL IN N FACE

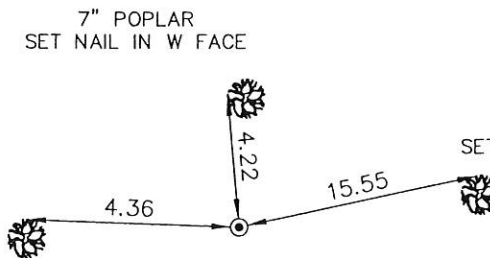

SECTION 36



Kroschel Land Surveyors, Inc.

1639 Main Street North, Suite 6, Pine City, MN 55063
Phone: 320-629-3267 Fax: 320-629-0176

Statement of evidence relative to this corner location is on back of page.

I hereby certify that this survey, plan, or report was prepared by me or under my direct supervision, that the United States public land survey monument record is correct and complete to the best of my knowledge and belief, and that I am a duly Licensed Land Surveyor under the laws of the State of Minnesota.

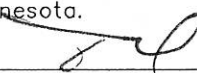
Tyler J. Kroschel
License No. 44490
 Land Surveyor County Surveyor

1-14-2014
Date

OFFICE OF THE COUNTY RECORDER
County of Kanabec

I hereby certify that this document was filed in the County Recorder's office at _____ .M. on the _____ day of _____ A.D., 20____
County Recorder _____
By _____, Deputy
DOCUMENT NO. _____

114/52

Statement of Evidence:

In October of 1855 Deputy Surveyor Isaac Banker set a post to mark the East Quarter corner of Section 35, Township 41 North, Range 22 West of the 4th Principal Meridian.

All of the original Government evidence was searched for. None was found.

There is no resurvey information available for this corner.

In December 2013 I made a survey around Sections 34 and 35, Township 41, Range 22 for Jerry Hennessey to locate existing monuments, lines of occupation and establish search areas.

On 12/3/2013 I made a search with a magnetic locator at a lost position. No evidence of the corner was found. I set a 7/8"x 30" Rebar monument with Aluminum cap at a single proportion position. I measure 2664.01 feet to both the Northeast and Southeast corners of Section 35. Established reference ties and assigned Kanabec County coordinates.

This location was determined to be the best available evidence of the original government corner monument location.



Kroschel Land Surveyors, Inc.

1639 Main Street North, Suite 6, Pine City, MN 55063
Phone: 320-629-3267 Fax: 320-629-0176