

CERTIFICATE OF LOCATION OF GOVERNMENT CORNER

North Quarter Corner of Section 7, Township 41 North, Range 23 West,
4th Principal Meridian, Kanabec County, State of Minnesota

At the corner location shown on the sketch:
On 3/06/2017 found a 1/2" iron pipe with Aluminum Cap.

Kanabec County U.S. Survey Feet Coordinates
NAD 1983, HARN 1996 Adjustment
Obtained by RTK GPS observation
Northing: 218455.9160
Easting: 399672.8687

Note: NAD 1983, HARN 1996 Adjustment
coordinates are NOT compatible with
NAD 1983 coordinates

Note: 1 Meter = 3937/1200 U.S. Survey Feet

SKETCH OF REFERENCE TIES

NOT TO SCALE

KROSCHER LAND SURVEYORS, INC.
ASSUMES NO LIABILITY FOR THE ACCURACY
OF THE GPS COORDINATES SHOWN HEREON.
ALL COORDINATES AND DIMENSIONS
SHOULD BE FIELD VERIFIED BY THE USER.

THE BASIS OF BEARINGS FOR THIS
DRAWING IS THE KANABEC COUNTY
COORDINATE SYSTEM BY MNDOT,
NAD 1983, HARN 1996 ADJUSTMENT

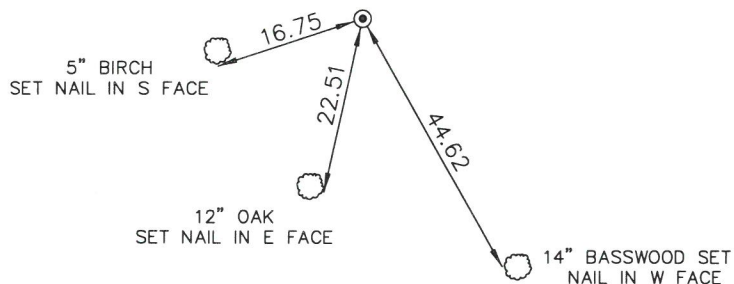
SECTION 6**SECTION 7**

Kroschel Land Surveyors, Inc.

1639 Main Street North, Suite 6, Pine City, MN 55063
Phone: 320-629-3267 Fax: 320-629-0176

Statement of evidence relative to this corner location is on back of page.

I hereby certify that this survey, plan, or report was prepared by me or under my direct supervision, that the United States public land survey monument record is correct and complete to the best of my knowledge and belief, and that I am a duly Licensed Land Surveyor under the laws of the State of Minnesota.

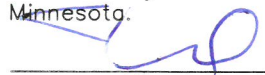
Tyler J. Kroschel

License No. 44490

☐ Land Surveyor

☒ County Surveyor

Date

12-28-2017

OFFICE OF THE COUNTY RECORDER

County of Kanabec

I hereby certify that this document was filed in the
County Recorder's office at _____ .M. on the
_____ day of _____ A.D., 20____
County Recorder _____

By _____, Deputy

DOCUMENT NO. _____

Statement of Evidence:

In October of 1851, Deputy Surveyor John Gay set a post to mark the North Quarter Corner of Section 7, Township 41 North, Range 23 West, 4th Principal Meridian.

Reference ties were taken to:

5 inch Tamarack at South 42 degrees West a distance of 3 links

7 inch Tamarack at North 17 degrees East a distance of 25 links

All of the original Government corner evidence was searched for. None was found.

1907— T.B. Vickery surveyed the Plan of Warman, recorded at the County Recorder's Office. The plat shows a stone monument at the Southeast corner of Section 6 and a stone monument 578 feet west of the Southeast corner of Section 6. In March of 2017 I made a search for the stone at the southwest corner of the plat of Warman. This corner falls near an old east-west fence line. We found many stones, but none with any markings.

In March 2017, a survey was made around Section 7, Township 41 North, Range 23 West, 4th Principal Meridian for Tom Aiels to locate existing monuments, lines of occupation and establish search areas.

On 3/6/2017 I made a search with a metal locator at the lost position between the Northeast and Northwest corners of Section 7. I found a 1/2" iron pipe with Aluminum Cap within 1 foot of the lost position. I called former County Surveyor Ernie Rud and he stated that his company had set the corner. I accepted the 1/2" iron pipe with Aluminum Cap set by Ernie Rud as the best available evidence of the original corner location. I established reference ties and assigned Kanabec County Coordinates.



Kroschel Land Surveyors, Inc.

1639 Main Street North, Suite 6, Pine City, MN 55063
Phone: 320-629-3267 Fax: 320-629-0176