

CERTIFICATE OF LOCATION OF GOVERNMENT CORNER

EAST QUARTER Corner of Section 30, Township 41, Range 23, 4TH P.M.

STATE OF MINNESOTA, County of KANABEC

At the corner location shown on the sketch:
FOUND THIS MONUMENT
AND ESTABLISHED G.P.S. COORDINATES ON ITS LOCATION

Kanabec County U.S. Survey Feet Coordinates
NAD 1983, HARN 1996 Adjustment
Obtained by RTK GPS Observation

Northing= 199889.58

Easting= 402231.66

Note: NAD 1983, HARN 1996 Adjustment
coordinates are NOT compatible with
NAD 1983 coordinates

Note: 1 Meter=3937/1200 U.S. Survey Feet

SKETCH OF REFERENCE TIES

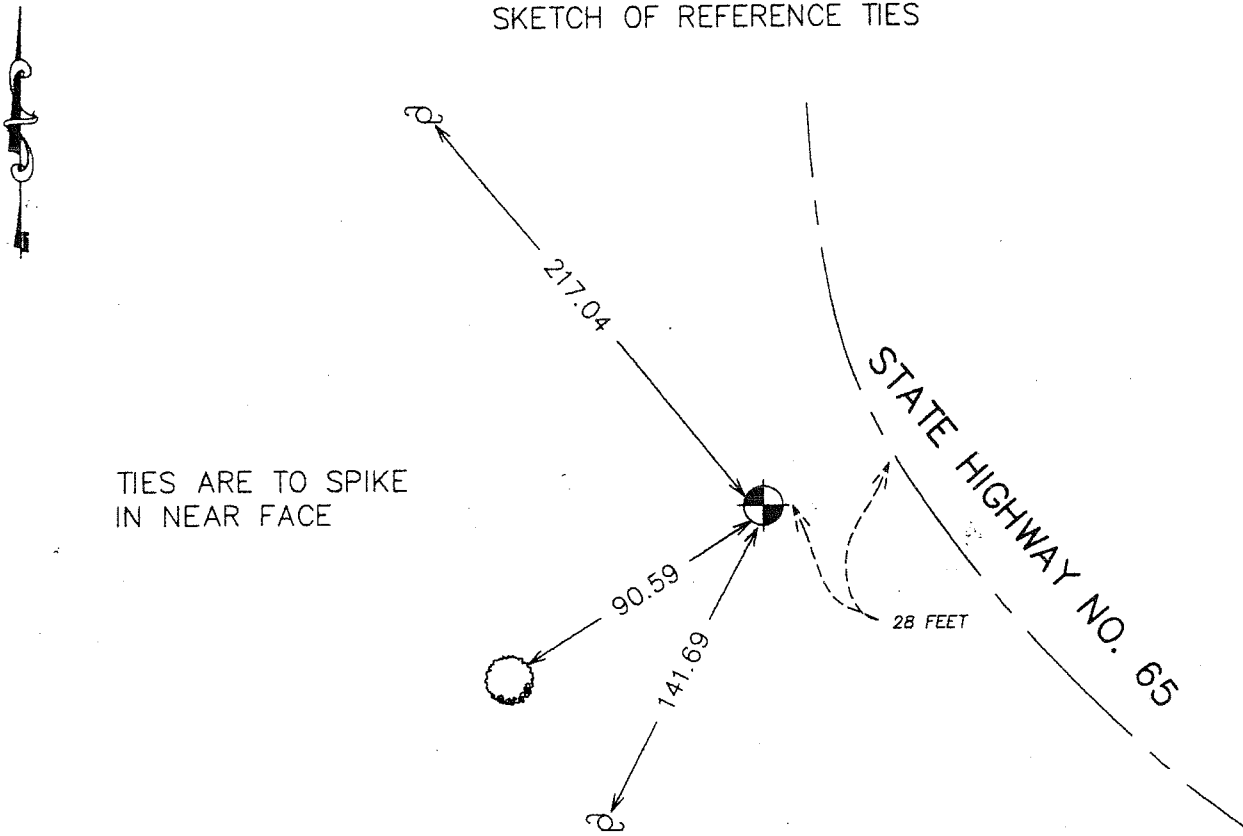

TIES ARE TO SPIKE
IN NEAR FACE

Statement of evidence relative to this corner location is on back of page.

I hereby certify that this document and the data contained herein was prepared by me or under my direct supervision.

Ernest J. Rud
Signature

2-13-2007
Date

Registration No. Minn No 9808

Land Surveyor, Professional Engineer

County Surveyor, County Engineer

OFFICE OF THE COUNTY RECORDER

County of _____

I hereby certify that this document was filed in the County Recorder's office at _____ M. on the _____ day of _____ A.D., 20____

County Recorder _____

BY _____ Deputy

DOCUMENT NO. _____

EAST QUARTER CORNER SECTION 30, TOWNSHIP 41, RANGE 23

STATEMENT OF EVIDENCE
(FROM TIE SHEET 733)

All of the original bearing trees are now gone.

The State Department of Transportation did not find this corner in their survey for the State Highway No. 65 and all evidence of the original quarter post was destroyed in road construction.

There are no lines of occupation at this corner and the Department of Transportation's right of way map for Highway No. 65 shows this corner to be west of the center line of Highway 65 on a straight line between the section corners.

In July of 1986, M.B. Rude ran a survey around Section 30 to locate the existing monuments and lines of occupation.

In 1956, Byron Lathrop made a survey in Government Lot 1. I found some of his monuments and occupation lines and extended them out to the sixteenth corner between the east quarter corner and the southeast corner of Section 30 which is the northeast corner of Government Lot 1, and found that they fit a straight line between the northeast and southeast corners of Section 30 and the center line of the north-south township road. (Old State Highway No. 65.)

M. B. Rude set this corner on line between the southeast and northeast corners of Section 30 to the northeast corner of Government Lot 1.

On June 26, 2003, E.G. Rud and Sons found this monument and established Kanabec County coordinates on this corner using G.P.S. equipment.
(2003)