

# CERTIFICATE OF LOCATION OF GOVERNMENT CORNER

NORTH QUARTER Corner of Section 26, Township 41, Range 23, 4TH P.M.

STATE OF MINNESOTA, County of KANABEC

At the corner location shown on the sketch:

SET THIS MONUMENT  
AND ESTABLISHED G.P.S. COORDINATES ON ITS LOCATION

Kanabec County U.S. Survey Feet Coordinates  
NAD 1983, HARN 1996 Adjustment  
Obtained by RTK GPS Observation

Northing= 202262.16

Easting= 420674.82

Note: NAD 1983, HARN 1996 Adjustment  
coordinates are NOT compatible with  
NAD 1983 coordinates

Note: 1 Meter=3937/1200 U.S. Survey Feet

## SKETCH OF REFERENCE TIES

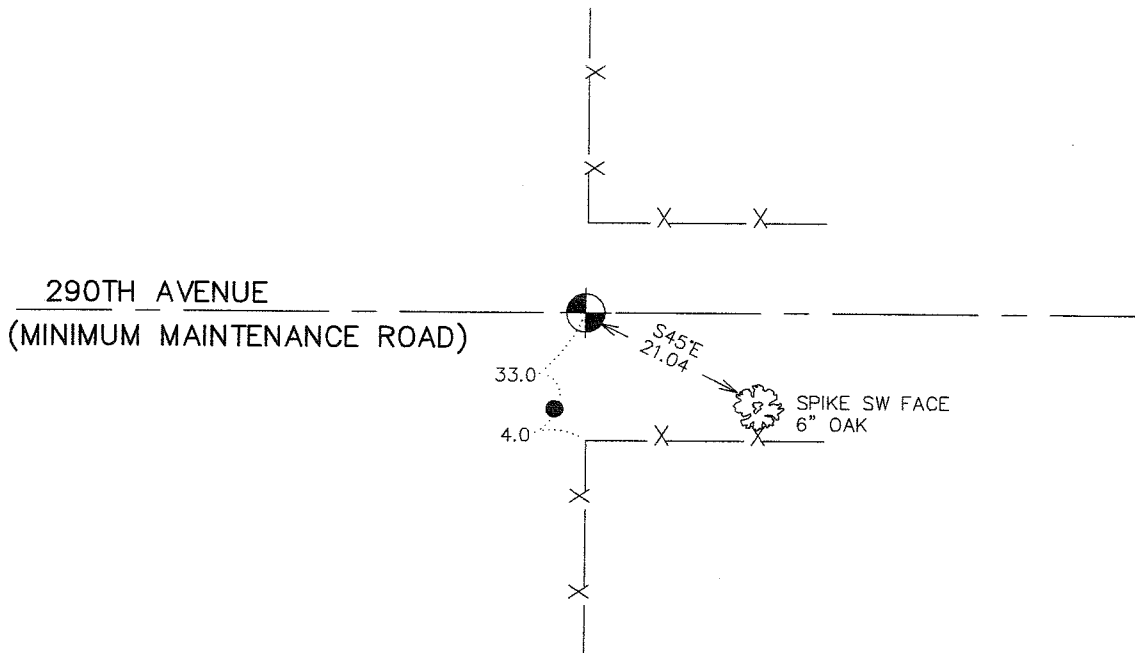

Statement of evidence relative to this corner location is on back of page.

I hereby certify that this document and the data contained herein was prepared by me or under my direct supervision.

Ernest J. Rud  
Signature

5-1-2007  
Date

### OFFICE OF THE COUNTY RECORDER

County of \_\_\_\_\_

I hereby certify that this document was filed in the County Recorder's office at \_\_\_\_\_ M. on the \_\_\_\_\_ day of \_\_\_\_\_ A.D., 20\_\_\_\_

County Recorder \_\_\_\_\_

BY \_\_\_\_\_ Deputy

**DOCUMENT NO.** \_\_\_\_\_

Registration No. Min No 9008

Land Surveyor,      [ ] Professional Engineer

[ ] County Surveyor,      [ ] County Engineer

# NORTH QUARTER CORNER SECTION 26, T41, R23

## **STATEMENT OF EVIDENCE**

A WOOD POST WAS SET FOR THE ORIGINAL CORNER AND 2 BEARING TREES ESTABLISHED BY DEPUTY SURVEYOR JOHN M GLEY IN OCTOBER 1851. ANY EVIDENCE FOR THE CORNER OR BEARING TREES NO LONGER REMAIN.

THIS CORNER FALLS ON THE CENTERLINE OF A MINIMUM MAINTENANCE ROAD AND A FENCE LINE RUNNING NORTH AND SOUTH.

JAMES VICKEREY DID A SURVEY ALONG THIS NORTH LINE IN 1910 AND RECORDED A DISTANCE OF 80.5 CHAINS (5313 FEET). HE DOES NOT STATE IF A CORNER WAS SET. IN MARCH 2007 E.G. RUD AND SONS DID A SURVEY IN SECTION 26 AND TIED IN EXISTING CORNERS AND LINES OF OCCUPATION. E.G. RUD MEASURED THE NORTH LINE AND CAME UP WITH A DISTANCE OF 5330.62 FEET. THIS CORNER WAS SET ON LINE AND SPLIT AND FIT THE FENCE LINE WITHIN 0.5 FEET AND 1.5 SOUTH OF CENTERLINE OF THE ROAD. A MONUMENT WITH AN ALUMINUM CAP WAS SET AND KANABEC COUNTY COORDINATES ESTABLISHED USING G.P.S. EQUIPMENT.