

CERTIFICATE OF LOCATION OF GOVERNMENT CORNER

E 1/4 Corner of Section 11, Township 41, Range 23, 4TH P.M.

STATE OF MINNESOTA, County of KANABEC

At the corner location shown on the sketch:

On Dec 7, 2012 we found a 1/2" iron pipe with cap # 40341

Kanabec County U.S. Survey Feet Coordinates
NAD 1983, HARN 1996 Adjustment
Obtained by RTK GPS Observation

Northing= 215456.39
Easting= 423507.98

Note: NAD 1983, HARN 1996 Adjustment coordinates are NOT compatible with NAD 1983 coordinates
Note: 1 Meter=3937/1200 U.S. Survey Feet

SKETCH OF REFERENCE TIES

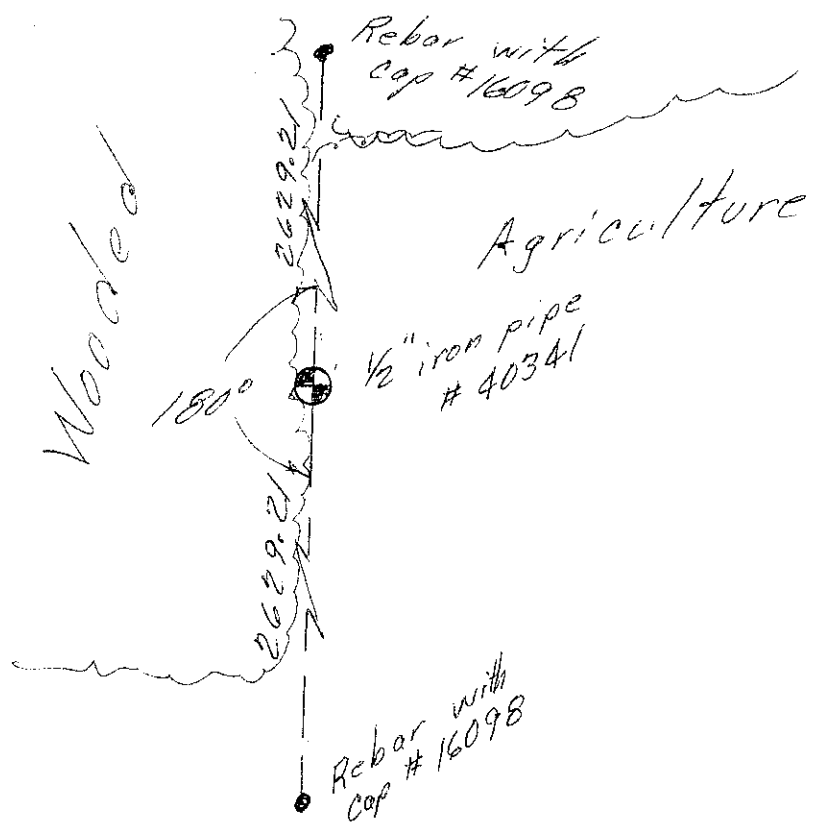

Statement of evidence relative to this corner location is on back of page.

I hereby certify that this document and the data contained herein was prepared by me or under my direct supervision.

Ernest D. Rud
Signature

June 5, 2013
Date

Registration No. 9808

- Land Surveyor, Professional Engineer
- County Surveyor, County Engineer

OFFICE OF THE COUNTY RECORDER

County of _____

I hereby certify that this document was filed in the County Recorder's office at _____ M. on the _____ day of _____ A.D., 20____

County Recorder _____

BY _____ Deputy

DOCUMENT NO. _____

STATEMENT OF EVIDENCE - ~~4123081~~
4123061

East Quarter Section 11

The original Government post was set by Deputy Surveyor John M. Gley on October 8, 1851 and 2 bearing trees noted as:

14 inch Aspen bearing North 60 degrees West a distance of 9 links

8 inch Spruce bearing North 79 degrees East a distance of 25 links

No evidence could be found for the post or bearing trees.

No records of any subsequent surveying along this line could be found at Kanabec County Office.

In 2010-2011 Sam De Leo RLS#40341 set a 1/2" iron pipe equidistant and on line between the northeast and southeast corner of Section 11 in doing a survey in 2011.

In 2013 E.G. Rud & Sons, Inc. found this iron pipe set by Sam DeLeo and verified its position. Russell Koch land owner in Section 12 was aware of this and thought the position was O.K. Therefore E.G. Rud & Sons, Inc. accepted this position and filed a certificate of location.