

4123044

CERTIFICATE OF LOCATION OF GOVERNMENT CORNER

SOUTH QUARTER Corner of Section 34, Township 41, Range 23, 4TH P.M.
STATE OF MINNESOTA, County of KANABEC

At the corner location shown on the sketch:
FOUND A 3/4 INCH BY 2 1/2 INCH PIECE OF FLAT IRON 4 TO 5 FEET LONG UP 3 INCHES

Kanabec County U.S. Survey Feet Coordinates
NAD 1983, HARN 1996 Adjustment
Obtained by RTK GPS Observation
Northing= 191762.10
Easting= 415266.45
Note: NAD 1983, HARN 1996 Adjustment coordinates are NOT compatible with NAD 1983 coordinates
Note: 1 Meter=3937/1200 U.S. Survey Feet

SKETCH OF REFERENCE TIES

from tie sheet 337

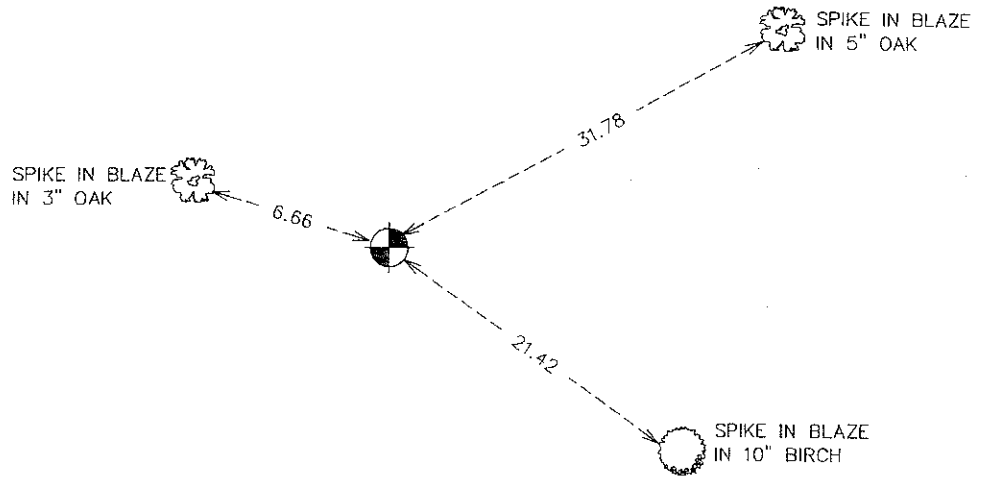

Statement of evidence relative to this corner location is on back of page.

I hereby certify that this document and the data contained herein was prepared by me or under my direct supervision.

Ernest J. Reed 9-30-2008
Signature Date

Registration No. Minn No 9808

- Land Surveyor, Professional Engineer
- County Surveyor, County Engineer

OFFICE OF THE COUNTY RECORDER

County of _____

I hereby certify that this document was filed in the County Recorder's office at _____ M. on the _____ day of _____ A.D., 20____

County Recorder _____

BY _____ Deputy

DOCUMENT NO. _____

SOUTH QUARTER CORNER SECTION 34, TOWNSHIP 41, RANGE 23

STATEMENT OF EVIDENCE

OCTOBER 5, 1851 ORIGINAL CORNER WAS SET BY DEPUTY SURVEYOR JOHN M. GIAY AND A TAMARACK AND WHITE PINE WERE ESTABLISHED AS BEARING TREES.

NOVEMBER 26, 1974 M.B. RUDE FOUND A 3/4 INCH BY 2 1/2 INCH PIECE OF FLAT IRON 4 TO 5 FEET LONG UP 3 INCHES. THIS FIT LINE AND DISTANCE PER SURVEY RECORDED IN 1928 AT THE REGISTER OF DEEDS OFFICE.

JUNE 10, 2008 E.G. RUD & SONS, INC. FOUND THIS FLAT IRON AND KANABEC COUNTY COORDINATES WERE ESTABLISHED ON THIS POSITION USING GLOBAL POSITIONING SYSTEM (G.P.S.) EQUIPMENT.