

CERTIFICATE OF LOCATION OF GOVERNMENT CORNER

NORTH QUARTER Corner of Section 8, Township 42, Range 22, 4TH P.M.

STATE OF MINNESOTA, County of KANABEC

At the corner location shown on the sketch:

On _____ found a _____
DATE

left monument as found, lowered monument, removed monument (explain)

On 8/19/98 Placed a 3/4" X 24" IRON ROD WITH A "MNDNR SURVEY MARKER" CAP
DATE

SKETCH OF REFERENCE TIES

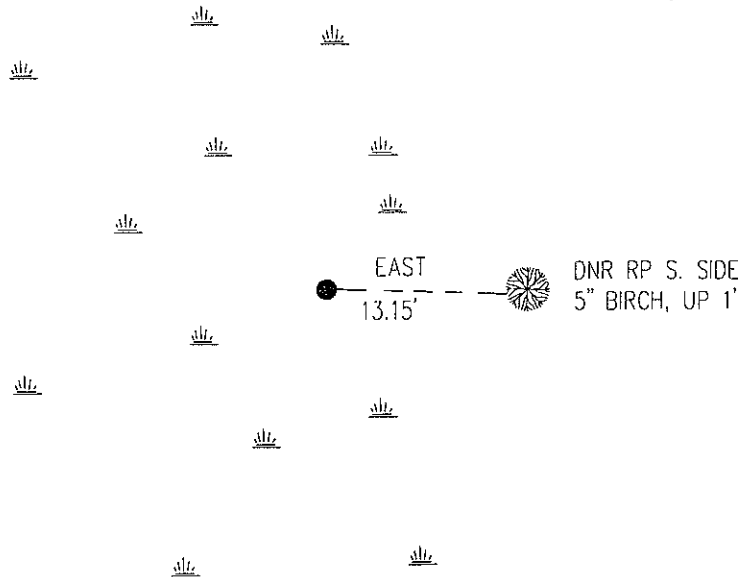

KANABEC CO.
COORDINATES

N 252985.84
E 437229.28

AZIMUTH OBSERVED WITH COMPASS

Statement of evidence relative to this corner location is on back of page.

12/98
WMA000271

I hereby certify that this document and the data contained herein was prepared by me or under

my direct supervision.
John D. Walker 12/8/98
SIGNATURE DATE

License Number 16098

Land Surveyor, Professional Engineer
 County Surveyor, County Engineer

OFFICE OF THE COUNTY RECORDER

County of _____

I hereby certify that this document was filed in the Co. recorders office at _____ M. on the _____ day of _____ A.D., 19____

County Recorder _____

By _____, Deputy

DOCUMENT NO. _____

12.5554

North Quarter Corner Section 8, Township 42 North, Range 22 West

The DNR Bureau of Engineering contacted the following for survey information:

- Minnesota Secretary of State's Office
- Kanabec County Recorders's Office
- Kanabec County Highway Engineer
- Kanabec County Surveyor
- Bill Hayden, Land Surveyor
- Terrence Johnson, Land Surveyor

1855 U.S. General Land Office notes obtained from the Secretary of State's Office states that a post was set to mark the corner with the following bearing trees marked:

- W. Pine 20" N 4° 45' W 14 links (9.24 feet)
- W. Pine 18" S 69° 15' W 25 links (16.50 feet)

1961 MN. Dept. Nat. Resources set an iron pipe at an assumed corner.

1997 MN DNR Bureau of Engineering found iron pipe in swamp.

1998 MN DNR Bureau of Engineering considered this corner lost and established a position for it by single proportion and set a DNR Survey Marker. The iron pipe falls 61' north and 13' west of the lost position. The corners used for the proportion the Northeast Corner Section 8 and the Northeast Corner Section 7. Ties taken as shown on the face of this certificate. Measurements to the section corners east and west are:

- N89°47'51"E 2623.97 feet
- S89°47'51"W 2623.97 feet

For more information on our survey in this area please contact MN DNR, Bureau of Engineering, Survey Section, 1601 Minnesota Drive, Brainerd, MN 56425