

# CERTIFICATE OF LOCATION OF GOVERNMENT CORNER

NORTH QUARTER Corner of Section 31, Township 42, Range 22, 4TH P.M.

STATE OF MINNESOTA, County of KANABEC

At the corner location shown on the sketch:

ON 5/29/2014 FOUND A 3/4" SWIVEL AND RESET WITH KANABEC COUNTY MONUMENT.

Kanabec County U.S. Survey Feet Coordinates  
NAD 1983, HARN 1996 Adjustment  
Obtained by RTK GPS Observation

Northing= 229942.19

Easting= 431801.71

Note: NAD 1983, HARN 1996 Adjustment  
coordinates are NOT compatible with  
NAD 1983 coordinates

Note: 1 Meter=3937/1200 U.S. Survey Feet

## SKETCH OF REFERENCE TIES

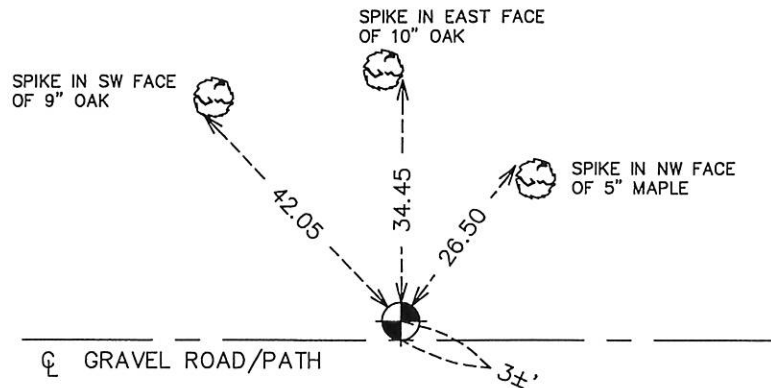

Statement of evidence relative to this corner location is on back of page.

I hereby certify that this document and the data contained herein was prepared by me or under my direct supervision.

Ernst J. Rud  
Signature

12-10-14  
Date

Registration No. 9808

Land Surveyor,      [ ] Professional Engineer

[ ] County Surveyor,      [ ] County Engineer

## OFFICE OF THE COUNTY RECORDER

County of \_\_\_\_\_

I hereby certify that this document was filed in the County Recorder's office at \_\_\_\_\_ M. on the \_\_\_\_\_ day of \_\_\_\_\_ A.D., 20\_\_\_\_

County Recorder \_\_\_\_\_

BY \_\_\_\_\_ Deputy

DOCUMENT NO. \_\_\_\_\_

North Quarter Section 31, Township 42, Range 22

The original Government corner was a post set by Deputy Surveyor Isaac A. Banker on November 26, 1855 and two bearing trees noted as;

10" Sugar Maple bearing South 5° 15' West at 20 Links

20" Aspen bearing North 3° West at 34 links

No evidence for the corner or bearing trees could be found.

There are no records of any subsequent surveys along this line at Kanabec County Offices or any road openings on file at the County Auditor's Office.

This corner falls on the centerline of a minimum maintenance road running east-west with no lines of occupation running north or south. Therefore we treated this corner as lost and set in on line and at a proportional distance between the northwest and the northeast corners of Section 31. A number 7 rebar with an aluminum cap was set, ties taken and Kanabec County Coordinates established on this position.

The Minnesota D.N.R. has also used this location for a survey in Southwest Quarter of Section 30.