

CERTIFICATE OF LOCATION OF GOVERNMENT CORNER

NORTHEAST Corner of Section 31, Township 42 N, Range 22 W, 4th P.M.

STATE OF MINNESOTA, County of KANABEC

At the corner location shown on the sketch:

- On _____ found a _____
DATE
- left monument as found, lowered monument, removed monument (explain)
- On 10-19-95 Placed a 3/4" x 24" REBAR WITH AN ALUMINUM CAP STAMPED: "DNR SURVEY MARKER"
DATE
(DOWN 0.5') IN CENTER LINE OF ROADS E, N AND DRIVEWAY W.

SKETCH OF REFERENCE TIES

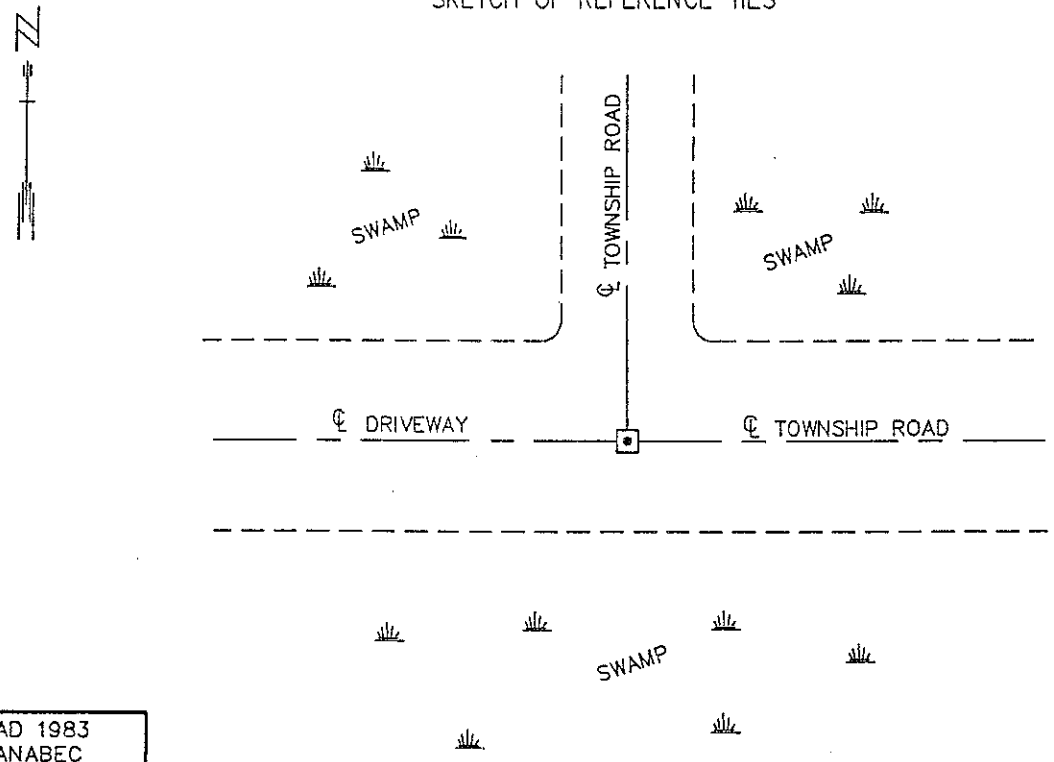

NAD 1983
KANABEC
COUNTY
COORDINATES
N 229972.63
E 434427.45

NO TIES AVAILABLE

Statement of evidence relative to this corner location is on back of page.

MARCH 1997
WMA01539

I hereby certify that this document and the data contained herein was prepared by me or under my direct supervision.

John D. Walker 3/21/97
SIGNATURE DATE

License Number 16098

- Land Surveyor, Professional Engineer
- County Surveyor, County Engineer

OFFICE OF THE COUNTY RECORDER

County of _____

I hereby certify that this document was filed in the Co. recorders office at _____ .M. on the _____ day of _____ A.D., 19____

County Recorder _____
By _____, Deputy

DOCUMENT NO. _____

Northeast Corner Section 31, Township 42 North, Range 22 West, 4th P.M.

The Department of Natural Resources, Bureau of Engineering (BOE) made the following contacts for information concerning this corner:

Minnesota Secretary of States Office
County Auditor, Engineer, Recorder and Surveyor

1855 The U.S. General Land Office set a post to mark this corner and the following bearing trees were marked:

Tamarac 7"	N 43° 30' E	12 links (7.92')
Tamarac 9"	N 38° 15' W	17 links (11.22')
Tamarac 14"	S 39° W	32 links (21.12')
Tamarac 12"	S 18° 15' E	21 links (13.86')

1903 Surveyor John Nelson made a survey of several roads in the township of Kroschel. He established a road along the north lines of section 32, 33 and 34. He measured 79.44 chains along the north line section 32. He states all the corners on the plat marked "G" indicate corners that were found government marks at the time of this survey. (No marks are on the plat on page 315.)

1904 Surveyor John Nelson made a survey for a township road between the following sections; 28 33, 29&32, 29&30, 20&29, 19&30. He shows a measurement of 79.43 chains along the north line of section 32.

1923 County Surveyor Geo. Jenks found an old post to mark this corner and placed a stone marked "X". He took the following ties:

Tamarac stump SE 13.9'
Oak fence post NE 25.2'

He filed the certificate March 2, 1925.

1995 The BOE found nothing with the metal locator on the centerline of the east-west and north roads. The County Highway Department was hired to dig for the corner centering on the intersection. A 12' north-south x 15' east-west hole was dug to a depth of 4'. Stones and wood debris was found. None of the stones looked set nor did any of them have an "X" on them. Glenn Bartel, 63 years old and life time resident of the farm southwest of the corner, states that the road hasn't been upgraded that he knew of. He hadn't seen a stone at this corner, but had seen a stone one mile west.

The road intersection was accepted as marking the obliterated location of the corner and a DNR survey marker was set to mark the corner.

For information regarding this survey, contact the MN Department of Natural Resources, Bureau of Engineering, Survey Section, 500 Lafayette Road, St. Paul, MN 55155-4029.