

CERTIFICATE OF LOCATION OF GOVERNMENT CORNER

NE Corner of Section 11, Township 42, Range 22, 4TH P.M.

STATE OF MINNESOTA, County of KANABEC

At the corner location shown on the sketch

On 10 - 5 - 94 found a CAST ALUMINUM MONUMENT
Date

left monument as found, [] lowered monument, [] removed monument (explain)

[] On _____ placed a _____
Date

SKETCH OF REFERENCE TIES

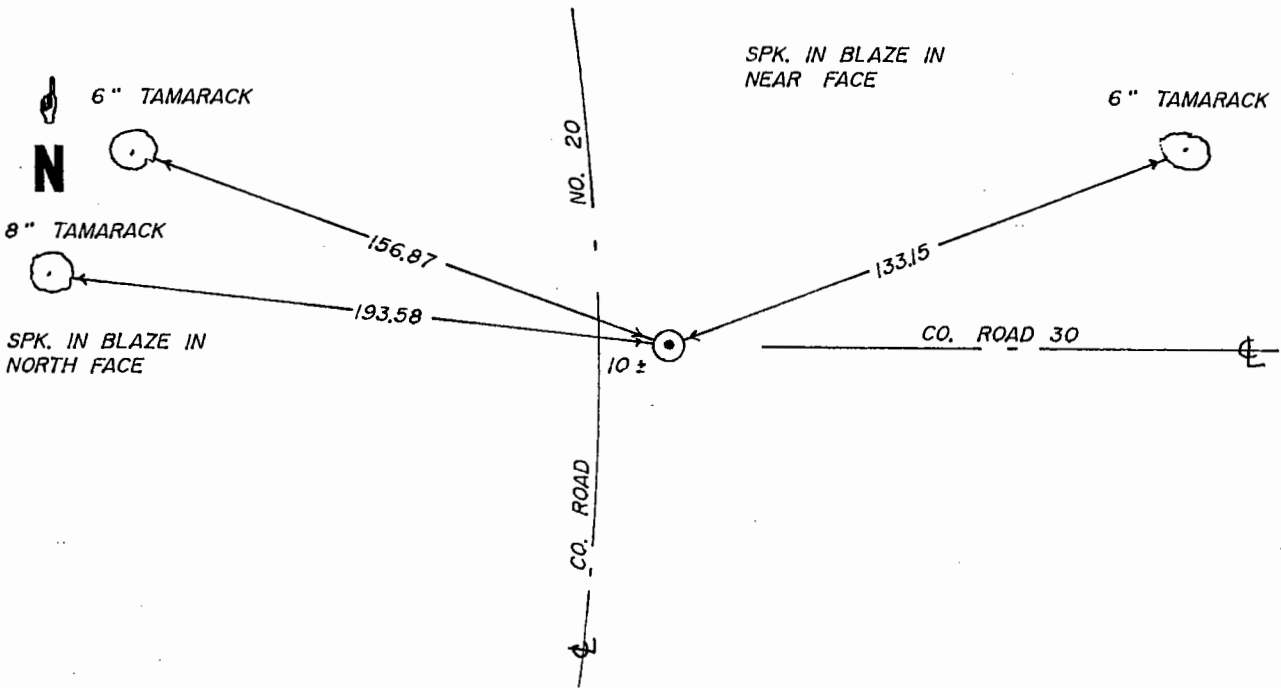

Kan. Co
36

Statement of evidence relative to this corner location is on back of page.

I hereby certify that this document and the data contained herein was prepared by me or under my direct supervision.

[Signature] 11-10-94
Signature Date

Registration No. 8195

[] Land Surveyor, [] Professional Engineer

County Surveyor, [] County Engineer

OFFICE OF THE COUNTY RECORDER

County of _____

I hereby certify that this document was filed in the County Recorder's office at _____ M. on the

_____ day of _____ A.D., 19____

County Recorder _____

By _____ Deputy

DOCUMENT NO. _____

STATEMENT OF EVIDENCE

All of the original government bearing trees are now gone.

This corner was reestablished by Neubert W. Swanson, a Registered Land Surveyor, in a survey for the plat of DEEPHAVEN in 1961 and used by him in the plat of POINT# ELEVEN in 1970.

In 1975, a survey crew working for the County, under my supervision, found Swanson's monument and replaced it with a cast iron aluminum monument.

On October 5, 1994, we found the cast aluminum monument per the survey records from 1975 and made new reference ties.