

# CERTIFICATE OF LOCATION OF GOVERNMENT CORNER

NW cor 19 19 T42 22  
 Corner of Section ~~24~~, Township ~~542~~, Range ~~25~~, 4th P.M.  
STATE OF MINNESOTA, County of KANABEC

At the corner location shown on the sketch:

*On March 16, 2004 we set a 7/8" x 24" rebar with an aluminium cap*

Kanabec County U.S. Survey Feet Coordinates  
NAD 1983, HARN 1996 Adjustment  
Obtained by RTK GPS Observation

Northing= 240458.244  
Easting= 429101.124

Note: NAD 1983, HARN 1996 Adjustment coordinates are NOT compatible with NAD 1983 coordinates

Note: 1 Meter=3937/1200 U.S. Survey Feet

## SKETCH OF REFERENCE TIES

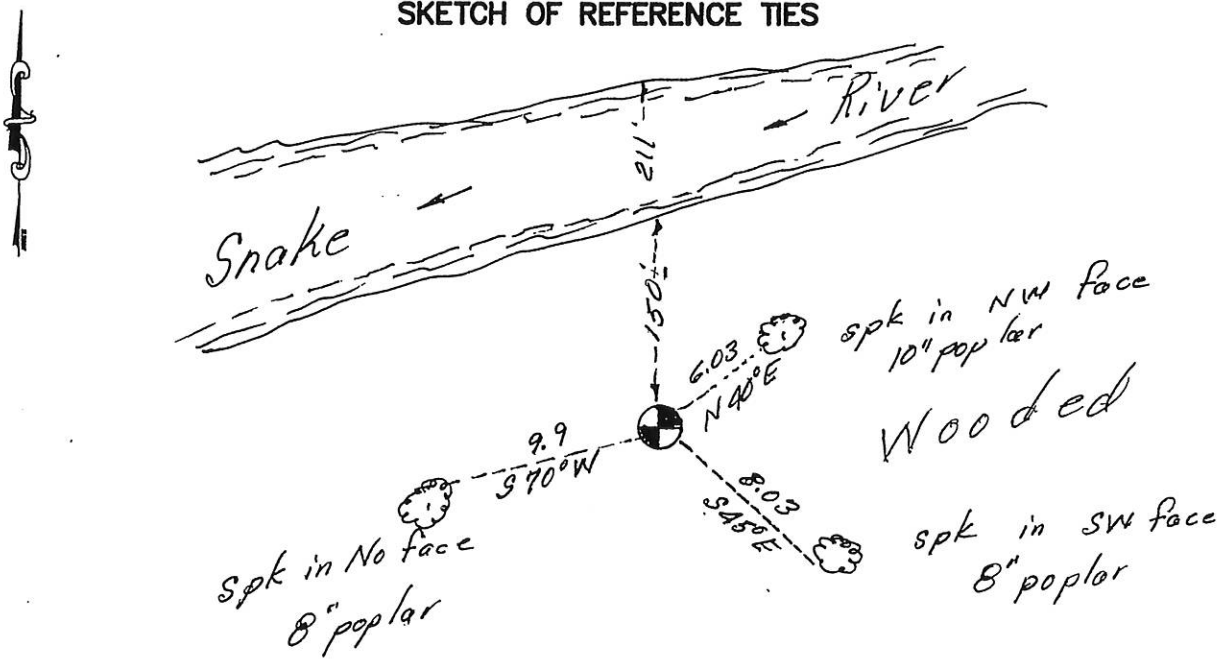

Statement of evidence relative to this corner location is on back of page.

I hereby certify that this document and the data contained herein was prepared by me or under my direct supervision.

Ernest L. Rud May 1, 2014  
Signature Date

Registration No. 9808

- Land Surveyor,       Professional Engineer
- County Surveyor,     County Engineer

### OFFICE OF THE COUNTY RECORDER

County of \_\_\_\_\_

I hereby certify that this document was filed in the County Recorder's office at \_\_\_\_\_ M. on the \_\_\_\_\_ day of \_\_\_\_\_ A.D., 20\_\_\_\_

County Recorder \_\_\_\_\_

BY \_\_\_\_\_ Deputy

DOCUMENT NO. \_\_\_\_\_

Northwest Corner Section 19, Township 42, Range 22	4222031
Northeast Corner Section 24, Township 42, Range 23	4223007

The original Government post was set by U.S. Deputy Surveyor in November, 1849 and 4 bearing trees noted as being;

10" Balsam bearing South 10° West at 38 Links

8" Elm bearing North 45° West at 6 Links

7" Balsam bearing North 60° East at 35 Links

8" Balsam bearing South 8° East at 17 Links

No evidence for post or bearing trees could be found.

This corner falls in a heavily wooded area with no occupation lines in the vicinity. It is approximately 150 feet south of the Snake River. No records of subsequent surveys could be found at Kanabec County Offices or the D.N. R. Therefore we considered this to be a last corner and set it on line and equidistant from the Northeast corner of Section 13 to the Northeast corner of Section 25. A #7 x 24" rebar with an aluminum cap was set, ties were taken and Kanabec County Coordinates established on this position.