

CERTIFICATE OF LOCATION OF GOVERNMENT CORNER

E44
 West Quarter _____ Corner of Section 13¹⁸, Township 42, Range 21²², 4 P.M.

STATE OF MINNESOTA, County of Pine ~~KANABEC~~

At the corner location shown on the sketch

On _____ found a _____
Date

left monument as found, lowered monument, removed monument (explain)

On 12-7-00 placed a 7/8" X 24" Capped Rebar
Date

SKETCH OF REFERENCE TIES

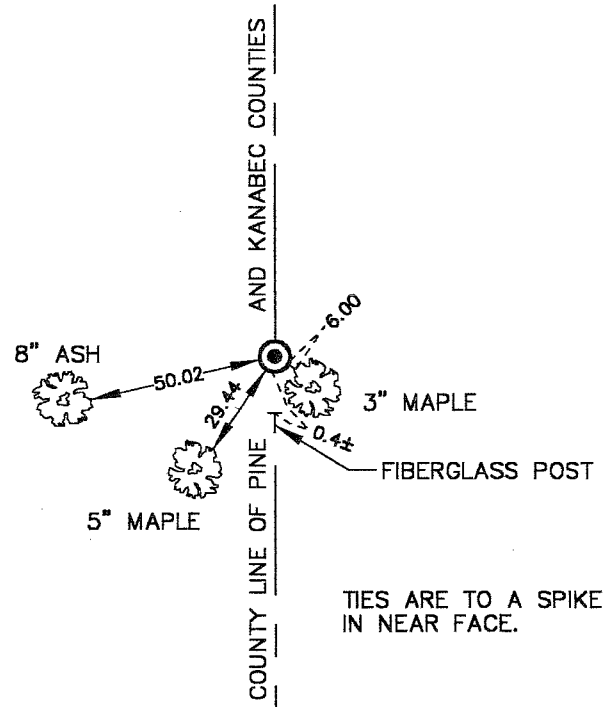

MNDOT PINE COUNTY COORDINATE SYSTEM
 (NAD83 HARN 96 ADJUSTMENT)
 NORTHING = 242950.27
 EASTING = 460867.10

Statement of evidence relative to this corner location is on back of page.

I hereby certify that this document and the data contained herein was prepared by me or under my direct supervision.

M.A. R... 12-14-00
Signature Date

Registration No. 8195

Land Surveyor, Professional Engineer
 County Surveyor, County Engineer

OFFICE OF THE COUNTY RECORDER

County of _____

I hereby certify that this document was filed in the County Recorder's office at _____ M. on the _____ day of _____ A.D., 19 _____

County Recorder _____
 By _____ Deputy

DOCUMENT NO. _____

J/6

LAND CORNER HISTORY

W 1/4. Corner of Section 18 Township 42 Range 21

All of the original bearing trees are now gone.

In March of 2000 we ran a survey along the west line of T. 42 R. 21 and corners east and west of the township line to locate existing monuments, lines of occupation and search areas.

There is no resurvey data on file in the Pine or Kanabec court house for this corner.

There are no definite lines of occupation near this corner.

We set this corner midway and on line between the NW and SW corners of section 18.