

# CERTIFICATE OF LOCATION OF GOVERNMENT CORNER

N 1/4 Corner of Section 19, Township 40, Range 24, 4<sup>TH</sup> P.M.

STATE OF MINNESOTA, County of KANABEC

At the corner location shown on the sketch:

SET- REBAR AND ALUMINUM CAP.  
WITH FENCE POST

12-11-13

Kanabec County U.S. Survey Feet Coordinates  
NAD 1983, HARN 1996 Adjustment  
Obtained by RTK GPS Observation

Northing= 179604.670  
Easting= 377752.790

Note: NAD 1983, HARN 1996 Adjustment  
coordinates are NOT compatible with  
NAD 1983 coordinates  
Note: 1 Meter=3937/1200 U.S. Survey Feet

## SKETCH OF REFERENCE TIES

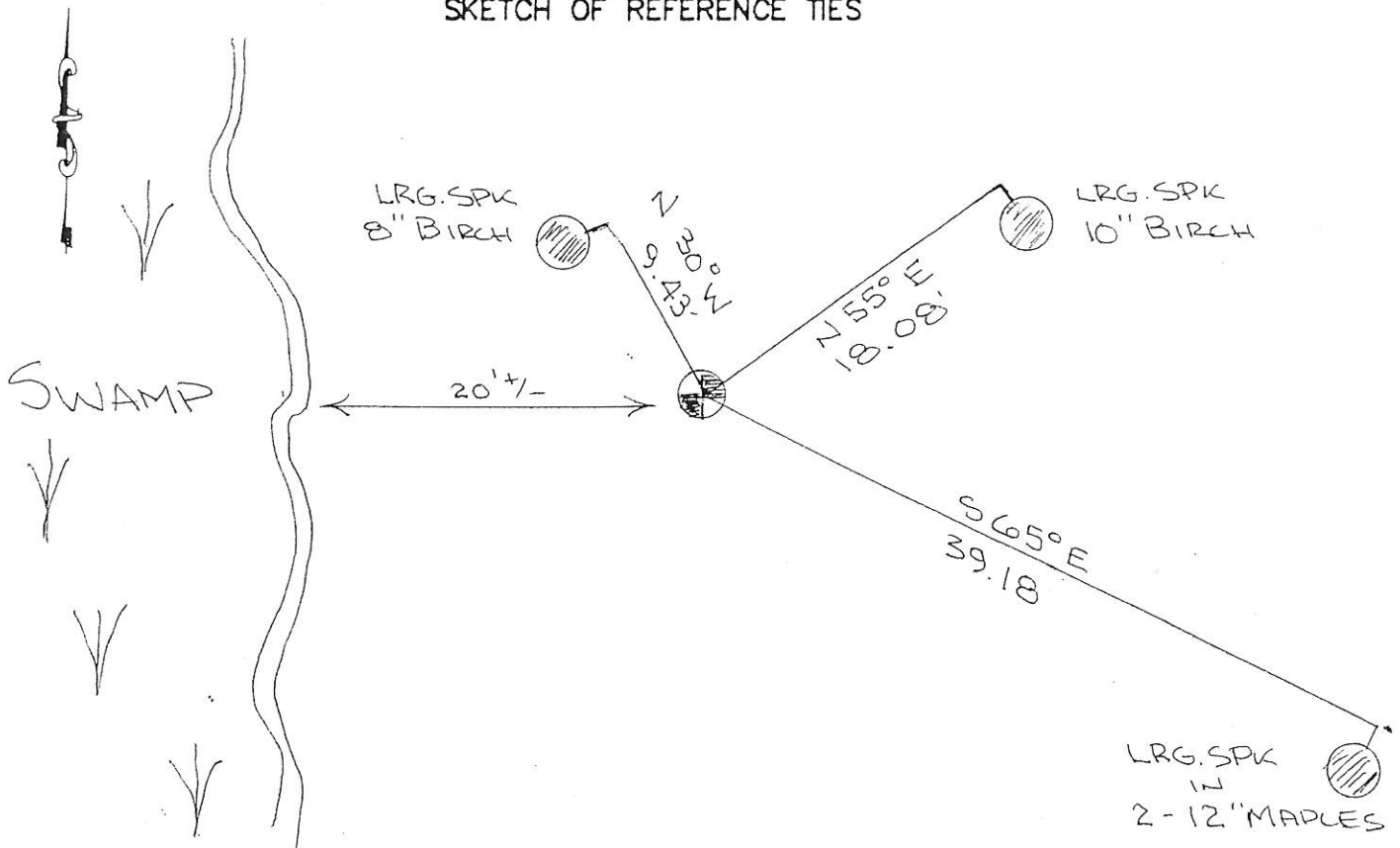

Statement of evidence relative to this corner location is on back of page.

I hereby certify that this document and the data contained herein was prepared by me or under my direct supervision.

Ernest J. Reed  
Signature

Dec 23, 2013  
Date

Registration No. 9808

- Land Surveyor,       Professional Engineer  
 County Surveyor,     County Engineer

## OFFICE OF THE COUNTY RECORDER

County of \_\_\_\_\_

I hereby certify that this document was filed in the County Recorder's office at \_\_\_\_\_ M. on the \_\_\_\_\_ day of \_\_\_\_\_ A.D., 20\_\_\_\_

County Recorder \_\_\_\_\_  
BY \_\_\_\_\_ Deputy

DOCUMENT NO. \_\_\_\_\_

The original Government post was set on October 20, 1855 by Deputy Surveyor Silas Barnard and 2 bearing trees noted as:

10" Poplar bearing North at 24 links

8" Maple bearing South 27 degrees East 20 links

No evidence could be found for the post or bearing trees. There are no lines of occupation in the near vicinity. No records of any previous surveys could be found at the Kanabec County Offices. Therefore we set this corner on line and at a proportional distance between the northeast and the northwest corners of Section 19. A #7 rebar with an aluminum cap was set, ties taken and Kanabec County Coordinates established on this position. A fence post was set close to the monument.