

# CERTIFICATE OF LOCATION OF GOVERNMENT CORNER

NORTH QUARTER Corner of Section 30, Township 40, Range 24, 4TH P.M.  
STATE OF MINNESOTA, County of KANABEC

At the corner location shown on the sketch:  
ON 11/25/2013 SET A PK NAIL IN BITUMINOUS.

Kanabec County U.S. Survey Feet Coordinates  
NAD 1983, HARN 1996 Adjustment  
Obtained by RTK GPS Observation

Northing= 174313.55

Easting= 377762.01

Note: NAD 1983, HARN 1996 Adjustment  
coordinates are NOT compatible with  
NAD 1983 coordinates

Note: 1 Meter=3937/1200 U.S. Survey Feet

## SKETCH OF REFERENCE TIES

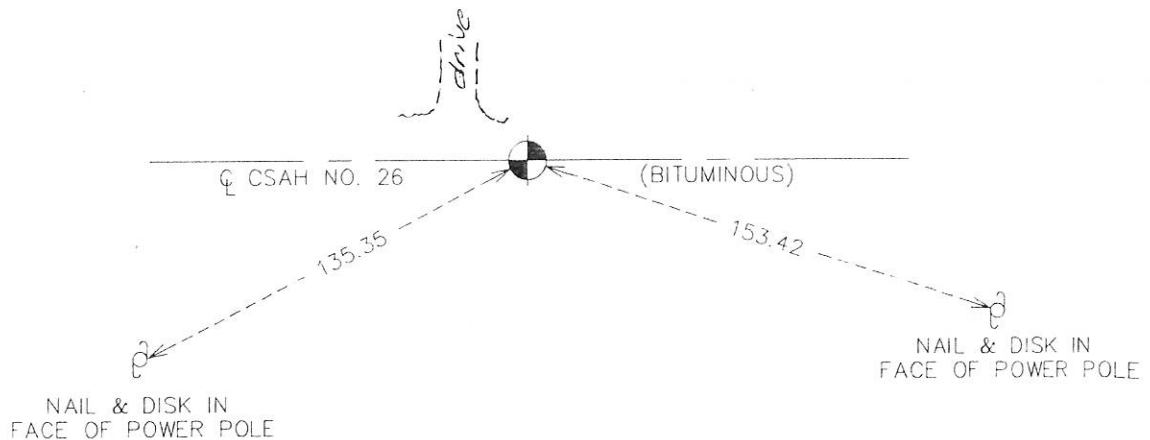

Statement of evidence relative to this corner location is on back of page.

I hereby certify that this document and the data contained herein was prepared by me or under my direct supervision.

*Ernest [Signature]*  
Signature

12-23-13  
Date

Registration No. 9800

Land Surveyor, [ ] Professional Engineer  
[ ] County Surveyor, [ ] County Engineer

## OFFICE OF THE COUNTY RECORDER

County of \_\_\_\_\_

I hereby certify that this document was filed in the County Recorder's office at \_\_\_\_\_ M. on the \_\_\_\_\_ day of \_\_\_\_\_ A.D., 20 \_\_\_\_\_

County Recorder \_\_\_\_\_

BY \_\_\_\_\_ Deputy

DOCUMENT NO. \_\_\_\_\_

From Tie Sheet 616

All of the original bearing trees are now gone.

In October of 1981, MB Rude ran a survey along the south line of Section 19 to locate the lines of occupation.

There are no lines of occupation north or south at this corner.

On October 8, 1981, he made an excavation with the County backhoe in the east-west road and at a proportional measurement location.

No evidence was found in the excavation.

He set this corner on line and single proportional measurement between the Northeast and Northwest corner of Section 19.

From Tie Sheet 616A

All reference ties were intact.

The roadway was regarded in 1994. The Kanabec County Highway Department located the section corner prior to construction and placed additional references outside of the new construction limits.

Before the roadway was paved in 1995, the corner was reestablished according to references obtained previously and placed additional references.

On November 25, 2013 E.G. Rud and Sons reestablished this corner from remaining ties and established Kanabec County Coordinates on this position.