

CERTIFICATE OF LOCATION OF GOVERNMENT CORNER

NORTHEAST Corner of Section 30, Township 40, Range 24, 4TH P.M.
 STATE OF MINNESOTA, County of KANABEC

At the corner location shown on the sketch:
 ON 11/25/2013 SET A PK NAIL IN BITUMINOUS.

Kanabec County U.S. Survey Feet Coordinates
 NAD 1983, HARN 1996 Adjustment
 Obtained by RTK GPS Observation

Northing= 174264.32

Easting= 380413.78

Note: NAD 1983, HARN 1996 Adjustment
 coordinates are NOT compatible with
 NAD 1983 coordinates

Note: 1 Meter=3937/1200 U.S. Survey Feet

SKETCH OF REFERENCE TIES

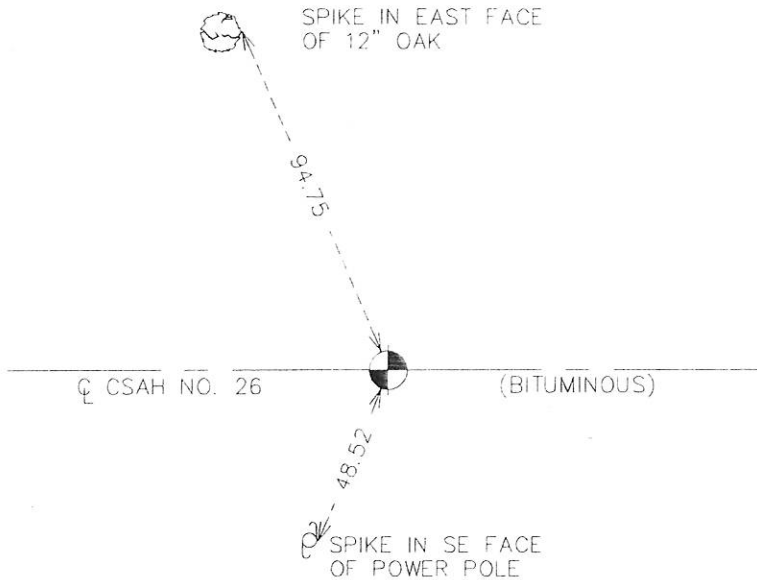

Statement of evidence relative to this corner location is on back of page.

I hereby certify that this document and the data contained herein was prepared by me or under my direct supervision.

Erest J. Paul
 Signature

12-23-13
 Date

Registration No. 9808

Land Surveyor, Professional Engineer

County Surveyor, County Engineer

OFFICE OF THE COUNTY RECORDER

County of _____

I hereby certify that this document was filed in the County Recorder's office at _____ M. on the

_____ day of _____ A.D., 20__

County Recorder _____

BY _____ Deputy

DOCUMENT NO. _____

Northeast Corner Section 30

4024118

From Tie Sheet 378A

All reference ties were intact.

The roadway was regarded in 1994. The Kanabec County Highway Department located the section corner prior to construction and placed additional references outside of the new construction limits.

Before the roadway was paved in 1995, the corner was reestablished according to references obtained previously and placed additional references.

On November 25, 2013 E.G. Rud and Sons reestablished this corner from remaining ties and established Kanabec County Coordinates on this position.