

CERTIFICATE OF LOCATION OF GOVERNMENT CORNER

NORTH QUARTER Corner of Section 27, Township 40, Range 24, 4TH P.M.
STATE OF MINNESOTA, County of KANABEC

At the corner location shown on the sketch:
FOUND A 7/8 INCH BY 24 INCH REBAR WITH AN ALUMINUM
KANABEC COUNTY CAP

Kanabec County U.S. Survey Feet Coordinates
NAD 1983, HARN 1996 Adjustment
Obtained by RTK GPS Observation

Northing= 174341.15
Easting= 393456.31

Note: NAD 1983, HARN 1996 Adjustment
coordinates are NOT compatible with
NAD 1983 coordinates
Note: 1 Meter=3937/1200 U.S. Survey Feet

SKETCH OF REFERENCE TIES

TIES ARE TO SPIKE IN BLAZE IN NEAR FACE

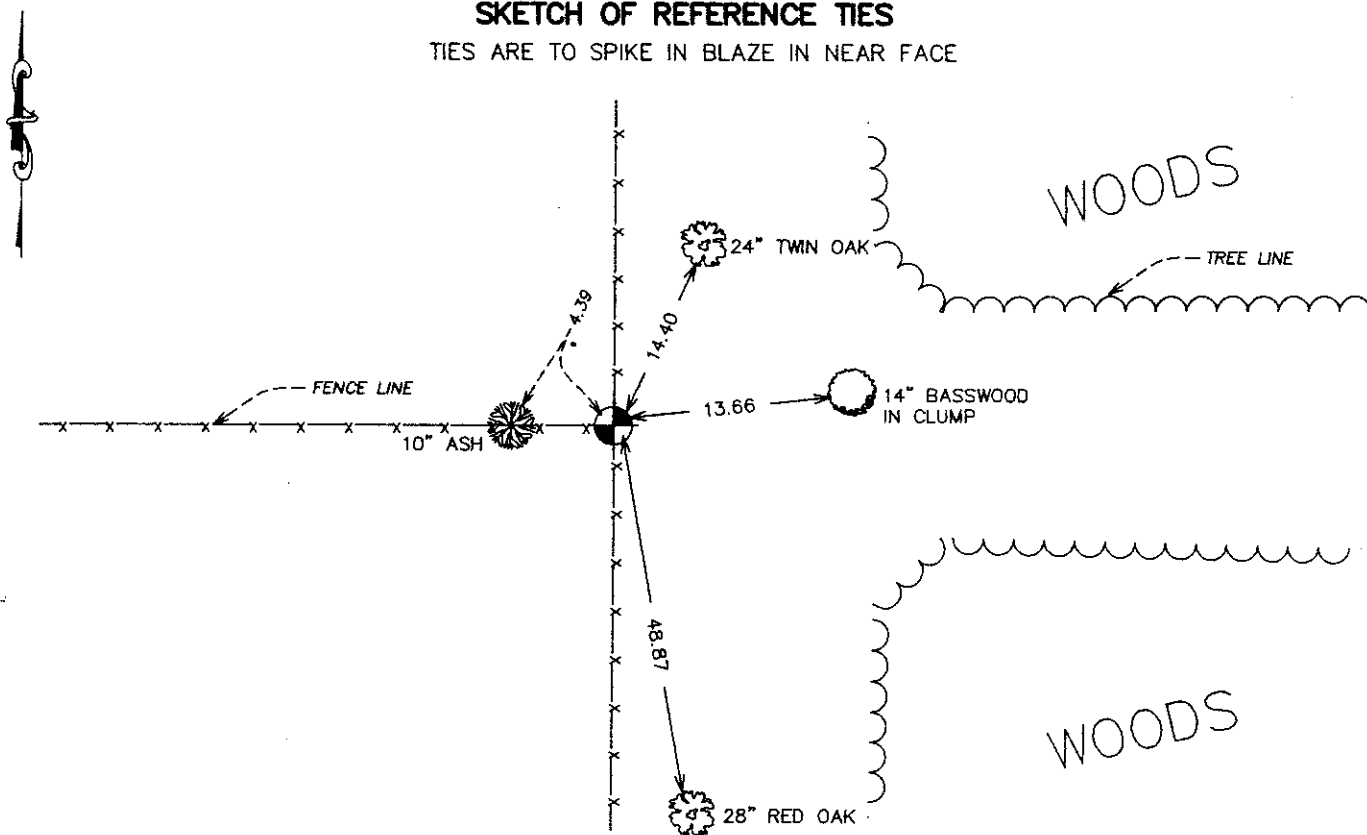

Statement of evidence relative to this corner location is on back of page.

I hereby certify that this document and the data contained herein was prepared by me or under my direct supervision.

Ernest J. Reed
Signature

3-31-2008
Date

Registration No. 9808

Land Surveyor, [] Professional Engineer

[] County Surveyor, [] County Engineer

OFFICE OF THE COUNTY RECORDER

County of _____

I hereby certify that this document was filed in the County Recorder's office at _____ M. on the

_____ day of _____ A.D., 20 _____

County Recorder _____

BY _____ Deputy

DOCUMENT NO. _____

NORTH QUARTER CORNER SECTION 27, TOWNSHIP 40, RANGE 24

STATEMENT OF EVIDENCE

ALL GOVERNMENT BEARING TREES ARE NOW GONE. THERE ARE NO RE-SURVEY NOTES ON FILE FOR THIS CORNER.

ON FEBRUARY 9, 2005, DALE ANDERSON SEARCHED THE AREA AROUND THE INTERSECTION OF A NORTH-SOUTH FENCELINE AND A FENCELINE ~~RUNNING~~ WEST. NO EVIDENCE OF THE ORIGINAL CORNER WAS FOUND. *running*

ON FEBRUARY 9, 2005 HE SET A 7/8 INCH BY 24 INCH REBAR WITH AN ALUMINUM KANABEC COUNTY CAP AT THE BASE OF AN OLD FENCE CORNER POST FLUSH WITH THE SURFACE. FOUR REFERENCE TIES WERE MADE TO A SPIKE IN A BLAZE IN THE SIDE OF THE AS SHOWN ON THE CERTIFICATE. THIS POSITION WAS ACCEPTED AS THE PERPETUATED CORNER LOCATION.

ON FEBRUARY 5, 2008 E.G. RUD & SONS, INC. FOUND THIS MONUMENT AND KANABEC COUNTY COORDINATES WERE ESTABLISHED ON THIS POSITION USING GLOBAL POSITIONING SYSTEM (G.P.S.) EQUIPMENT.