

CERTIFICATE OF LOCATION OF GOVERNMENT CORNER

NORTHEAST Corner of Section 34, Township 40, Range 24, 4TH P.M.
STATE OF MINNESOTA, County of KANABEC

At the corner location shown on the sketch:
FOUND A RAILROAD SPIKE IN BRIDGE DECK.

Kanabec County U.S. Survey Feet Coordinates
NAD 1983, HARN 1996 Adjustment
Obtained by RTK GPS Observation

Northing= 169218.61

Easting= 396220.58

Note: NAD 1983, HARN 1996 Adjustment
coordinates are NOT compatible with
NAD 1983 coordinates

Note: 1 Meter=3937/1200 U.S. Survey Feet

SKETCH OF REFERENCE TIES

TIES ARE TO SPIKE IN TOP OF END GUARD RAIL BRACES

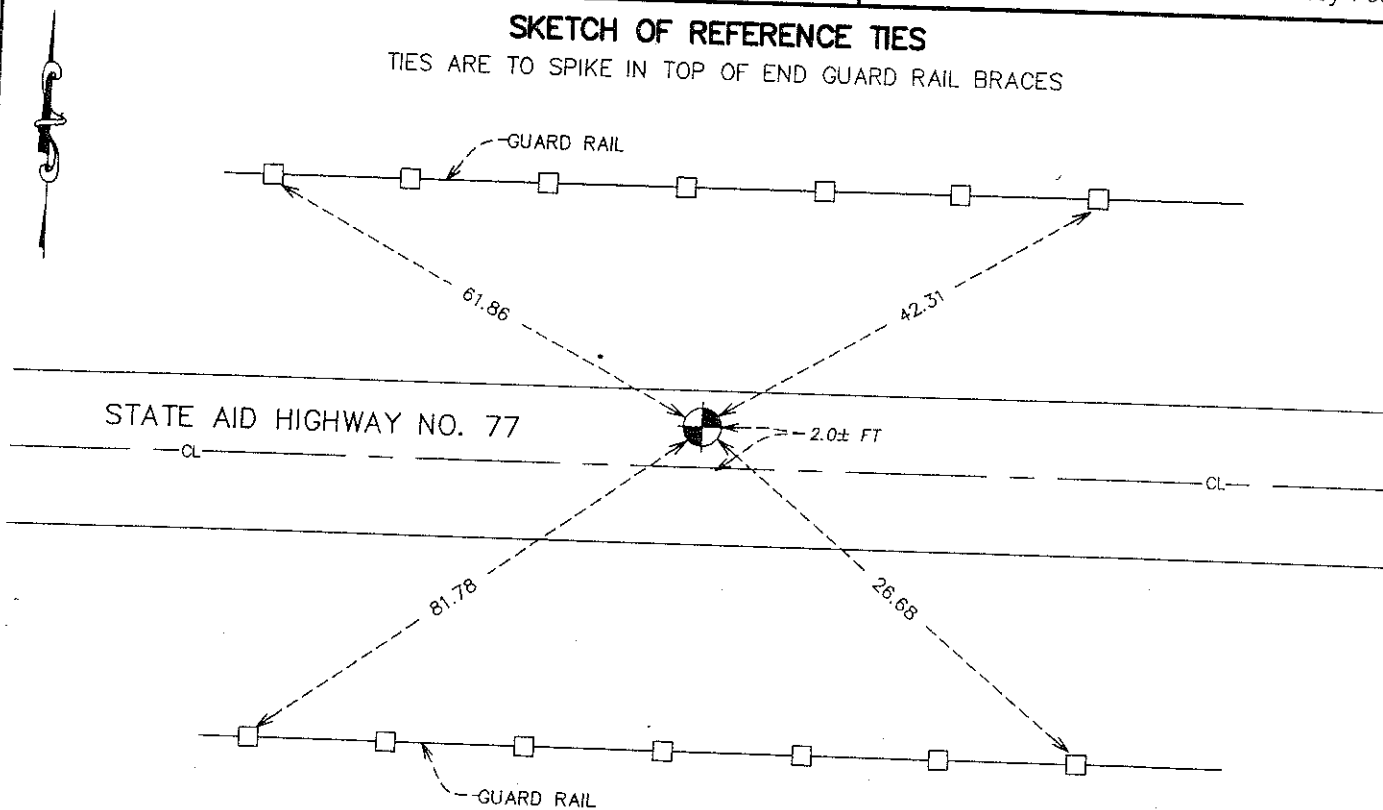

Statement of evidence relative to this corner location is on back of page.

I hereby certify that this document and the data contained herein was prepared by me or under my direct supervision.

Ernest J. Dred
Signature

2-07-2008
Date

Registration No. 9808

Land Surveyor, Professional Engineer

County Surveyor, County Engineer

OFFICE OF THE COUNTY RECORDER

County of _____

I hereby certify that this document was filed in the County Recorder's office at _____ M. on the _____ day of _____ A.D., 20____

County Recorder _____

BY _____ Deputy

DOCUMENT NO. _____

NORTHEAST CORNER SECTION 34, TOWNSHIP 40, RANGE 24

STATEMENT OF EVIDENCE

ALL OF THE ORIGINAL GOVERNMENT BEARING TREES ARE NOW GONE. ALLEVIDENCE WAS DESTROYED BY THE CONSTRUCTION OF A BRIDGE OVER THE KNIFE RIVER.

CHARLES HANDSCH'S SURVEY RECORDS IN THE NORTHWEST QUARTER OF THE NORTHWEST QUARTER OF SECTION 34 DATED IN 1931, SHOWS AN IRON MONUMENT AT THIS CORNER AND A DISTANCE ALONG THE NORTH LINE OF THE NORTHWEST QUARTER OF THE NORTHWEST QUARTER AND THE SOUTH LINE OF THE NORTHWEST QUARTER OF THE NORTHWEST QUARTER. THIS IRON MONUMENT WAS DESTROYED IN BRIDGE CONSTRUCTION.

THIS CORNER WAS RESET BY RECONSTRUCTING HANDSCHU'S SURVEY AND SUBDIVISION IN SECTION 35, DATED IN 1931, BY USING HIS ANGLE OF 89 DEGREES 13 MINUTES AT THE NORTHWEST CORNER AND 90 DEGREED 15 MINUTES AT THE NORTH QUARTER CORNER OF SECTION 35. THE DISTANCE ALONG THE NORTH AND SOUTH LINES OF THE NORTHWEST QUARTER OF THE NORTHWEST QUARTER ARE WITHIN 2 FEET OF HANDSCHU'S RECORDS OF 1931.

IN 2004 E.G. RUD & SONS, INC. ESTABLISHED KANABEC COUNTY COORDINATES ON THIS POSITION USING GLOBAL POSITIONING SYSTEM (G.P.S.) EQUIPMENT.