

# CERTIFICATE OF LOCATION OF GOVERNMENT CORNER

WITNESS COR. SOUTHWEST Corner of Section 1, Township 40, Range 24, 4TH P.M.

STATE OF MINNESOTA, County of KANABEC

At the corner location shown on the sketch:

RESET THE WITNESS CORNER  
AND ESTABLISHED KANABEC COUNTY COORDINATES ON ITS LOCATION.

Kanabec County U.S. Survey Feet Coordinates  
NAD 1983, HARN 1996 Adjustment  
Obtained by RTK GPS Observation

Northing= 190382.08

Easting= 401651.37

Note: NAD 1983, HARN 1996 Adjustment  
coordinates are NOT compatible with  
NAD 1983 coordinates

Note: 1 Meter=3937/1200 U.S. Survey Feet

## SKETCH OF REFERENCE TIES

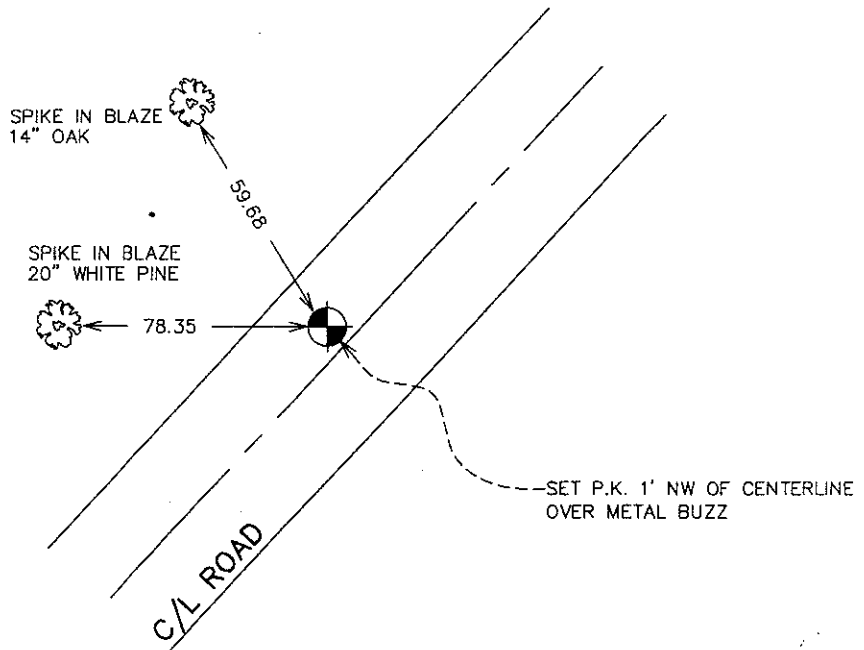

WITNESS CORNER

Northing= 190341.72

Easting= 402105.41

Statement of evidence relative to this corner location is on back of page.

I hereby certify that this document and the data contained herein was prepared by me or under my direct supervision.

*Ernest M. ...*  
Signature

10-05-2007  
Date

Registration No. 9808

Land Surveyor,      [ ] Professional Engineer

[ ] County Surveyor,      [ ] County Engineer

### OFFICE OF THE COUNTY RECORDER

County of \_\_\_\_\_

I hereby certify that this document was filed in the County Recorder's office at \_\_\_\_\_ M. on the

\_\_\_\_\_ day of \_\_\_\_\_ A.D., 20\_\_

County Recorder \_\_\_\_\_

BY \_\_\_\_\_ Deputy

**DOCUMENT NO.** \_\_\_\_\_

SOUTHWEST CORNER SECTION 1, T40, R24

**STATEMENT OF EVIDENCE**

IN 1977 M.B. RUDE COMPUTED THE SOUTHWEST CORNER OF SECTION 1 FROM THE HANDSCHU SURVEY OF 1927. THIS LOCATION FITS THE CENTERLINE OF THE ROAD SOUTH EXTENDED NORTH, AND PLAT IRONS NORTH EXTENDED SOUTH, AND FENCE LINE EAST EXTENDED WEST.

THE CORNER FALLS IN THE SWAMP. TOO WET TO SET THE ACTUAL CORNER.

IN FEBRUARY 2005 E.G. RUD RESET THE WITNESS CORNER FROM M.B. RUD'S TIES AND ESTABLISHED KANABEC COUNTY COORDINATES ON THIS POSITION AND COMPUTED COORDINATES FOR THE SOUTHWEST CORNER OF SECTION 1.