

CERTIFICATE OF LOCATION OF GOVERNMENT CORNER

NE Corner of Section 12, Township 40, Range 24, 4TH P.M.
STATE OF MINNESOTA, County of KANABEC

At the corner location shown on the sketch

On 11-21-96 found a 1/2" PINCHED IRON PIPE
Date

left monument as found, lowered monument, removed monument (explain)

On 11-21-96 placed a 7/8" x 36" CAPPED REBAR
Date

SKETCH OF REFERENCE TIES

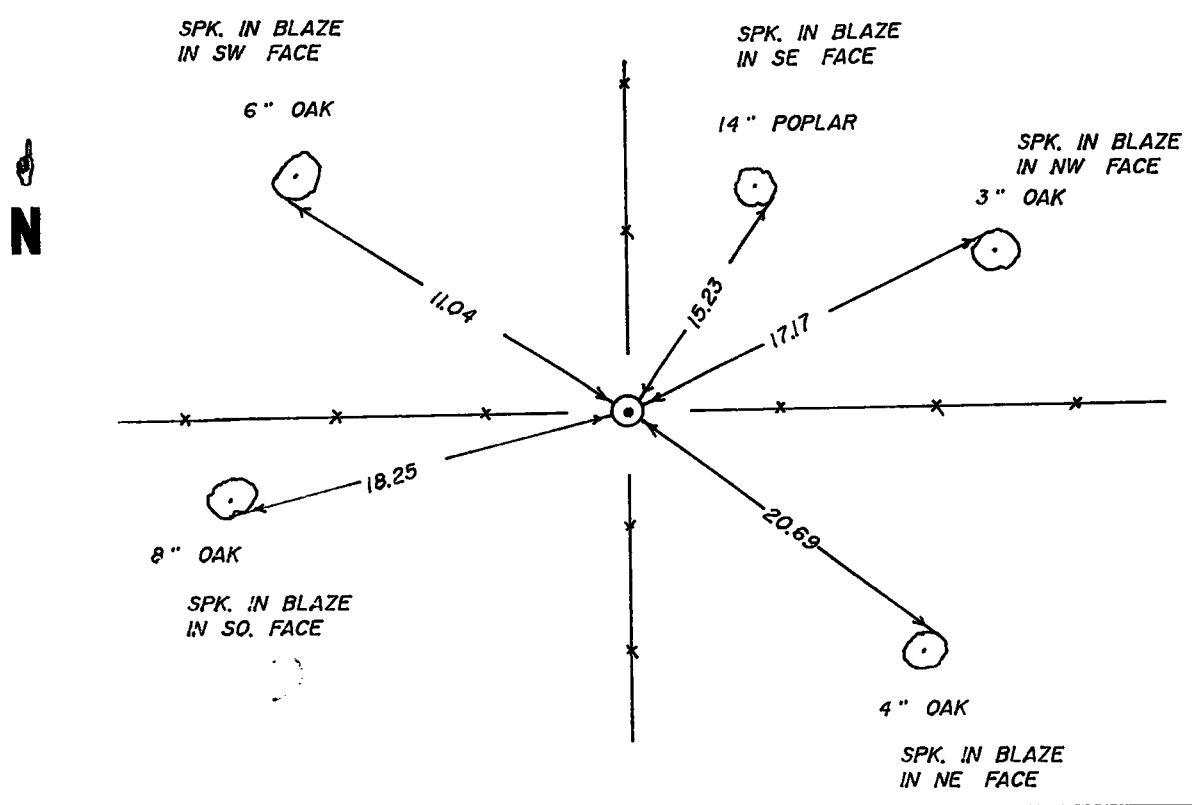

Statement of evidence relative to this corner location is on back of page.

I hereby certify that this document and the data contained herein was prepared by me or under my direct supervision.

M. G. [Signature] 12-10-96
Signature Date

Registration No. 8195

Land Surveyor, Professional Engineer
 County Surveyor, County Engineer

OFFICE OF THE COUNTY RECORDER

County of Kanabec

I hereby certify that this document was filed in the County Recorder's office at 2:00 P M. on the

23rd day of January A.D., 19 97

County Recorder Rhonda A. Olson

By _____ Deputy

DOCUMENT NO. _____

90

STATEMENT OF EVIDENCE

All of the original government bearing trees are now gone.

Charles Handschu, RLS, made a survey in Section 7, Township 40, Range 23, filed at the Kanabec County Surveyor's Office. There is no date on this survey approximately in the 1930's or 1940's. These records show a post at this corner.

Frank Kvidera, RLS, made a plat in 1968 and his records show a iron pipe at this corner.

In 1975, we found a pinched tip 1/2" iron pipe at this corner at a four-way fence corner and used this location in a survey in Sections 6 and 7, Township 40, Range 23.

On November 21, 1996, I found the pinched 1/2" iron pipe and replaced it with a 7/8" capped rebar at the perpetuated location of this corner.