

# CERTIFICATE OF LOCATION OF GOVERNMENT CORNER

NORTH QUARTER Corner of Section 32, Township 39, Range 25, 4TH P.M.  
 STATE OF MINNESOTA, County of KANABEC

At the corner location shown on the sketch:  
 SET 1/2" X 24" PIPE WITH ALUMINUM CAP AT INTERSECTION  
 OF FENCES.

Kanabec County U.S. Survey Feet Coordinates  
 NAD 1983, HARN 1996 Adjustment  
 Obtained by RTK GPS Observation

Northing= 138725.42

Easting= 351281.40

Note: NAD 1983, HARN 1996 Adjustment  
 coordinates are NOT compatible with  
 NAD 1983 coordinates

Note: 1 Meter=3937/1200 U.S. Survey Feet

## SKETCH OF REFERENCE TIES

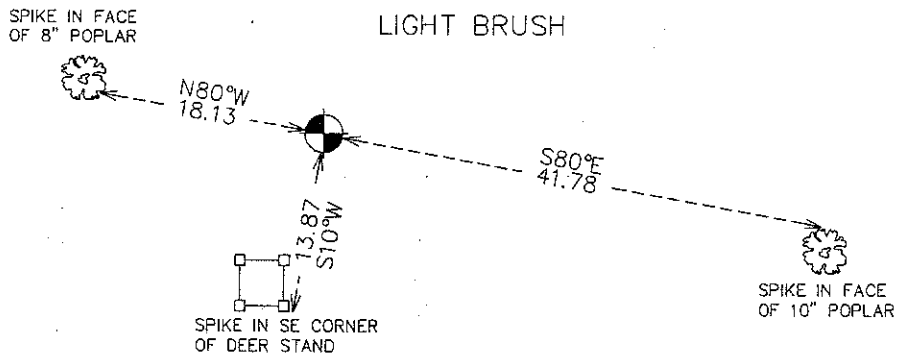

Statement of evidence relative to this corner location is on back of page.

I hereby certify that this document and the data contained herein was prepared by me or under my direct supervision.

Ernest Rud 12-21-2010  
 Signature Date

Registration No. 9808

Land Surveyor,  Professional Engineer

County Surveyor,  County Engineer

### OFFICE OF THE COUNTY RECORDER

County of \_\_\_\_\_

I hereby certify that this document was filed in the County Recorder's office at \_\_\_\_\_ M. on the

\_\_\_\_\_ day of \_\_\_\_\_ A.D., 20\_\_

County Recorder \_\_\_\_\_

BY \_\_\_\_\_ Deputy

DOCUMENT NO. \_\_\_\_\_

N1/4 CORNER, SEC. 32, T39, R25

**STATEMENT OF EVIDENCE**

THE ORIGINAL CORNER POST WAS SET ON MARGIN OF MARSH BY DEPUTY SURVEYOR SILAS BARNARD ON JULY 6, 1855 AND 2 BEARING TREES ESTABLISHED AS FOLLOWS:

9" SUGAR MAPLE BEARING N48°W @ 12 LINKS

21" PINE BEARING SOUTH @ 25 LINKS

NO VISIBLE EVIDENCE REMAINS TODAY FOR THE CORNER OR BEARING TREES.

THERE IS A ROAD OPENING ON FILE AT THE KANABEC COUNTY AUDITOR'S OFFICE DATED MAY 13, 1905 ALONG THE NORTH LINE OF SEC. 32, BUT NO SURVEY WAS MADE.

IN BOOK A OF SURVEYS AT THE KANABEC COUNTY OFFICES THERE IS A SURVEY RECORDED BY JOHN NELSON ON PAGES 292 & 293 DATED APRIL 8-12, 1901 FOR SEC. 32. JOHN SET A POST AT THE N1/4 CORNER OF SEC. 32 AND TOOK 2 TIES:

24" PINE STUMP BEARING N55°E @ 52 LINKS

30" PINE STUMP BEARING S84°30'E @ 101 LINKS

NO EVIDENCE OF THE PINE STUMPS COULD BE FOUND TODAY.

ON NOV. 23, 2010 E.G. RUD AND SONS, INC. RAN A SURVEY ALONG THE NORTH LINE OF SEC. 32 TO ESTABLISH THIS CORNER. OLD FENCE WAS FOUND RUNNING EAST FROM THIS CORNER. OLD BARBED WIRE WAS FOUND 3"-6" DOWN AND MARKED WITH LATHE. THE OLD FENCE FELL VERY CLOSE TO A STRAIGHT LINE BETWEEN THE NE AND NW CORNERS OF SEC. 32. EVIDENCE OF AN OLD CORNER FENCE POST AND GUY WIRE WAS FOUND RUNNING NORTH IN THIS LOCATION. THIS FENCE FELL 10'± WEST OF A SPLIT BETWEEN THE NE AND NW CORNERS OF SEC. 32. THIS WAS CONSIDERED TO BE THE BEST EVIDENCE FOR THE PERPETUATION OF THIS CORNER. A 1/2" IRON PIPE WITH AN ALUMINUM CAP WAS SET, TIES TAKEN AND KANABEC COUNTY COORDINATES WERE ESTABLISHED ON THIS POSITION.