

# CERTIFICATE OF LOCATION OF GOVERNMENT CORNER

NORTH QUARTER Corner of Section 27, Township 39, Range 25, 4TH P.M.

STATE OF MINNESOTA, County of KANABEC

At the corner location shown on the sketch:  
*Found Sandstone with "X"*  
 SET #7 REBAR WITH ALUMINUM CAP  
 AND ESTABLISHED KANABEC COUNTY COORDINATES ON ITS LOCATION.

Kanabec County U.S. Survey Feet Coordinates  
 NAD 1983, HARN 1996 Adjustment  
 Obtained by RTK GPS Observation

Northing= 143221.98  
 Easting= 361875.83

Note: NAD 1983, HARN 1996 Adjustment  
 coordinates are NOT compatible with  
 NAD 1983 coordinates  
 Note: 1 Meter=3937/1200 U.S. Survey Feet

### SKETCH OF REFERENCE TIES

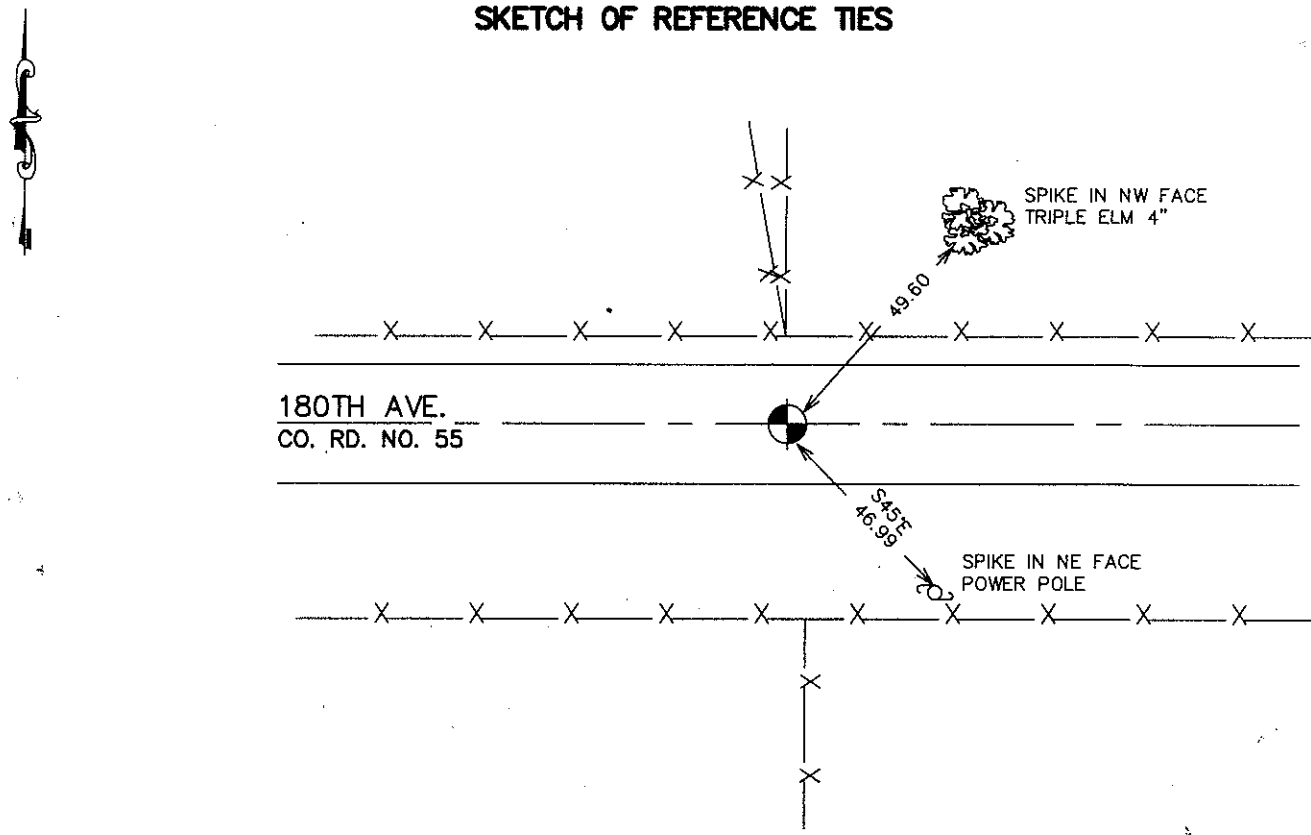

Statement of evidence relative to this corner location is on back of page.

I hereby certify that this document and the data contained herein was prepared by me or under my direct supervision.

*Ernest Shred* 10-05-2007  
 Signature Date

Registration No. Minn No 9808

- Land Surveyor,     Professional Engineer  
 County Surveyor,     County Engineer

### OFFICE OF THE COUNTY RECORDER

County of \_\_\_\_\_

I hereby certify that this document was filed in the County Recorder's office at \_\_\_\_\_ M. on the \_\_\_\_\_ day of \_\_\_\_\_ A.D., 20\_\_\_\_

County Recorder \_\_\_\_\_

BY \_\_\_\_\_ Deputy

DOCUMENT NO. \_\_\_\_\_

# NORTH QUARTER CORNER SECTION 27, T39, R25

## STATEMENT OF EVIDENCE

THE ORIGINAL CORNER WAS SET BY DEPUTY SURVEYOR SILAS BARNARD ON JULY 1, 1855 AND TWO BEARING TREES ESTABLISHED – NO VISIBLE EVIDENCE REMAINS FOR THE CORNER OR BEARING TREE.

THERE IS A ROAD OPENING DATED NOV. 30, 1910 ALONG THE WEST LINE OF SECTION 27 AND A ROAD OPENING ALONG THE NORTH SIDE OF SECTION 27 DATED SEPTEMBER 1, 1902.

IN BOOK A1 OF SURVEYS PAGES 86 AND 87 JOHN NELSON RECORDED A SURVEY OF SECTION 27 DATED APRIL 14, 1911. ON THIS SURVEY HE STATES SETTING A SANDSTONE AT THIS CORNER AND MEASURING A TOTAL DISTANCE OF 80.66 CHAINS OR 5323.56 FEET ALONG THE NORTH LINE. ON THE WEST LINE OF SECTION 27 NELSON MEASURED 80.84 CHAINS OR 5335.44 FEET. E.G. RUD MEASURED 5345.65 ALONG THE WEST LINE AND 5343.79 ALONG THE NORTH LINE OF SECTION 27.

IN JULY 2007 E.G. RUD AND SONS RAN A SURVEY AROUND SECTIONS 22 & 27 TO LOCATE EXISTING MONUMENTATION, LINES OF OCCUPATION AND TO DETERMINE SEARCH AREAS. A DISTANCE OF 5343.79 WAS MEASURED FROM NORTHWEST TO NORTHEAST CORNERS.

THERE IS A FENCE RUNNING NORTH AND A GRAVEL ROAD RUNNING EAST-WEST. BOGART PETERSON SET A 1/2" IRON PIPE ON LINE AND SPLIT FOR A SURVEY IN SECTION 22. THIS FITS THE FENCE LINE AND CENTERLINE OF ROAD VERY WELL.

ON AUGUST 22, 2007 AN EXCAVATION WAS MADE WITH THE COUNTY BACKHOE. A 12' BY 16' EXCAVATION 2' DEEP AND INTO NATURAL GROUND WAS MADE. AT 5 INCHES DOWN BOGART PETERSONS PIPE WAS FOUND. THE PIPE WAS TIED OUT AND EXCAVATION CONTINUED. AT 18" AND AT NATURAL GROUND A SANDSTONE ROCK WITH A CHISELED X WAS FOUND. THIS FIT BOGART PETERSONS 1/2 INCH IRON PIPE WITHIN 0.3' OF A FOOT.

A #7 REBAR WAS SET, TIES TAKEN AND KANABEC COUNTY COORDINATES OBTAINED ON THE POSITION.