

CERTIFICATE OF LOCATION OF GOVERNMENT CORNER

NORTH QUARTER Corner of Section 26, Township 39, Range 25, 4TH P.M.

STATE OF MINNESOTA, County of KANABEC

At the corner location shown on the sketch:
On 01/ /2004 Found a Kanabec County Monument.

Kanabec County U.S. Survey Feet Coordinates
NAD 1983, HARN 1996 Adjustment
Obtained by RTK GPS Observation

Northing= 142870.39

Easting= 367224.56

Note: NAD 1983, HARN 1996 Adjustment
coordinates are NOT compatible with
NAD 1983 coordinates

Note: 1 Meter=3937/1200 U.S. Survey Feet

SKETCH OF REFERENCE TIES FROM TIE SHEET 822

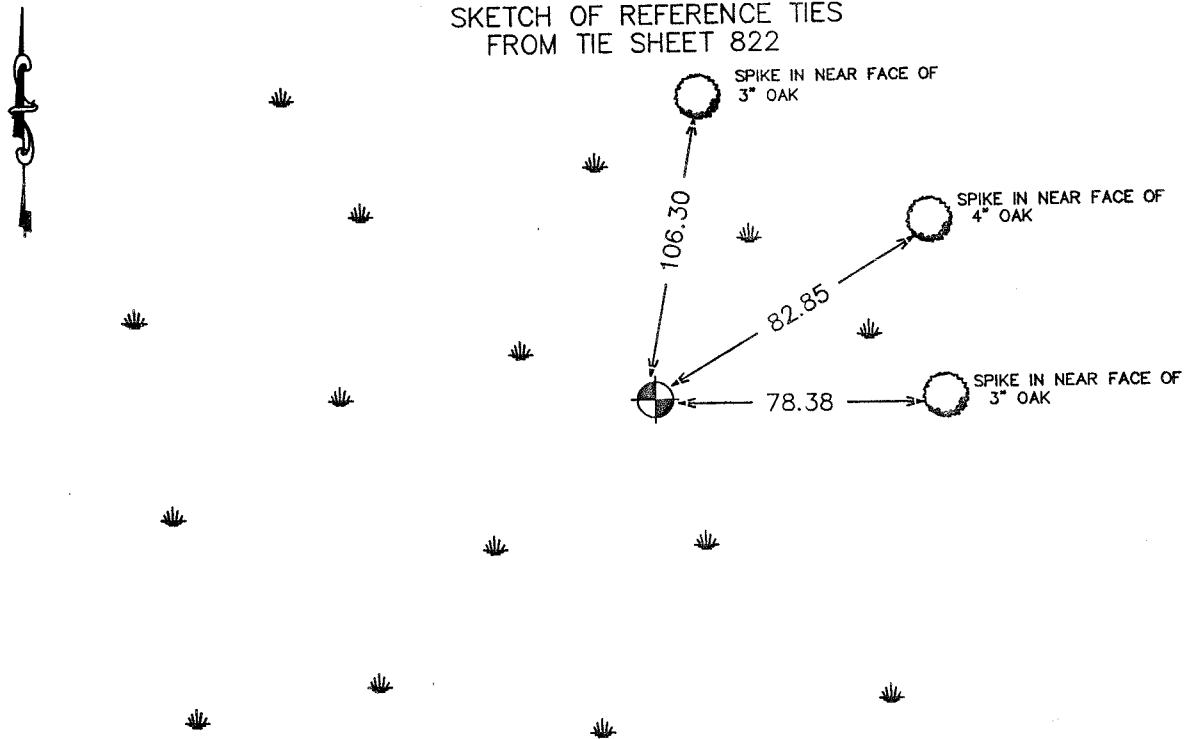

Statement of evidence relative to this corner location is on back of page.

I hereby certify that this document and the data contained herein was prepared by me or under my direct supervision.

Ernest Reed
Signature

7-17-2004
Date

Registration No. 9808

- Land Surveyor, Professional Engineer
 County Surveyor, County Engineer

OFFICE OF THE COUNTY RECORDER

County of _____

I hereby certify that this document was filed in the County Recorder's office at _____ M. on the

_____ day of _____ A.D., 20____

County Recorder _____

BY _____ Deputy

DOCUMENT NO. _____

STATEMENT OF EVIDENCE
(FROM TIE SHEET 822)

N 1/4 CORNER SEC. 26-39-25

All of the original bearing trees are now gone.

I set this corner by lost methods using the following corner information:
The northwest corner of Section 26, 5.2 feet west of the center line of
State Highway No. 47 per Department of Transportation's notes from 1941

Northeast corner of Section 25, centerline intersection of road north
extended south to centerline of road east

Southeast corner of Section 35, recorded corner on file

Northeast corner of Section 23, recorded corner on file

The computed location of Section 26 by double proportional measurement was
used.

There are no lines of occupation near the northeast and north quarter corners of
Section 26.

(2004)

In June 2004 we ran a survey around Sections 25 and 26 and found this
monument set by M.B. Rude. We established Kanabec County Coordinates on this
corner using GPS equipment.