

CERTIFICATE OF LOCATION OF GOVERNMENT CORNER

EAST QUARTER Corner of Section 2, Township 39, Range 25, 4TH P.M.

STATE OF MINNESOTA, County of KANABEC

At the corner location shown on the sketch:

7/8" X 36" CAPPED REBAR

Kanabec County U.S. Survey Feet Coordinates
 NAD 1983, HARN 1996 Adjustment
 Obtained by RTK GPS Observation

Northing= 156105.70

Easting= 369961.23

Note: NAD 1983, HARN 1996 Adjustment
 coordinates are NOT compatible with
 NAD 1983 coordinates

Note: 1 Meter=3937/1200 U.S. Survey Feet

SKETCH OF REFERENCE TIES

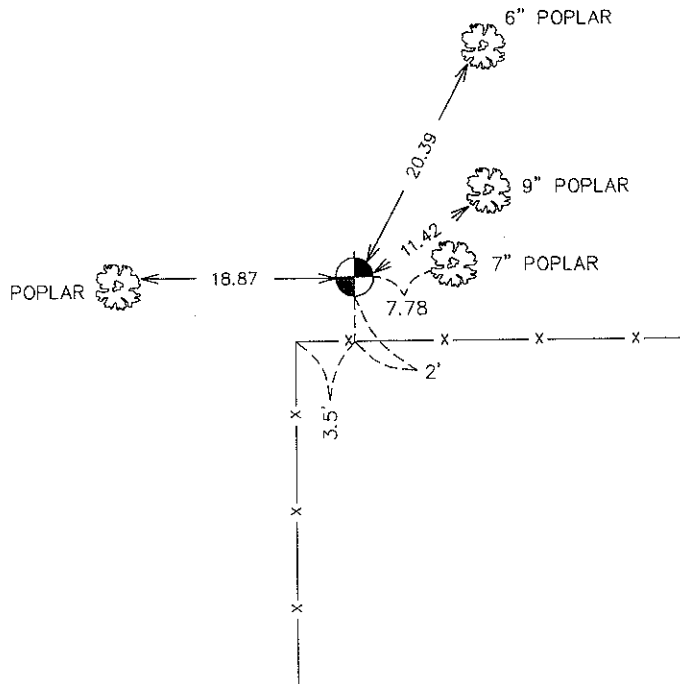

Statement of evidence relative to this corner location is on back of page.

I hereby certify that this document and the data contained herein was prepared by me or under my direct supervision.

Ernest [Signature]
 Signature

2-02-2010
 Date

Registration No. _____

- Land Surveyor, Professional Engineer
 County Surveyor, County Engineer

OFFICE OF THE COUNTY RECORDER

County of _____

I hereby certify that this document was filed in the County Recorder's office at _____ M. on the _____ day of _____ A.D., 20____

County Recorder _____

BY _____ Deputy

DOCUMENT NO. _____

E 1/4 CORNER, SEC 2, T39, R25

STATEMENT OF EVIDENCE

THE ORIGINAL GOVERNMENT POST WAS SET BY DEPUTY SURVEYOR SILAS BARNARD ON JUNE 24, 1855 AND 2 BEARING TREES NOTED: 6" BLACK ASH (S10°W A DISTANCE OF 5 LINKS) AND 8" BLACK ASH (N40°E A DISTANCE OF 12 LINKS). NO VISIBLE EVIDENCE FOR THIS CORNER OR BEARING TREES REMAIN.

IN 1901, FORMER COUNTY SURVEYOR, JOHN NELSON, MADE A ROAD SURVEY IN SEC. 2, BUT HIS RECORDS DO NOT SHOW WHAT WAS USED OR SET FOR THE E 1/4 CORNER.

IN 1949, CHARLES HANDSCHU SURVEYED A NUMBER OF LOTS AND ROADS IN THE NW 1/4 OF SEC. 2. HIS RECORDS DO NOT SHOW WHAT WAS FOUND OR SET AT THE E 1/4 CORNER.

IN MARCH OF 1985, M.B. RUDE RAN A SURVEY AROUND SEC. 2 TO LOCATE THE EXISTING MONUMENTS, LINES OF OCCUPATION AND TO SEARCH THE AREA.

THE IS A FENCE CORNER NEAR THIS CORNER AND IN JULY HE MADE A SEARCH OF THIS AREA, BUT NO EVIDENCE OF A CORNER MARKER.

M.B. RUDE RESET THIS CORNER BY EXTENSION OF MONUMENTS FOUND IN THE NW 1/4 AND THE SOUTH LINE OF SEC. 2 THAT WERE SET BY HANDSCHU AND HANDSCHU'S SECTION MAP WHICH SHOWS ALL THE DISTANCES AND ANGLES AROUND SEC. 2

IN 2009, E.G. RUD AND SONS ESTABLISHED KANABEC COUNTY COORDINATES ON THIS MONUMENT.