

CERTIFICATE OF LOCATION OF GOVERNMENT CORNER

W 1/4 Corner of Section 31, Township 39, Range 25, 4TH P.M.

STATE OF MINNESOTA, County of KANABEC

At the corner location shown on the sketch:

Set a 1/2" capped iron pipe.

Kanabec County U.S. Survey Feet Coordinates
 NAD 1983, HARN 1996 Adjustment
 Obtained by RTK GPS Observation

Northing= 136510.45

Easting= 342719.12

Note: NAD 1983, HARN 1996 Adjustment coordinates are NOT compatible with NAD 1983 coordinates

Note: 1 Meter=3937/1200 U.S. Survey Feet

SKETCH OF REFERENCE TIES

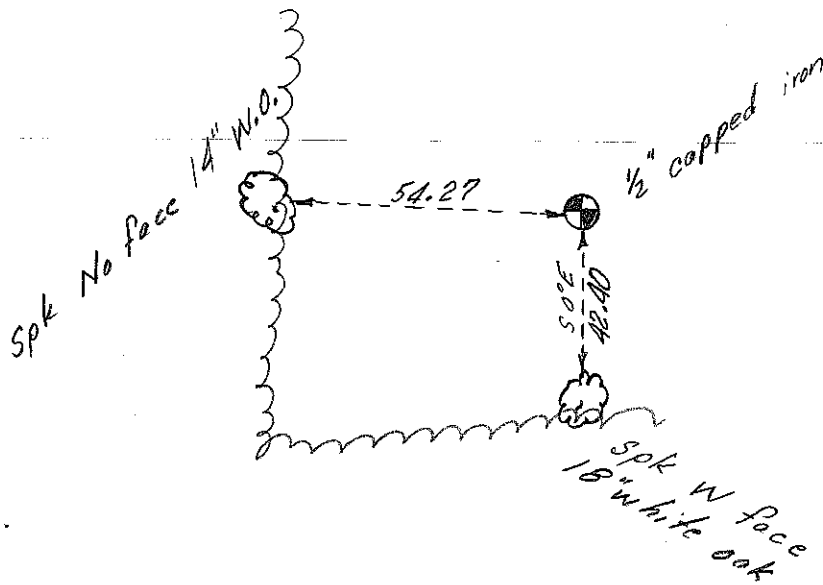

Statement of evidence relative to this corner location is on back of page.

I hereby certify that this document and the data contained herein was prepared by me or under my direct supervision.

Ernest J. Rud
 Signature

7-11-2012
 Date

Registration No. Minnesota No. 9808

Land Surveyor, Professional Engineer

County Surveyor, County Engineer

OFFICE OF THE COUNTY RECORDER

County of _____

I hereby certify that this document was filed in the County Recorder's office at _____ M. on the _____ day of _____ A.D., 20____

County Recorder _____

BY _____ Deputy

DOCUMENT NO. _____

The original government post was set on December 31, 1851 and 2 bearing trees noted as:

16" white oak bearing North 72 degrees west at 76 links

8" white birch bearing South 62 degrees East at 22 links

No evidence for the corner or accessories could be found.

A survey by John Nelson recorded on Pages 294 and 295 in Book A of Surveys indicate a corner post set with ties taken. Search was made for corner and accessories but no evidence could be found.

On July 11, 2012, E. G. Rud & Sons did a survey of the Southeast $\frac{1}{4}$ of Section 31 and set this corner by lost methods. No evidence of good occupation lines could be found at this corner location. A fence along the north line of the Southeast $\frac{1}{4}$ fell 0 – 6' +/- north of established line. A $\frac{1}{2}$ " iron pipe with a plastic cap marked R.L.S. 9808 was set, ties taken and Kanabec County coordinates established on this position.
