

CERTIFICATE OF LOCATION OF GOVERNMENT CORNER

NW Corner of Section 31, Township 39, Range 25, 4TH P.M.
STATE OF MINNESOTA, County of KANABEC

At the corner location shown on the sketch:

Found a stone with "X"

Kanabec County U.S. Survey Feet Coordinates
NAD 1983, HARN 1996 Adjustment
Obtained by RTK GPS Observation

Northing= 139171.84
Easting= 342706.45

Note: NAD 1983, HARN 1996 Adjustment
coordinates are NOT compatible with
NAD 1983 coordinates

Note: 1 Meter=3937/1200 U.S. Survey Feet

SKETCH OF REFERENCE TIES

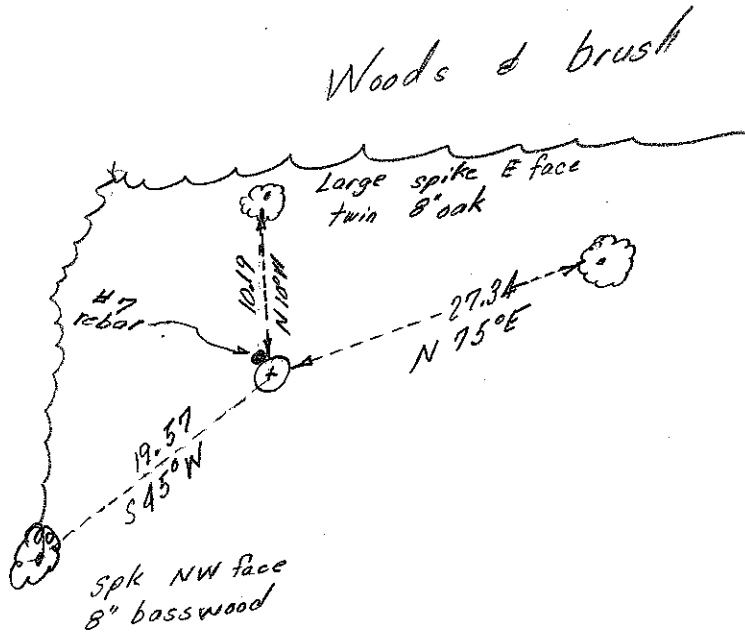

Statement of evidence relative to this corner location is on back of page.

I hereby certify that this document and the data contained herein was prepared by me or under my direct supervision.

Ernest L. Rud
Signature

7-11-2012
Date

Registration No. Minn No. 9808

- Land Surveyor, [] Professional Engineer
- [] County Surveyor, [] County Engineer

OFFICE OF THE COUNTY RECORDER

County of _____

I hereby certify that this document was filed in the County Recorder's office at _____ M. on the

_____ day of _____ A.D., 20__

County Recorder _____

BY _____ Deputy

DOCUMENT NO. _____

Original corner was set on December 31, 1851 and 4 bearing trees noted as:

24" pine bearing North 36.5 degrees West at 7 links
20" pine bearing South 39 degrees West at 16 links
30" pine bearing North 69 degrees East at 18 links
14" pine bearing South 34 degrees East at 58 links

No evidence to the corner or bearing trees could be found. A stone with a chiseled X was located by Mille Lacs County Surveyor's Office on May 19, 1916 by S. L. Kennedy and 4 ties to pine trees were recorded. No pine trees remain today.

A survey recorded on Page 294 and 295 in Book A of Surveys by John Nelson, dated April 7, 1901 noted this corner being set but doesn't state what was set.

On July 11, 2012, E. G. Rud & Sons did a survey for the Southeast $\frac{1}{4}$ of Section 31. Testimony from Steinbreckers (owners of the North $\frac{1}{2}$ of Section 31) indicated a stone with an X was found at this corner. This area had been logged off and new poplar growth had grown up. An approximate location was computed and a thorough search made within a 100 foot radius. A stone with and X was finally found in approximate area of logging limits. This fit the description given by Steinbreckers. It also agreed within 8 feet of distance measured by John Nelson to the Northeast corner of Section. An iron rod was set on the Northwest corner of stone, ties taken and Kanabec County coordinates established on this position.
