

# CERTIFICATE OF LOCATION OF GOVERNMENT CORNER

NORTHEAST Corner of Section 31, Township 41, Range 24, 4TH P.M.

STATE OF MINNESOTA, County of KANABEC

4" X 17" CAST IRON MONUMENT

Kanabec County U.S. Survey Feet Coordinates  
NAD 1983, HARN 1996 Adjustment  
Obtained by RTK GPS Observation

Northing= 197452.17

Easting= 369634.00

Note: NAD 1983, HARN 1996 Adjustment  
coordinates are NOT compatible with  
NAD 1983 coordinates

Note: 1 Meter=3937/1200 U.S. Survey Feet

### SKETCH OF REFERENCE TIES

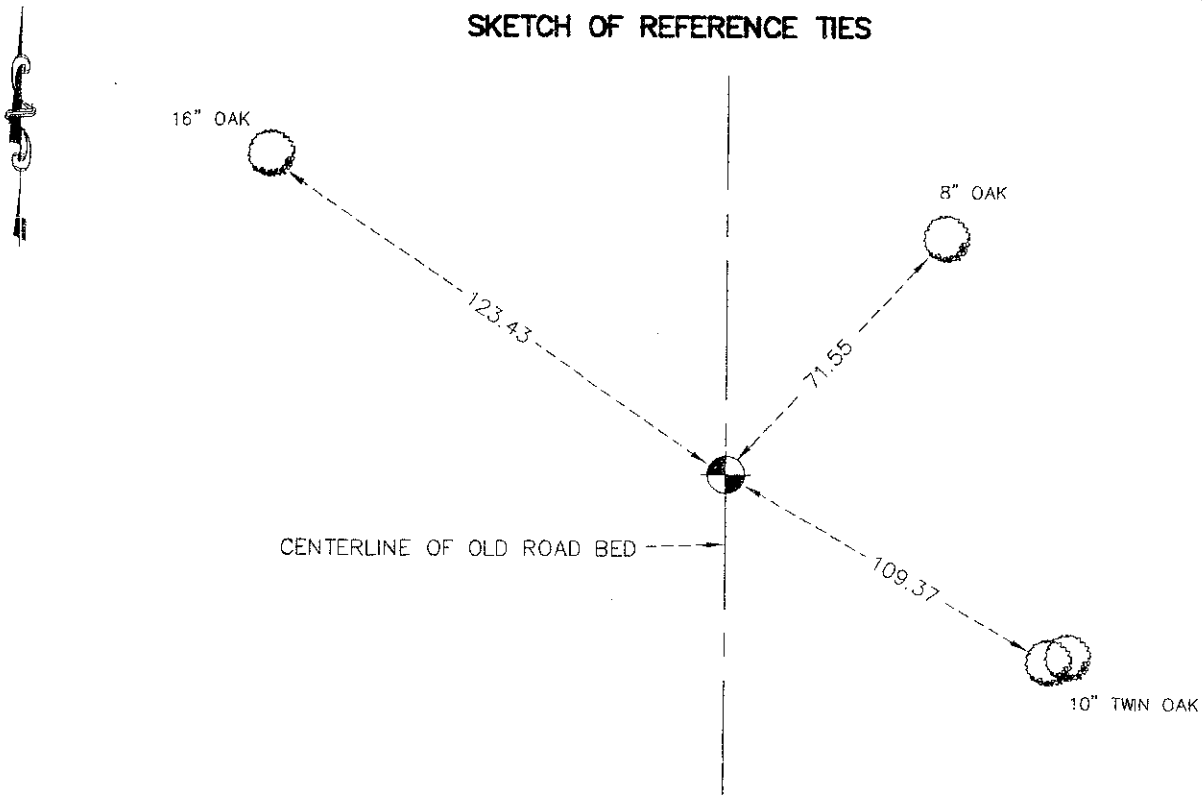

TIES ARE TO SPIKE IN BLAZE IN NEAR FACE OF TREES UNLESS OTHERWISE NOTED.

Statement of evidence relative to this corner location is on back of page.

I hereby certify that this document and the data contained herein was prepared by me or under my direct supervision.

*Ernest J. Lund*  
Signature

6-10-2009  
Date

Registration No. 9808

Land Surveyor,       Professional Engineer

County Surveyor,       County Engineer

### OFFICE OF THE COUNTY RECORDER

County of \_\_\_\_\_

I hereby certify that this document was filed in the County Recorder's office at \_\_\_\_\_ M. on the \_\_\_\_\_ day of \_\_\_\_\_ A.D., 20\_\_\_\_

County Recorder \_\_\_\_\_

BY \_\_\_\_\_ Deputy

DOCUMENT NO. \_\_\_\_\_

NE CORNER SECTION 31, TOWNSHIP 41, RANGE 24

**STATEMENT OF EVIDENCE**

ALL OF THE ORIGINAL BEARING TREES ARE NOW GONE.

THERE IS A TOWNSHIP ROAD ORDER ON FILE FOR A TOWNSHIP ROAD DATED 1910, WHICH CALLS FOR A TOWNSHIP ROAD STARTING AT THE NORTHEAST CORNER OF SECTION 30 AND RUNNING SOUTH ON THE SECTION LINE BETWEEN THE SECTIONS 29 AND 30 FOR ONE MILE.

IN JULY OF 1981, M.B. RUDE RAN A SURVEY AROUND SECTIONS 30 AND 31 AND LOCATED THE EXISTING LINES OF OCCUPATION AND MONUMENTATION.

THERE IS AN EXISTING ROAD BED STARTING AT THE NORTHEAST CORNER OF SECTION 30 AND RUNNING SOUTH FOR ONE MILE.

HE SET THIS CORNER AT A PROPORTIONAL DISTANCE BETWEEN THE SOUTHEAST CORNER OF SECTION 31 AND THE NORTHEAST CORNER OF SECTION 30 AND IN THE CENTER OF THE OLD ROAD BED NORTH.

THIS LOCATION WAS ACCEPTED AS THE BEST AVAILABLE EVIDENCE OF THE ORIGINAL CORNER AND IS IN HARMONY WITH THE TOWNSHIP ROAD ORDER DATED 1910.

IN MARCH OF 2009, E.G. RUD AND SONS ESTABLISHED KANABEC COUNTY COORDINATES ON THIS MONUMENT USING G.P.S. EQUIPMENT.