

# CERTIFICATE OF LOCATION OF GOVERNMENT CORNER

North Quarter Corner of Section 34, Township 41, North, Range 24 West,  
4th Principal Meridian, Kanabec County, State of Minnesota

At the corner location shown on the sketch:  
On 3/02/2021 found a 7/8" Iron Rebar monument with aluminum cap. Left said monument as found.

Kanabec County U.S. Survey Feet Coordinates  
NAD 1983, HARN 1996 Adjustment  
Obtained by RTK GPS observation  
Northing: 197306.1555  
Easting: 383033.6613

Note: NAD 1983, HARN 1996 Adjustment coordinates are NOT compatible with NAD 1983 coordinates

Note: 1 Meter = 3937/1200 U.S. Survey Feet

## SKETCH OF REFERENCE TIES

NOT TO SCALE

DISTANCE UNITS FOR THIS DRAWING IS  
U.S. SURVEY FEET

THE BASIS OF BEARINGS FOR THIS  
DRAWING IS THE KANABEC COUNTY  
COORDINATE SYSTEM BY MNDOT,  
NAD 1983, HARN 1996 ADJUSTMENT



### SECTION 27

NW CORNER OF SECTION  
34, T.41, R.24  
FOUND 3/4" REBAR  
MARKED LS 19839

N 1/4 CORNER OF  
SECTION 34, T.41, R.24  
FOUND 7/8" IRON REBAR  
WITH ALUM CAP

NE CORNER OF SECTION  
34, T.41, R.24  
FOUND 7/8" REBAR

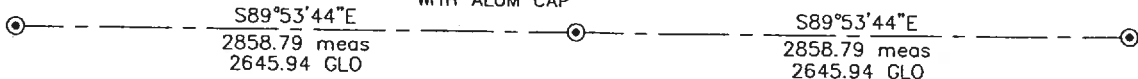

### SECTION 34



**Kroschel Land Surveyors, Inc.**

1639 Main Street North, Suite 6, Pine City, MN 55063  
Phone: 320-629-3267 Fax: 320-629-0176

Statement of evidence relative to this corner location is on back of page.

I hereby certify that this report was prepared by me or under my direct supervision, that the United States public land survey monument record is correct and complete to the best of my knowledge and belief, and that I am a duly Licensed Land Surveyor under the laws of the State of Minnesota.

Tyler J. Kroschel, County Surveyor

2-28-2022  
Date

License No. 44490

## OFFICE OF THE COUNTY RECORDER

County of Kanabec

I hereby certify that this document was filed in the County Recorder's office at \_\_\_\_\_ .M. on the \_\_\_\_\_ day of \_\_\_\_\_ A.D., 20\_\_\_\_  
County Recorder \_\_\_\_\_

\_\_\_\_\_, Deputy  
DOCUMENT NO. \_\_\_\_\_

Statement of Evidence:

In January of 1856, Deputy Surveyor Isaac Banker set a post to mark the North Quarter Corner of Section 34, Township 41 North, Range 24 West, 4th Principal Meridian.

Reference ties were taken to:

- 12 inch Black Oak at South 51 degrees 15 minutes West a distance of 17 links
- 7 inch White Oak at North 2 degrees 45 minutes West a distance of 37 links

All of the original Government corner evidence was searched for. None was found. The GLO running notes indicate the north line of Section 34 is 80.18 chains or 5291.88 feet. I measure 5717.59 feet between the NE and NW corners of Section 34, a difference of 425.71 feet. The topography call distances to the banks of the Knife River do not match any of the adjacent survey monuments or occupation lines, which leads me to believe the GLO surveyor did not measure the topography distances with any accuracy.

1897- A Supervisors Road Order is filed in the Office of the County Auditor opening a Town Road along the north-south quarter line of Section 34. The road ends at the center of Section 34. A survey of the road was completed by T. B. Vickery.

1910- A Supervisors Road Order is filed in the Office of the County Auditor opening a Town Road along the north line of Sections 33 and 34. No survey of the road was completed. There is very clearly an old road bed running along the north line of Sections 33 and 34.

2018- Surveyor Ernie Rud, LS 9808 made surveys in Sections 27 and 34. He placed a 7/8" Rebar with Aluminum cap at a lost position between the NE and NW corners of Section 34. No corner certificate was filed.

In March 2021, I made a survey around Section 34, Township 41 North, Range 24 West, 4th Principal Meridian for Todd Hinrichs to locate existing monuments, lines of occupation and establish search areas.

On 3/02/2021 a search was made with a magnetic locator for the corner. I found a 7/8" Rebar monument with Aluminum Cap. The found Rebar monument fit a lost position between the NE and NW corners of Section 34 very well.

It is very clear from the aerial photos that the lines of occupation in this area do not line up. The lines in Sections 32, 33, and 34 seem to point about 200 feet east of the lines in Sections 27, 28, and 29. I considered many different locations for this corner, using measurements from the adjacent section corners, GLO Topography distances, and nearby occupation lines. It is my opinion that the lines of occupation in this area were not placed with the benefit of a survey or any original monumentation. I agreed with Ernie Rud's assessment that the corner should be placed at a lost position. The found Rebar monument was determined to be the best available evidence of the corner location. I left said Rebar monument as found and assigned Kanabec County Coordinates.



**Kroschel Land Surveyors, Inc.**

1639 Main Street North, Suite 6, Pine City, MN 55063  
Phone: 320-629-3267 Fax: 320-629-0176