

4124013

Index No. ~~427077~~

# CERTIFICATE OF LOCATION OF GOVERNMENT CORNER

NW  
~~SW~~ Corner of Section 2, Township 41, Range 24, 4TH P.M.

STATE OF MINNESOTA, County of KANABEC

At the corner location shown on the sketch:  
ON 5/13/2010 FOUND A 2" X 36" CAPPED PIPE WITH  
A 6" SQUARE HEAD ATTACHED

T42	T42
R24	R23
T41	T41
R24	R23

*Township & Range  
Numbers are welded  
beads on Steel Plate*

Kanabec County U.S. Survey Feet Coordinates  
NAD 1983, HARN 1996 Adjustment  
Obtained by RTK GPS Observation

Northing= 225024.09

Easting= 396867.81

Note: NAD 1983, HARN 1996 Adjustment  
coordinates are NOT compatible with  
NAD 1983 coordinates

Note: 1 Meter=3937/1200 U.S. Survey Feet

## SKETCH OF REFERENCE TIES

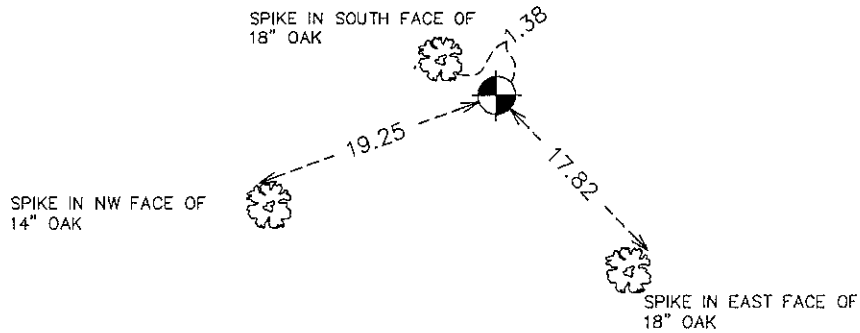

Statement of evidence relative to this corner location is on back of page.

I hereby certify that this document and the data contained herein was prepared by me or under my direct supervision.

Ernest Lund  
Signature

11-27-10  
Date

Registration No. 9808

Land Surveyor,  Professional Engineer

County Surveyor,  County Engineer

## OFFICE OF THE COUNTY RECORDER

County of \_\_\_\_\_

I hereby certify that this document was filed in the County Recorder's office at \_\_\_\_\_ M. on the

\_\_\_\_\_ day of \_\_\_\_\_ A.D., 20\_\_\_\_

County Recorder \_\_\_\_\_

BY \_\_\_\_\_ Deputy

DOCUMENT NO. \_\_\_\_\_

SW CORNER, SEC. 31, T42, R23

**STATEMENT OF EVIDENCE**

**ALL OF THE ORIGINAL BEARING TREES ARE NOW GONE.**

**THERE IS NO RESURVEY DATA ON FILE FOR THIS CORNER.**

**THERE ARE NO DEFINITE LINES OF OCCUPATION IN THIS AREA.**

**ON FEB. 2, 1983, M.B. RUDE SET THIS CORNER BY DOUBLE PROPORTIONAL MEASUREMENT BETWEEN THE E1/4 CORNER OF SEC. 12, T41, R24 AND THE E1/4 CORNER OF SEC. 24, T42, R24 AND THE N1/4 CORNER OF SEC. 2, T41, R24 AND THE SE CORNER OF SEC. 31, T42, R23.**

**ON MAY 13, 2010, E.G. RUD AND SONS, INC. FOUND THIS MONUMENT, TOOK NEW TIES AND ESTABLISHED KANABEC COUNTY COORDINATES ON THIS POSITION.**