

CERTIFICATE OF LOCATION OF GOVERNMENT CORNER

NORTHEAST Corner of Section 12, Township 41, Range 24, 4TH P.M.
 STATE OF MINNESOTA, County of KANABEC

At the corner location shown on the sketch:
 ON 12/8/2011 FOUND A CAST IRON MONUMENT.

Kanabec County U.S. Survey Feet Coordinates
 NAD 1983, HARN 1996 Adjustment
 Obtained by RTK GPS Observation

Northing= 218451.94
 Easting= 396761.99

Note: NAD 1983, HARN 1996 Adjustment
 coordinates are NOT compatible with
 NAD 1983 coordinates
 Note: 1 Meter=3937/1200 U.S. Survey Feet

SKETCH OF REFERENCE TIES (FROM TIE SHEET 674)

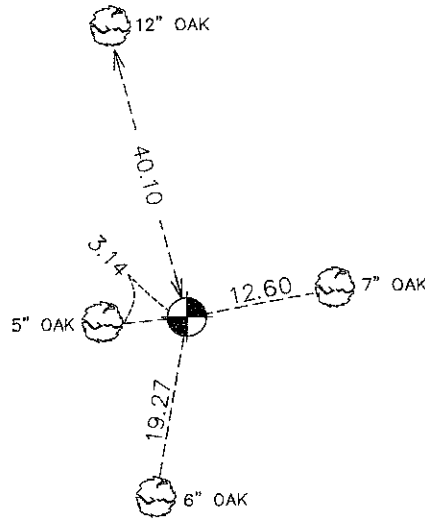

TIES ARE TO SPIKE IN
 BLAZE IN NEAR FACE

Statement of evidence relative to this corner location is on back of page.

I hereby certify that this document and the data contained herein was prepared by me or under my direct supervision.

Ernest J. Rud 7-18-12
Signature Date

Registration No. 9808

Land Surveyor, Professional Engineer

County Surveyor, County Engineer

OFFICE OF THE COUNTY RECORDER

County of _____

I hereby certify that this document was filed in the County Recorder's office at _____ M. on the

_____ day of _____ A.D., 20__

County Recorder _____

BY _____ Deputy

DOCUMENT NO. _____

STATEMENT OF EVIDENCE: NORTHEAST CORNER 12-41-24 4124011

All of the original bearing trees are now gone.

There is no resurvey data on file for this corner.

On February 2, 1983, M.B. Rude set this corner by single proportional measurement between the east quarter corner of Section 12 and the northeast corner of Section 1.

There is an existing fence corner 100 feet, plus or minus, east and 10 feet, plus or minus, north of this corner.

On December 8, 2011, E.G. Rud & Sons located this monument and established Kanabec County coordinates on this position.