

CERTIFICATE OF LOCATION OF GOVERNMENT CORNER

E. 1/4 Corner of Section 12, Township 41, Range 24, 4TH P.M.

STATE OF MINNESOTA, County of KANABEC

At the corner location shown on the sketch

On _____ found a _____
Date

left monument as found, lowered monument, removed monument (explain)

On 1-27-83 placed a 1" FROST PIN
Date

SKETCH OF REFERENCE TIES

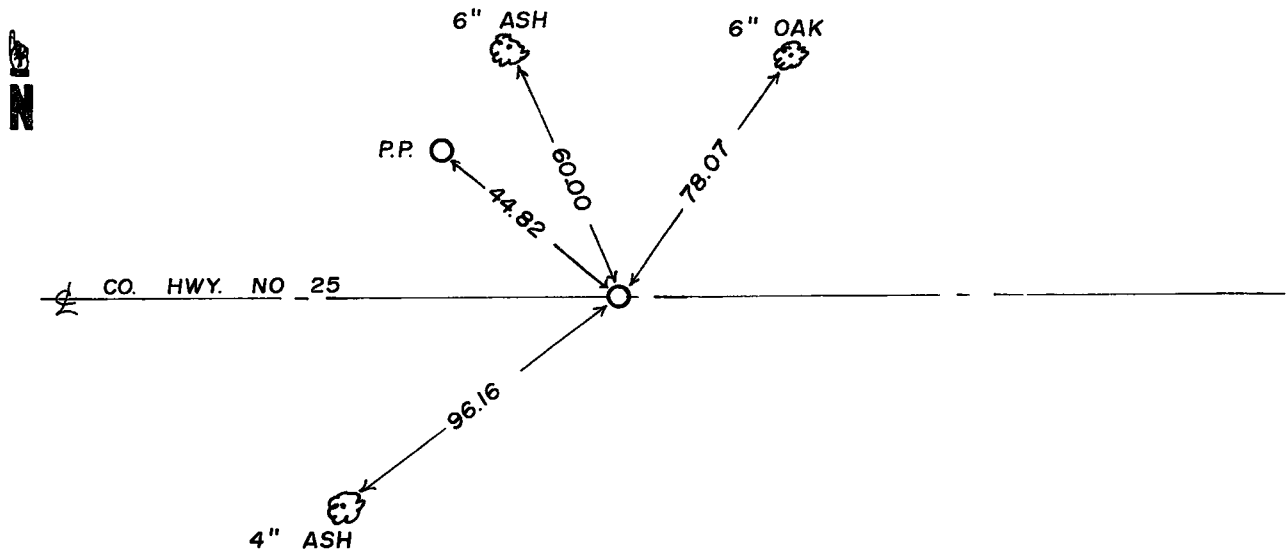

TIES ARE TO SPK. IN
BLAZE IN NEAR FACE

Statement of evidence relative to this corner location is on back of page.

I hereby certify that this document and the data contained herein was prepared by me or under my direct supervision.

M. D. [Signature] 2-2-83
Signature Date

Registration No. 8195

Land Surveyor, Professional Engineer

County Surveyor, County Engineer

County Recorder
OFFICE OF THE REGISTER OF DEEDS

County of Kanabec

I hereby certify that this document was filed in the Register of Deeds office at 2 P. M. on the

11 day of February A.D. 1983

County Recorder Velma J. Basser
Register of Deeds

By _____, Deputy

DOCUMENT NO. _____

39/163

STATEMENT OF EVIDENCE

All of the original bearing trees are now gone.

There is no resurvey data on file for this corner.

There is a road order dated in 1894, for a township road along the east-west quarter line of Section 12 that was surveyed by Nels Sjodin, Jr.

There is an old existing fence line running north from the quarter corner location.

We accepted the center line of the existing east-west road and old fence line north extended south as the best available evidence of the original corner location.

This location is in harmony with the 1894 road order and the existing lines of occupation.