

CERTIFICATE OF LOCATION OF GOVERNMENT CORNER

~~NORTHWEST~~
NORTHEAST Corner of Section 13, Township 41, Range 24, 4TH P.M.

STATE OF MINNESOTA, County of KANABEC

At the corner location shown on the sketch:
SET A #7 REBAR WITH ALUMINUM CAP IN HAY FIELD.

Kanabec County U.S. Survey Feet Coordinates
NAD 1983, HARN 1996 Adjustment
Obtained by RTK GPS Observation

Northing= 213163.10
Easting= 396714.13

Note: NAD 1983, HARN 1996 Adjustment
coordinates are NOT compatible with
NAD 1983 coordinates

Note: 1 Meter=3937/1200 U.S. Survey Feet

SKETCH OF REFERENCE TIES

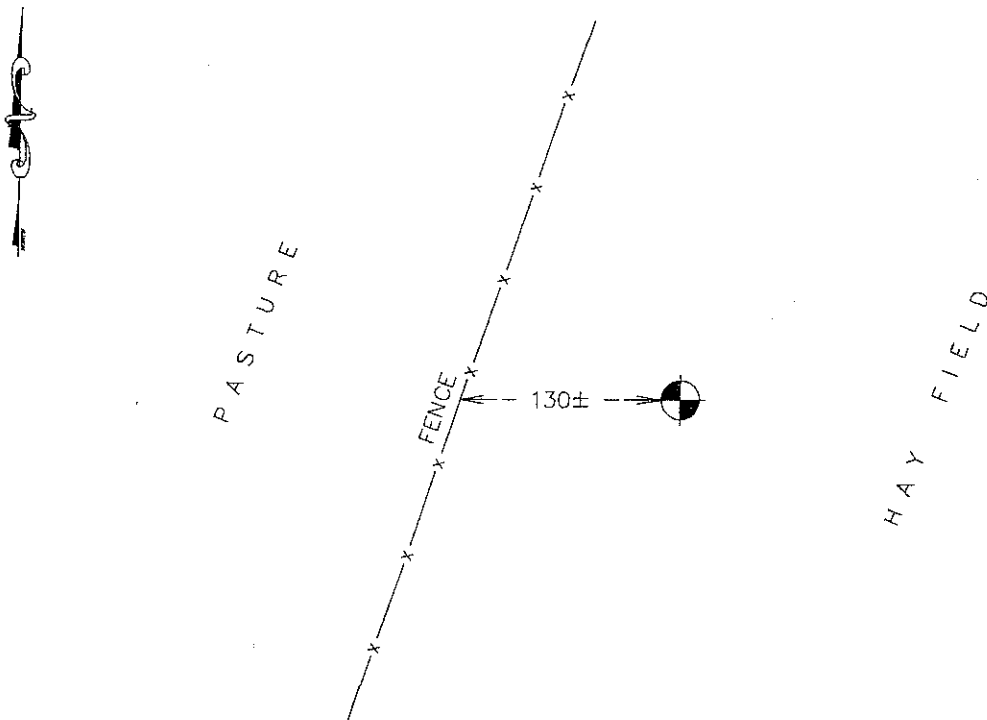

Statement of evidence relative to this corner location is on back of page.

I hereby certify that this document and the data
contained herein was prepared by me or under
my direct supervision.

Ernest L. Rud
Signature Date 12-22-11

Registration No. 9808

Land Surveyor, [] Professional Engineer

[] County Surveyor, [] County Engineer

OFFICE OF THE COUNTY RECORDER

County of _____

I hereby certify that this document was filed in
the County Recorder's office at _____ M. on the

_____ day of _____ A.D., 20__

County Recorder _____

BY _____ Deputy

DOCUMENT NO. _____

NW CORNER, SEC. 18, T41, R23

NE CORNER, SEC. 13, T41, R24

STATEMENT OF EVIDENCE

THE ORIGINAL CORNER WAS ON OCTOBER 14, 1849 BY U.S. DEPUTY SURVEYOR AND 4 BEARING TREES NOTED AS:

8" TAMARACK @ 23 LINKS BEARING S48°W

12" ASPEN @ 31 LINKS BEARING N70°W

9" TAMARACK @ 5 LINKS BEARING N20°E

8" BIRCH @ 11 LINKS BEARING S45°E

NO VISIBLE EVIDENCE COULD BE FOUND FOR THE ORIGINAL CORNER OR BEARING TREES.

IN BOOK A OF SURVEYS, PAGES 92-93, A SURVEY BY NELS SJODIN JR. IS RECORDED FOR THE COUNTY COMMISSIONER ALONG THE EAST LINE OF SECS. 12, 13, 24 AND 25. THERE WAS NO MENTION OF A GOVERNMENT POST AT THIS LOCATION OR A CORNER BEING SET. THERE ARE NO VISIBLE SIGNS OF A ROAD BEING BUILT ALONG THIS TOWNSHIP LINE.

THEREFORE, WE SET A #7 REBAR WITH AN ALUMINUM CAP USING LOST METHODS BETWEEN THE E1/4 CORNER OF SEC. 12 AND THE NE CORNER OF SEC. 24. NO TIES WERE AVAILABLE.