

CERTIFICATE OF LOCATION OF GOVERNMENT CORNER

East Quarter Corner of Section 7, Township 42 North, Range 24 West,
4th Principal Meridian, Kanabec County, State of Minnesota

At the corner location shown on the sketch:
On 5/10/2019 found a 3/4" x 20" Iron Pipe monument.

Kanabec County U.S. Survey Feet Coordinates
NAD 1983, HARN 1996 Adjustment
Obtained by RTK GPS observation
Northing: 248070.0234
Easting: 370960.6462

Note: NAD 1983, HARN 1996 Adjustment
coordinates are NOT compatible with
NAD 1983 coordinates
Note: 1 Meter = 3937/1200 U.S. Survey Feet

SKETCH OF REFERENCE TIES

NOT TO SCALE

DISTANCE UNITS FOR THIS DRAWING IS
U.S. SURVEY FEET

THE BASIS OF BEARINGS FOR THIS
DRAWING IS THE KANABEC COUNTY
COORDINATE SYSTEM BY MNDOT,
NAD 1983, HARN 1996 ADJUSTMENT



SECTION 7.

SECTION 8

FOUND 3/4" x 20"
IRON PIPE

⊗ = DENOTES 3/4" REBAR SET

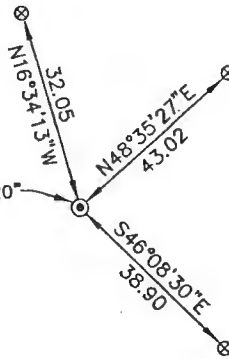

Kroschel Land Surveyors, Inc.

1639 Main Street North, Suite 6, Pine City, MN 55063
Phone: 320-629-3267 Fax: 320-629-0176

Statement of evidence relative to this corner location is on back of page.

I hereby certify that this report was prepared by me or under my direct supervision, that the United States public land survey monument record is correct and complete to the best of my knowledge and belief, and that I am a duly Licensed Land Surveyor under the laws of the State of Minnesota.

Tyler J. Kroschel, County Surveyor

3-5-2021
Date

License No. 44490

OFFICE OF THE COUNTY RECORDER

County of Kanabec

I hereby certify that this document was filed in the County Recorder's office at _____ .M. on the _____ day of _____ A.D., 20____

County Recorder _____, Deputy

DOCUMENT NO. _____

Statement of Evidence:

In December of 1855, Deputy Surveyor Isaac Banker set a post to mark the East Quarter Corner of Section 7, Township 42 North, Range 24 West, 4th Principal Meridian.

Reference ties were taken to:

10 inch Tamarack at North 5 degrees East a distance of 9 links

12 inch Tamarack at South 63 degrees West a distance of 15 links

All of the original Government corner evidence was searched for. None was found.

1933—Chas Handschu, LS 464 made a survey in Sections 7 and 8, filed in Book A1 of Surveys, P.147 at the County Highway Department. Handschu set an Iron Monument at the East Quarter corner of Section 7. It appears that he computed a lost position for the East Quarter corner of Section 7 by prorating between the Northeast corner and Southeast corners of Section 7. He set an iron monument and post along with two ties.

1982—Curtis Stoeckel, LS 13077 made a survey in Section 8 for H&G Properties, Inc. Stoeckel computed the location of the West Quarter corner of Section 8 using found Iron Monuments and dimensions from the 1933 survey. No monument was found or set at the West Quarter corner of Section 8.

In May 2019, I made a survey around Section 8, Township 42 North, Range 24 West, 4th Principal Meridian for Tom Howard to locate existing monuments, lines of occupation and establish search areas.

On 5/10/2019 I made a search with a magnetic locator. I found a 3/4" x 20" Iron Pipe monument. The found Iron Pipe fit Handschu's dimensions very well. I searched for Handschu's ties, but none were found. I accepted the found Iron Pipe as the best available evidence of the original corner monument location. Established reference ties and assigned Kanabec County Coordinates.



Kroschel Land Surveyors, Inc.

1639 Main Street North, Suite 6, Pine City, MN 55063
Phone: 320-629-3267 Fax: 320-629-0176